

Steven Kent Winery

Aboard AmaKristina • 7 Nights • March 25 to April 1, 2027

Note: Stateroom layouts shown below are not to scale.

**Book by June 30, 2026
for this Special Pricing!
OR Choose FREE Land Program!**

Suite *Violin Deck*
French Balcony & Outside Balcony, 350 sq. ft.

Brochure Rate = ~~\$9,178~~ pp
Wine Cruise Rate = \$7,928 pp

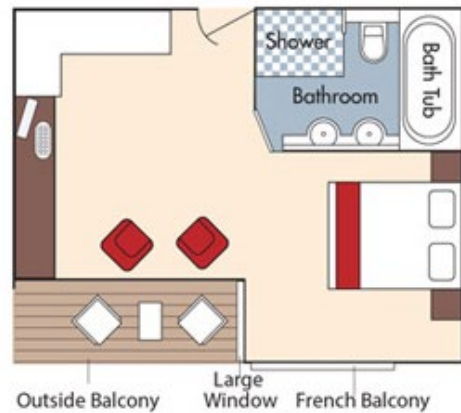

Category AA *Violin Deck*
French Balcony & Outside Balcony, 235 sq. ft.

Brochure Rate = ~~\$7,778~~ pp
Wine Cruise Rate = \$6,528 pp

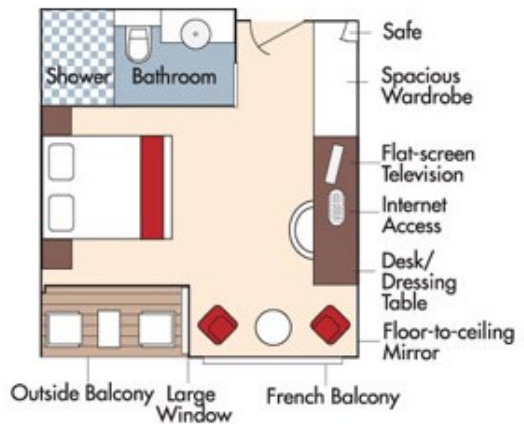



Category AB *Cello Deck*

French Balcony & Outside Balcony, 235 sq. ft.

Brochure Rate = ~~\$7,578~~ pp

Wine Cruise Rate = \$6,328 pp

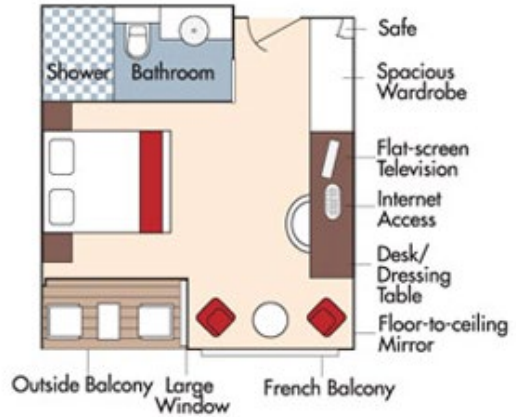

Category BA *Violin Deck*

French Balcony & Outside Balcony, 210 sq. ft.

Brochure Rate = ~~\$7,378~~ pp

Wine Cruise Rate = \$6,128 pp

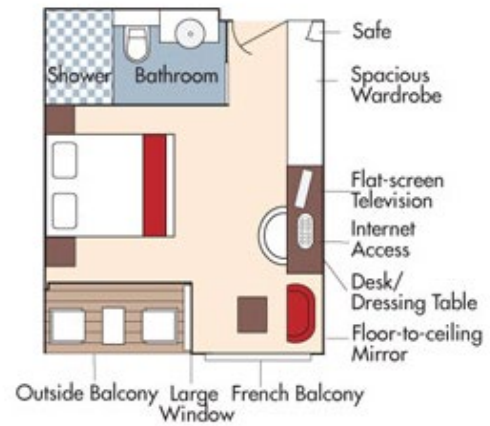

Category BB *Cello Deck*

French Balcony & Outside Balcony, 210 sq. ft.



Brochure Rate = ~~\$7,178 pp~~
Wine Cruise Rate \$5,928 pp

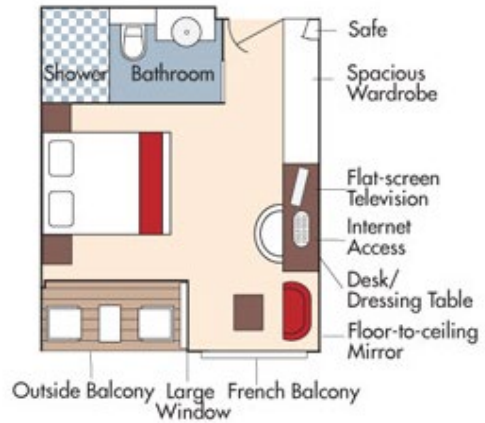

Category CA *Violin & Cello Deck*

French Balcony, 170 sq. ft.



Brochure Rate = ~~\$6,578 pp~~
Wine Cruise Rate = \$5,328 pp

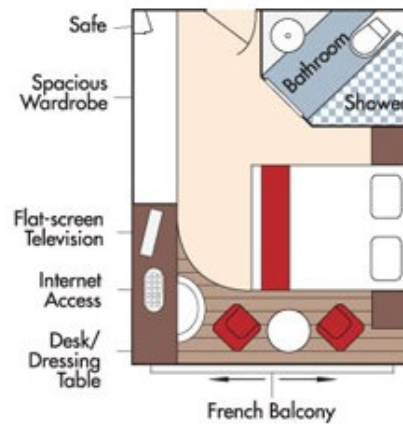

Category CB *Violin Deck*

French Balcony, 155 sq. ft.



Brochure Rate = ~~\$6,178 pp~~
Wine Cruise Rate = \$4,928 pp

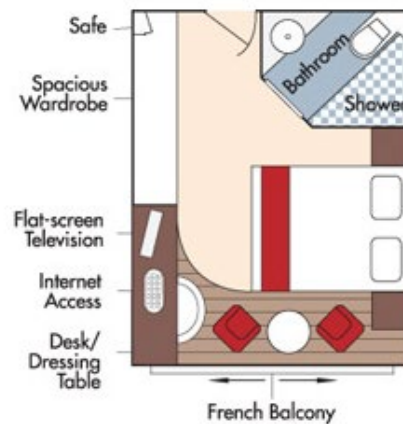

Category D *Piano Deck*
Fixed Windows, 160 sq. ft.

Brochure Rate = \$5,029 pp
Wine Cruise Rate = \$3,779 pp

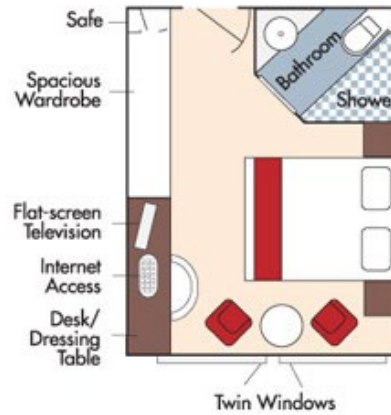

Category E *Piano Deck*
Fixed Windows, 160 sq. ft.

Brochure Rate = \$4,979 pp
Wine Cruise Rate = \$3,729 pp

AmaKristina DECK PLAN

- 1 Lower Sun Deck
- 2 Navigation Bridge
- 3 Bicycles
- 4 Heated Pool
- 5 Sun Deck
- 6 Walking Track
- 7 Al Fresco Terrace
- 8 Observation Lounge
- 9 Main Lounge & Bar
- 10 Gift Shop
- 11 Reception
- 12 The Chef's Table Restaurant
- 13 Main Restaurant
- 14 Elevator
- 15 Massage & Hair Salon
- 16 Fitness Room
- 17 Crew Cabins

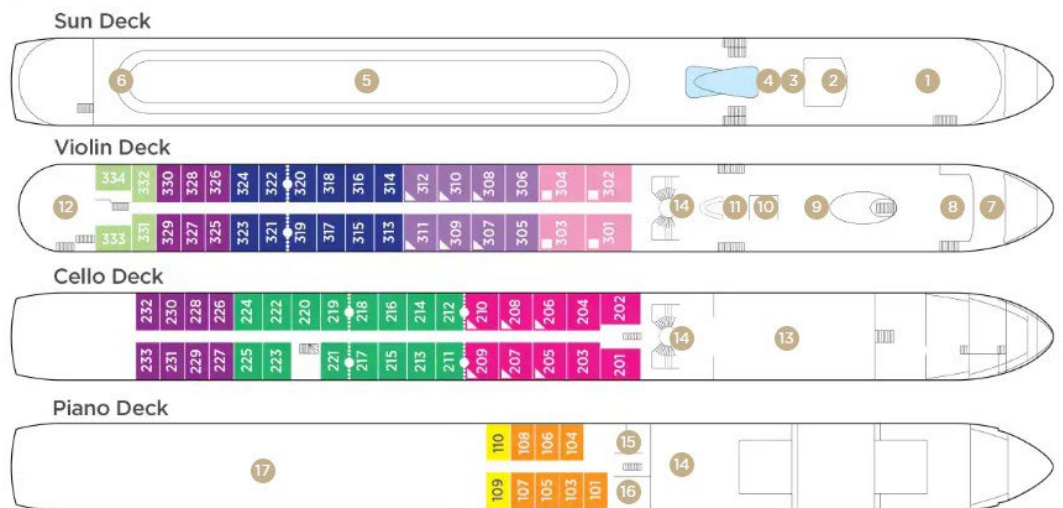

Note: Elevator reaches the Violin, Cello and Piano Deck (does not reach the Sun Deck).

Staterooms can become adjoining by request.

Up to triple occupancy

Up to quadruple occupancy



Fares listed are cruise-only, per person based on double occupancy and INCLUDE port charges of \$280 per person.