

# EXPLORE THE ENTICING DOURO WITH THE PETALUMA GAP WINEGROWERS ALLIANCE

Aboard AmaSintra • 7 Nights • May 14 to 21, 2027

**Book by June 30, 2026  
and SAVE up to \$500 per person!**

Note: Stateroom layouts shown below are not to scale.

## Suite *Porto Deck* Balcony, 323 sq. ft.

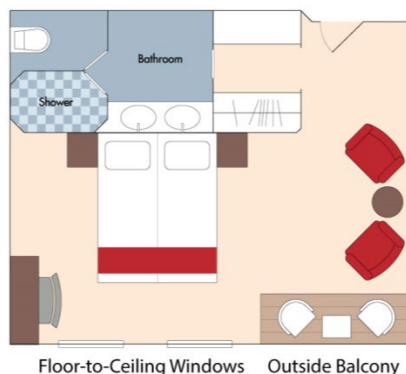

Brochure Fare: ~~\$10,077~~ pp  
Your Rate: \$9,577 pp

## Category A *Porto Deck* Balcony, 215 sq. ft.

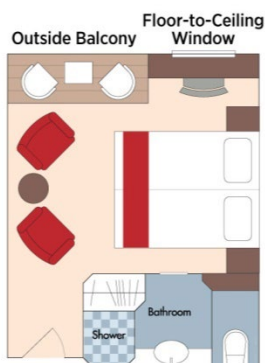

Brochure Fare: ~~\$8,577~~ pp  
Your Rate: \$8,077 pp

## Category B *Lisbon Deck* Balcony, 215 sq. ft.

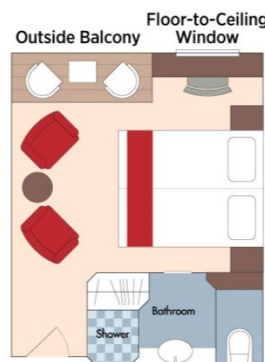

Brochure Fare: ~~\$8,277~~ pp  
Your Rate: \$7,777 pp

**Category C *Porto Deck*** French Balcony, 161 sq. ft.

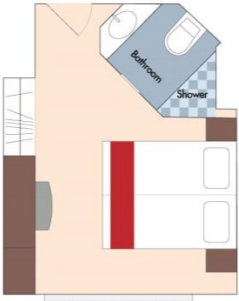

French Balcony

Brochure Fare: \$7,477 pp  
Your Rate: \$6,977 pp

**Category D *Douro Deck*** Panoramic Window, 161 sq. ft.

**Category E *Douro Deck*** Panoramic Window, 161 sq. ft.



Category D  
Brochure Fare: \$6,277 pp  
Your Rate: \$5,777 pp

Category E  
Brochure Fare: \$5,878 pp  
Your Rate: \$5,378 pp

## DECK PLAN

1	Main Lounge
2	Reception
3	Elevator
4	Main Restaurant
5	Fitness Room
6	Spa

### Sun Deck



### Porto Deck

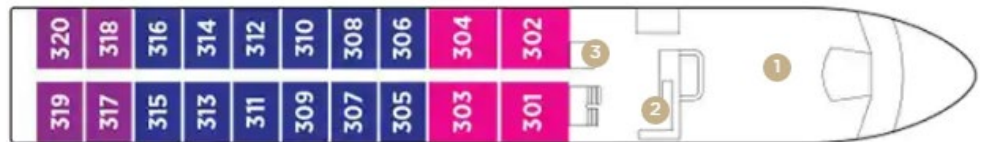

### Lisbon Deck



### Douro Deck



Stateroom Categories

