

# EXPLORE THE ENTICING DOURO WITH PEDRONCELLI WINERY

Aboard AmaDouro • 7 Nights • May 25 to June 1, 2027

**Book by June 30, 2026  
and SAVE \$250 per person!**

Note: Stateroom layouts shown below are not to scale.



## Suite Porto Deck Balcony, 323 sq. ft.

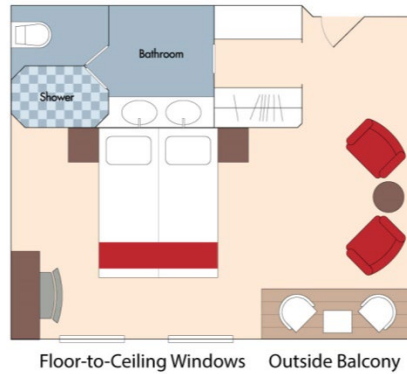

Brochure Fare: ~~\$9,877~~ pp  
Your Rate: \$9,627 pp



## Category A Porto Deck Balcony, 215 sq. ft.

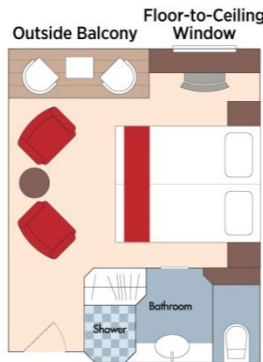

Brochure Fare: ~~\$8,377~~ pp  
Your Rate: \$8,127 pp



## Category B Lisbon Deck Balcony, 215 sq. ft.

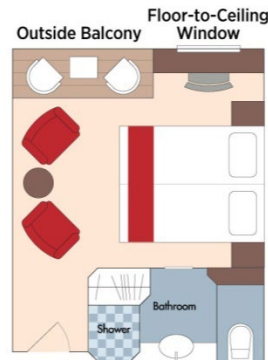

Brochure Fare: ~~\$8,077~~ pp  
Your Rate: \$7,827 pp

Fares listed are cruise-only, per person based on double occupancy AND INCLUDE port charges of \$280 per person.

**Category C *Porto Deck*** French Balcony, 161 sq. ft.

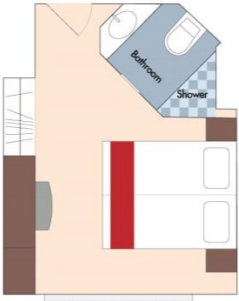

French Balcony

Brochure Fare: \$7,277 pp  
Your Rate: \$7,027 pp

**Category D *Douro Deck*** Panoramic Window, 161 sq. ft.

**Category E *Douro Deck*** Panoramic Window, 161 sq. ft.



Category D  
Brochure Fare: \$6,077 pp  
Your Rate: \$5,827 pp

Category E  
Brochure Fare: \$5,678 pp  
Your Rate: \$5,428 pp

## DECK PLAN

1	Main Lounge
2	Reception
3	Elevator
4	Main Restaurant
5	Fitness Room
6	Spa

### Sun Deck



### Porto Deck

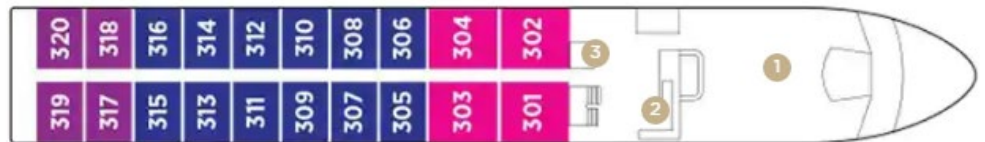

### Lisbon Deck



### Douro Deck



Stateroom Categories



Fares listed are cruise-only, per person based on double occupancy AND INCLUDE port charges of \$280 per person.