

## Montemar Winery

AmaPrima • 7 Nights • June 30 to July 7, 2027

Nuremberg to Luxembourg

**Book by May 31, 2026  
for this Special Pricing!**

*Note: Stateroom layouts shown below are not to scale.*

**Suite, Violin Deck**  
French Balcony & Outside Balcony, 300 sq. ft.

Brochure Rate = ~~\$9,178~~ pp  
Wine Cruise Rate = \$8,178 pp

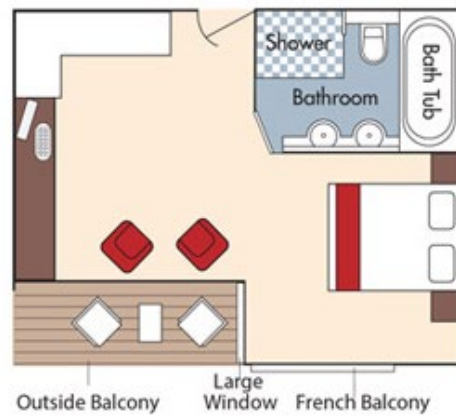

**Category AA+ Violin Deck**  
French Balcony & Outside Balcony, 290 sq. ft.

Brochure Rate = ~~\$8,378~~ pp  
Wine Cruise Rate = \$7,378 pp

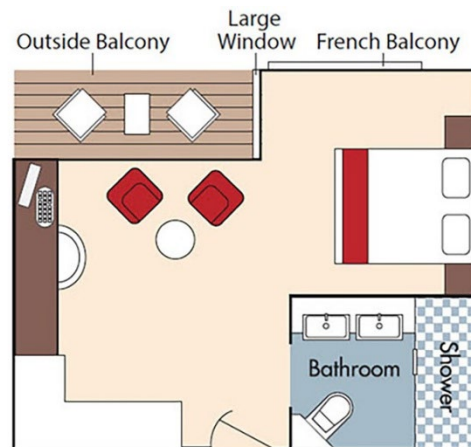



**CAT. AA, Violin Deck**  
**French Balcony & Outside Balcony, 235 sq. ft.**



Brochure Rate = ~~\$7,778 pp~~  
 Wine Cruise Rate = \$6,778 pp

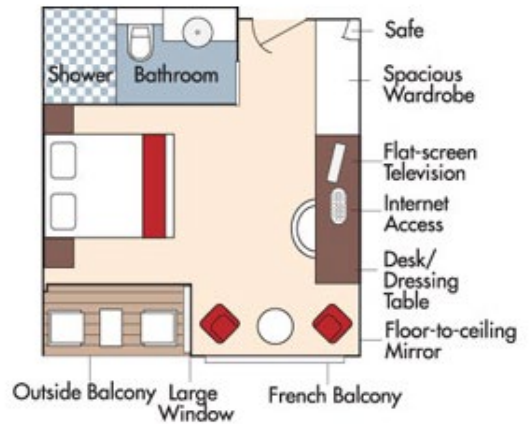

**CAT. AB, Cello Deck**  
**French Balcony & Outside Balcony, 235 sq. ft.**



Brochure Rate = ~~\$7,578 pp~~  
 Wine Cruise Rate = \$6,578 pp

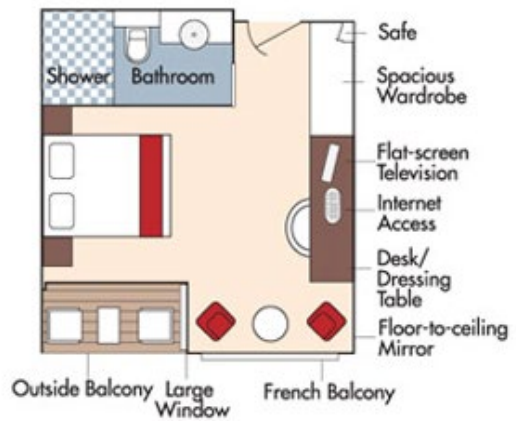

**CAT. BA, Violin Deck**  
**French Balcony & Outside Balcony, 210 sq. ft.**



Brochure Rate = ~~\$7,378 pp~~  
 Wine Cruise Rate = \$6,378 pp

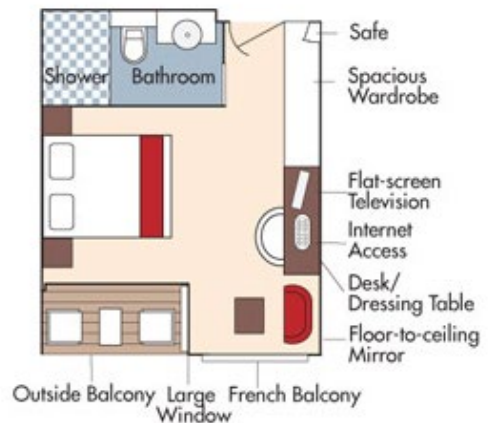

**CAT. BB, Cello Deck**  
**French Balcony & Outside Balcony, 210 sq. ft.**



Brochure Rate = ~~\$7,178 pp~~  
Wine Cruise Rate = \$6,178 pp

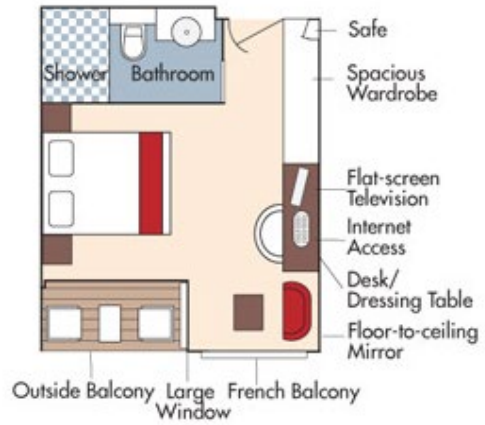

**CAT. C, Violin & Cello Deck**  
**French Balcony, 170 sq. ft.**



Brochure Rate = ~~\$6,578 pp~~  
Wine Cruise Rate = \$5,578 pp

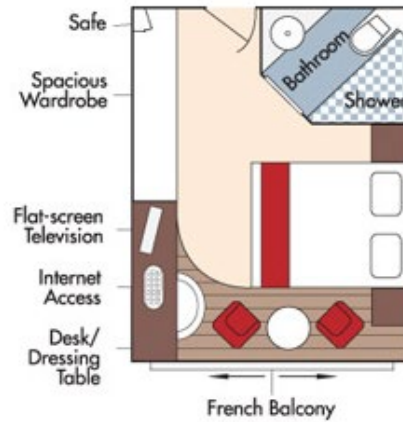



**CAT. D, Piano Deck**  
Fixed Windows, 160 sq. ft.

Brochure Rate = \$5,029 pp  
Wine Cruise Rate = \$4,029 pp

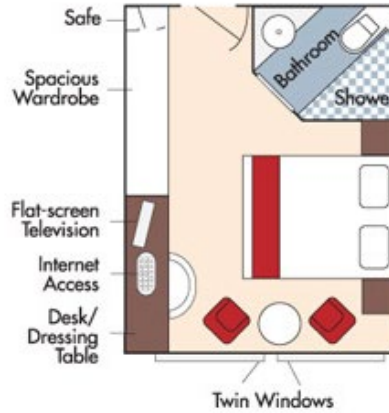

**CAT. E, Piano Deck**  
Fixed Windows, 160 sq. ft.

Brochure Rate = \$4,979 pp  
Wine Cruise Rate = \$3,979 pp

## AmaPrima DECK PLAN

1	Lower Sun Deck
2	Navigation Bridge
3	Bicycles
4	Heated Pool
5	Sun Deck
6	Walking Track
7	Al Fresco Dining Terrace
8	Observation Lounge
9	Main Lounge & Bar
10	Gift Shop
11	Reception
12	Fitness Room
13	Massage & Hair Salon
14	The Chef's Table Restaurant
15	Main Restaurant
16	Elevator
17	Crew Cabins

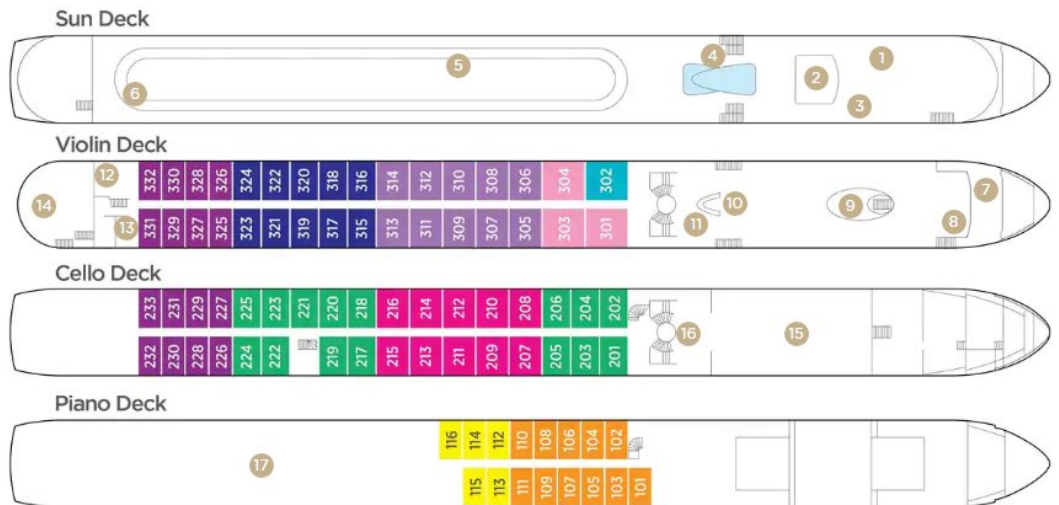

Note: Elevator reaches the Violin and Cello Deck (does not reach Piano Deck or Sun Deck).

Stateroom Categories

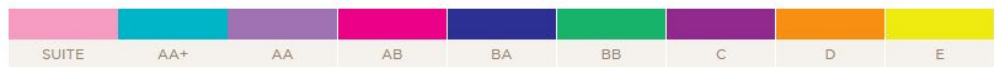

Fares listed are cruise-only, per person based on double occupancy and INCLUDE port charges of \$280 per person.