

SAVOR A WINE CRUISE THROUGH FRANCE WITH KOBLER ESTATE!

**Book by May 31, 2026
and SAVE
\$500 per person!**

**7 Nights • July 23 to 30, 2026
Arles to Lyon – Aboard AmaKristina**

Note: Stateroom layouts shown below are not to scale.



Suite *Violin Deck*

French Balcony & Outside Balcony, 350 sq. ft.

Brochure Rate ~~\$9,347~~ pp

Wine cruise rate **\$8,847** pp

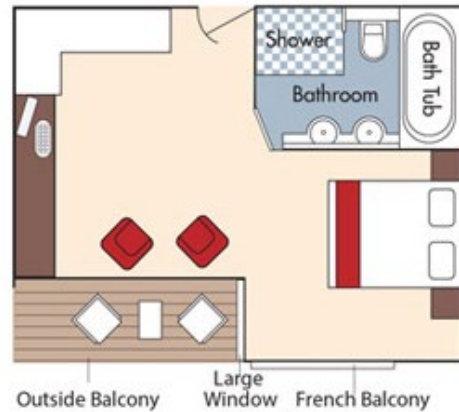

Category AA *Violin Deck*

French Balcony & Outside Balcony, 235 sq. ft.

Brochure Rate ~~\$8,047~~ pp

Wine cruise rate **\$7,547** pp

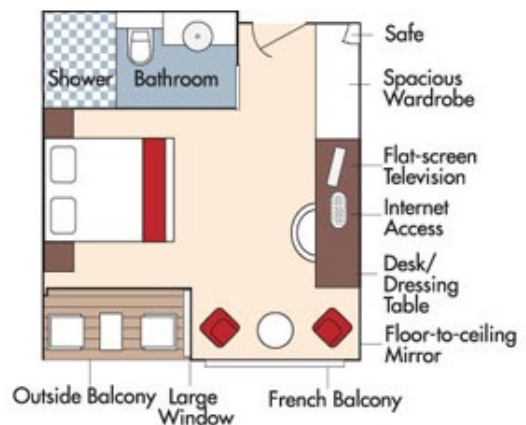

Fares listed are cruise-only, per person based on double occupancy inclusive of port charges of \$250 per person and include the exclusive wine package.



Category AB *Cello Deck*

French Balcony & Outside Balcony, 235 sq. ft.

Brochure Rate ~~\$7,847~~ pp

Wine cruise rate \$7,347 pp

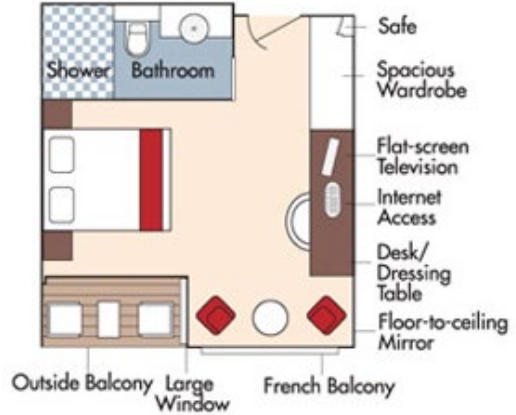

Category BA *Violin Deck*

French Balcony & Outside Balcony, 210 sq. ft.

Brochure Rate ~~\$7,647~~ pp

Wine cruise rate \$7,147 pp

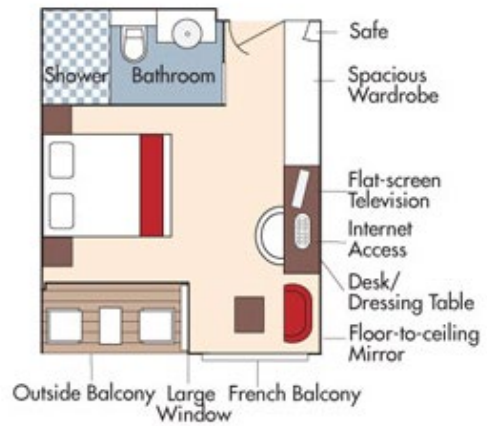



Category BB *Cello Deck*

French Balcony & Outside Balcony, 210 sq. ft.

Brochure Rate ~~\$7,447 pp~~

Wine cruise rate \$6,947 pp

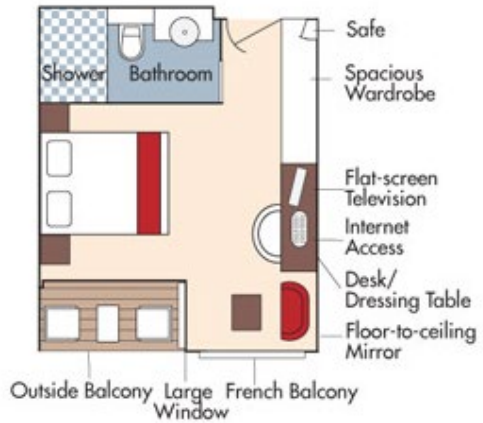

Category CA *Violin & Cello Deck*

French Balcony, 170 sq. ft.

Brochure Rate ~~\$6,847 pp~~

Wine cruise rate \$6,347 pp

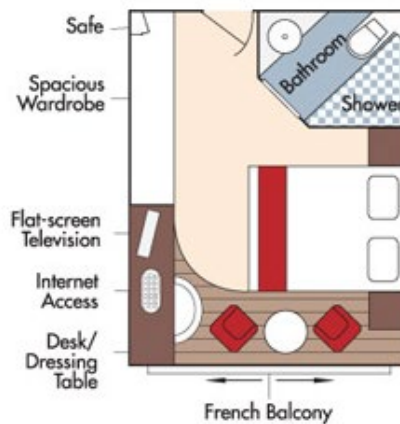

Category CB *Violin Deck*

French Balcony, 155 sq. ft.

Brochure Rate ~~\$6,447 pp~~

Wine cruise rate \$5,947 pp

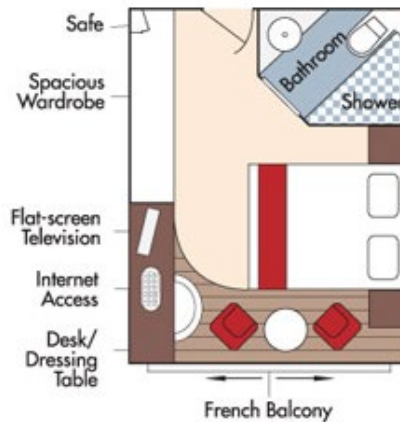

Fares listed are cruise-only, per person based on double occupancy inclusive of port charges of \$250 per person and include the exclusive wine package.

Category D *Piano Deck*
Fixed Windows, 160 sq. ft.



Brochure Rate ~~\$5,647~~ pp
Wine cruise rate \$5,147 pp

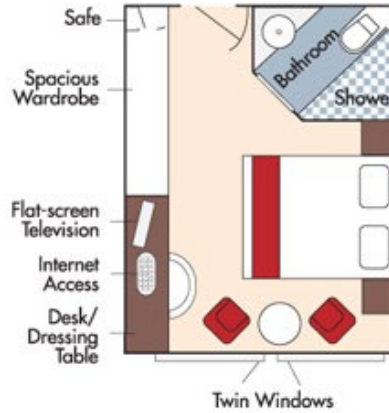

Category E *Piano Deck*
Fixed Windows, 160 sq. ft.

Brochure Rate ~~\$5,348~~ pp
Wine cruise rate \$4,848 pp

AmaKristina DECK PLAN

1	Lower Sun Deck
2	Navigation Bridge
3	Bicycles
4	Heated Pool
5	Sun Deck
6	Walking Track
7	Al Fresco Terrace
8	Observation Lounge
9	Main Lounge & Bar
10	Gift Shop
11	Reception
12	The Chef's Table Restaurant
13	Main Restaurant
14	Elevator
15	Massage & Hair Salon
16	Fitness Room
17	Crew Cabins

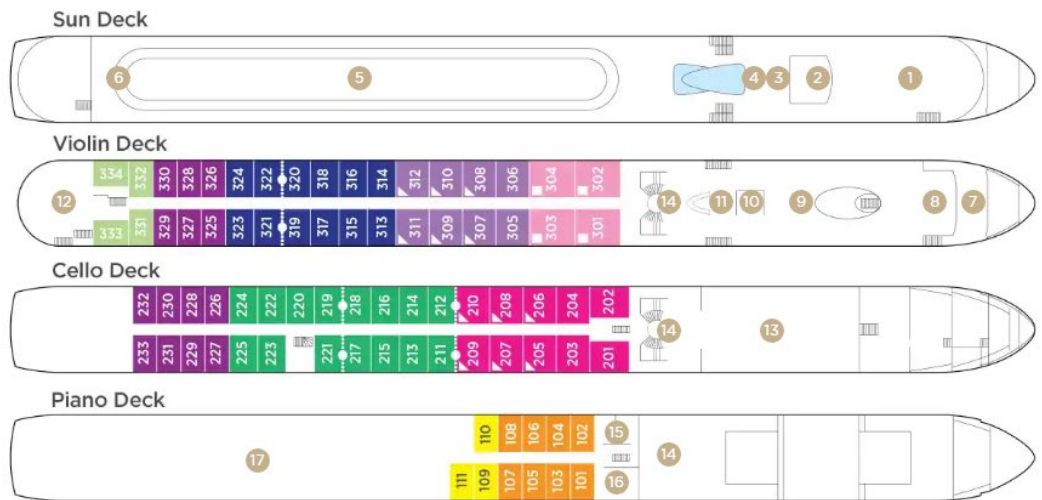

Note: Elevator reaches the Violin, Cello and Piano Deck (does not reach the Sun Deck).

Staterooms can become adjoining by request.

Up to triple occupancy

Stateroom Categories



Fares listed are cruise-only, per person based on double occupancy inclusive of port charges of \$250 per person and include the exclusive wine package.