

# EXPLORE THE ENTICING DOURO WITH GARY FARRELL VINEYARDS & WINERY

Aboard AmaSintra • 7 Nights • April 16 to 23, 2027

**Book by May 31, 2026  
and SAVE up to \$500 per person!**

Note: Stateroom layouts shown below are not to scale.

## Suite *Porto Deck* Balcony, 323 sq. ft.

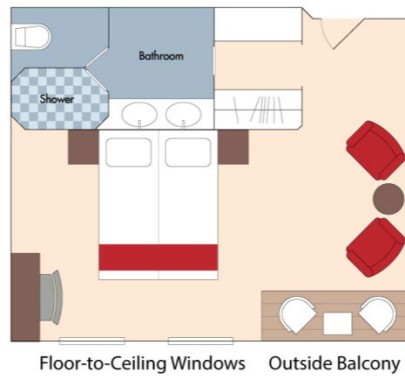

Brochure Fare: ~~\$9,777~~ pp  
Your Rate: \$9,277 pp

## Category A *Porto Deck* Balcony, 215 sq. ft.

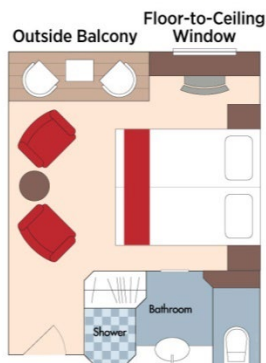

Brochure Fare: ~~\$8,277~~ pp  
Your Rate: \$7,777 pp

## Category B *Lisbon Deck* Balcony, 215 sq. ft.

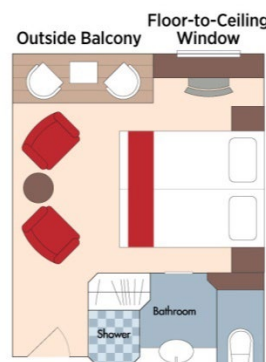

Brochure Fare: ~~\$7,977~~ pp  
Your Rate: \$7,477 pp

Fares listed are cruise-only, per person based on double occupancy AND INCLUDE port charges of \$280 per person.

**Category C *Porto Deck*** French Balcony, 161 sq. ft.

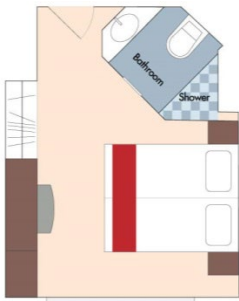

French Balcony

Brochure Fare: \$7,177 pp  
Your Rate: \$6,677 pp

**Category D *Douro Deck*** Panoramic Window, 161 sq. ft.

**Category E *Douro Deck*** Panoramic Window, 161 sq. ft.

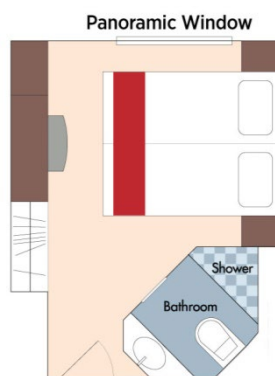

Category D  
Brochure Fare: \$5,977 pp  
Your Rate: \$5,477 pp

Category E  
Brochure Fare: \$5,578 pp  
Your Rate: \$5,078 pp

## DECK PLAN

1	Main Lounge
2	Reception
3	Elevator
4	Main Restaurant
5	Fitness Room
6	Spa

### Sun Deck

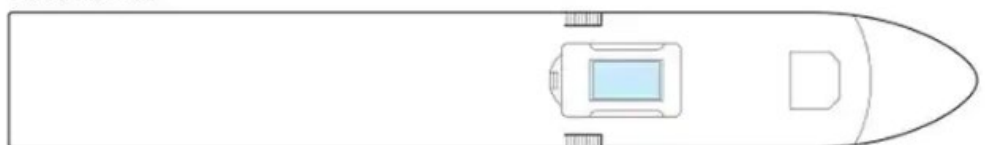

### Porto Deck

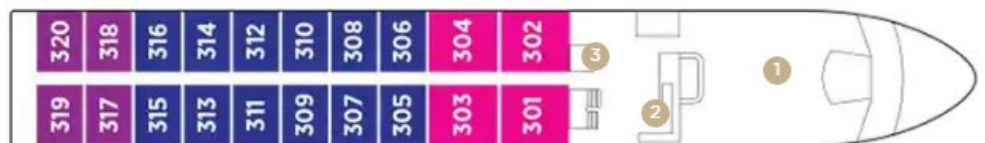

### Lisbon Deck



### Douro Deck



Stateroom Categories

