

PARIS & NORMANDY

A Voyage with the Winegrowers of Dry Creek Valley

Aboard AmaLyra • 7 Nights • June 18 to 25, 2026

Paris • Les Andelys • Le Havre • Caudebec-en-Caux • Rouen • Vernon • Paris

**SAVE \$250 PER PERSON WHEN
BOOKED BY MARCH 31, 2026!**

Note: Stateroom layouts shown below are not to scale.

Suite, Violin Deck
French Balcony, 255 sq. ft.

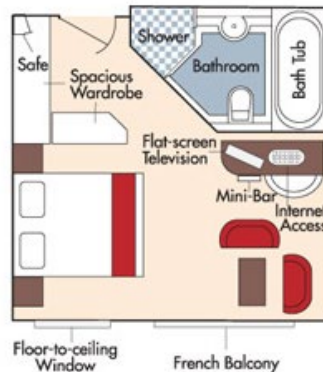

Brochure Rate: ~~\$8,647 pp~~

Wine Cruise Rate: \$8,397 pp

CAT. A+, Violin Deck
French Balcony, 225 sq. ft.

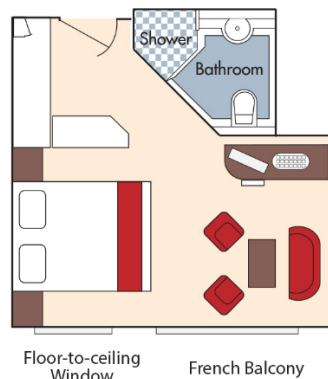

Brochure Rate: ~~\$8,347 pp~~

Wine Cruise Rate: \$8,097 pp

Fares listed are cruise-only, per person based on double occupancy inclusive of port charges of \$250 per person.

CAT. A, Violin Deck
French Balcony, 170 sq. ft.

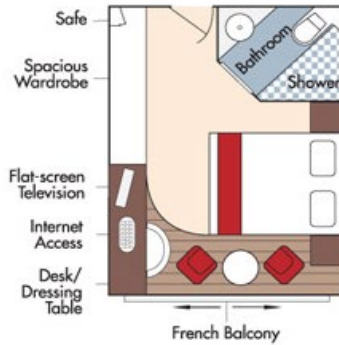

Brochure Rate: ~~\$7,347 pp~~
Wine Cruise Rate: \$7,097 pp

CAT. B, Violin & Cello Deck
French Balcony, 170 sq. ft.

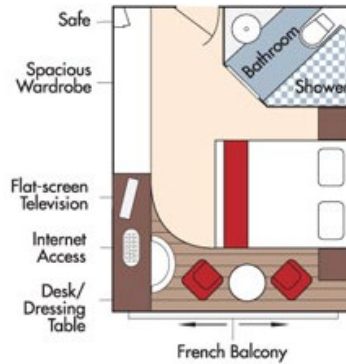

Brochure Rate: ~~\$7,247 pp~~
Wine Cruise Rate: \$6,997 pp

CAT. C, Violin & Cello Deck
French Balcony, 170 sq. ft.

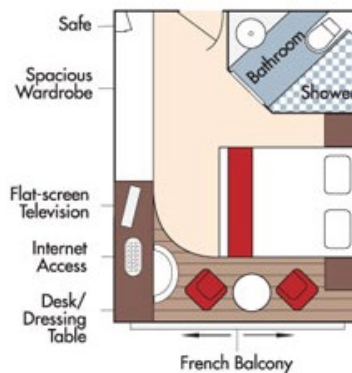

Brochure Rate: ~~\$6,947 pp~~
Wine Cruise Rate: \$6,697 pp



CAT. E, Piano Deck
Fixed Windows, 170 sq. ft.



CAT. D, Piano Deck
Fixed Windows, 170 sq. ft.

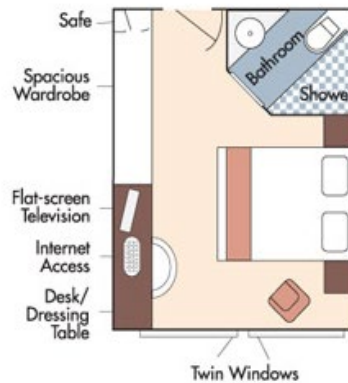

Category D
Brochure Rate: ~~\$5,747 pp~~
Wine Cruise Rate: \$5,497 pp

Category E
Brochure Rate: ~~\$5,448 pp~~
Wine Cruise Rate: \$5,198 pp

AmaLyra DECK PLAN

1	Observation Deck
2	Navigation Bridge
3	Bicycles
4	Whirlpool
5	Sun Deck
6	Walking Track
7	Bow Seating Area
8	Main Lounge & Bar
9	Gift Shop
10	Reception
11	Massage & Hair Salon
12	The Chef's Table Restaurant
13	Fitness Room
14	Main Restaurant
15	Elevator
16	Crew Cabins

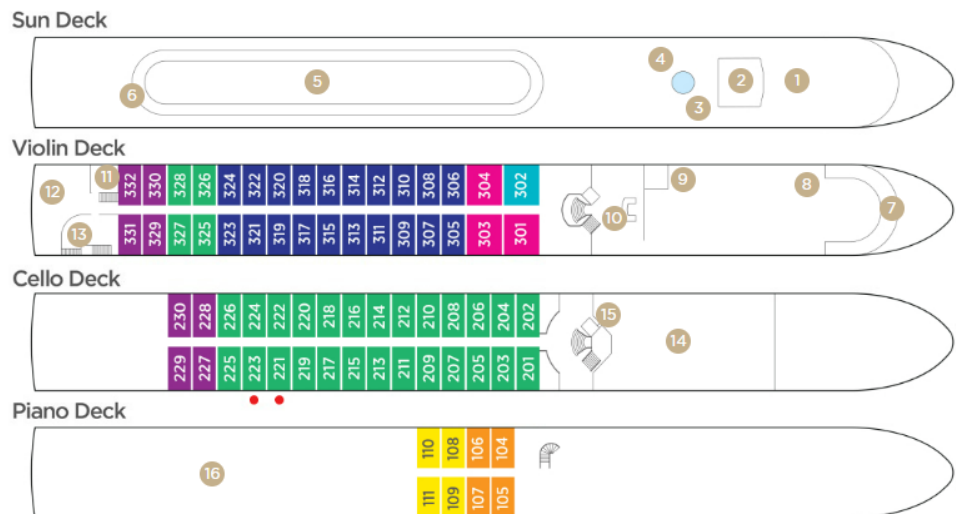

Note: Elevator reaches Main Restaurant, Lobby/Main Lounge and staterooms on Violin and Cello Deck (does not reach Piano Deck or Sun Deck).

Stateroom Categories							
SUITE	A+	A	B	C	D	E	Single

Fares listed are cruise-only, per person based on double occupancy inclusive of port charges of \$250 per person.