

SAVOR THE FLAVORS OF BURGUNDY WITH THE WINES OF THE SANTA CRUZ MOUNTAINS

Aboard AmaCello • 7 Nights • June 17-24, 2027

Lyon • Mâcon • Tournus • Chalon-Sur-Saône • Beaune • Seurre • Port of Dijon

**Book by January 31, 2026
and SAVE \$500 per person**

Note: Stateroom layouts shown below are not to scale.



Suite, Violin Deck
French Balcony, 255 sq. ft.

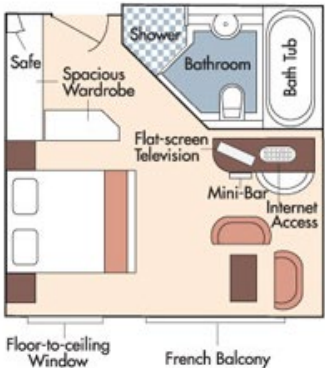

Brochure Fare: ~~\$9,377~~ pp
Your Rate: \$8,877 pp



CAT. A, Violin Deck
French Balcony, 170 sq. ft.

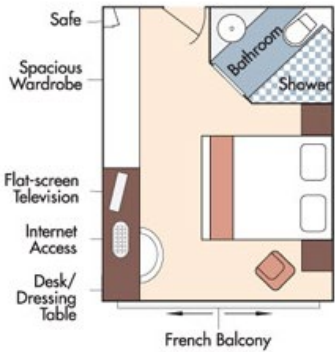

Brochure Fare: ~~\$7,877~~ pp
Your Rate: \$7,377 pp



CAT. B, Violin & Cello Deck
French Balcony, 170 sq. ft.

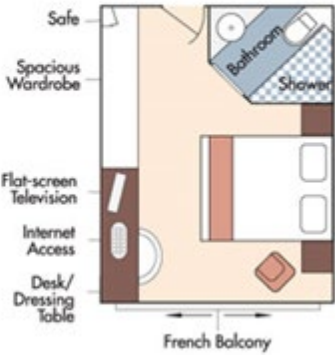

Brochure Fare: ~~\$7,777~~ pp
Your Rate: \$7,277 pp

Fares listed are cruise-only, per person based on double occupancy inclusive of port charges of \$280 per person.

CAT. C, Violin & Cello Deck
French Balcony, 170 sq. ft.

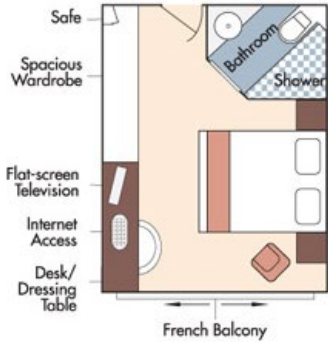

Brochure Fare: ~~\$7,577~~ pp
Your Rate: \$7,077 pp

CAT. E, Piano Deck
Fixed Windows, 170 sq. ft.



CAT. D, Piano Deck
Fixed Windows, 170 sq. ft.

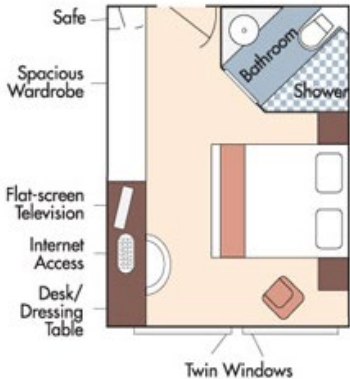

Category D
Brochure Fare: ~~\$6,028~~ pp
Your Rate: \$5,528 pp

Category E
Brochure Fare: ~~\$5,978~~ pp
Your Rate: \$5,478 pp

AmaCello
DECK PLAN

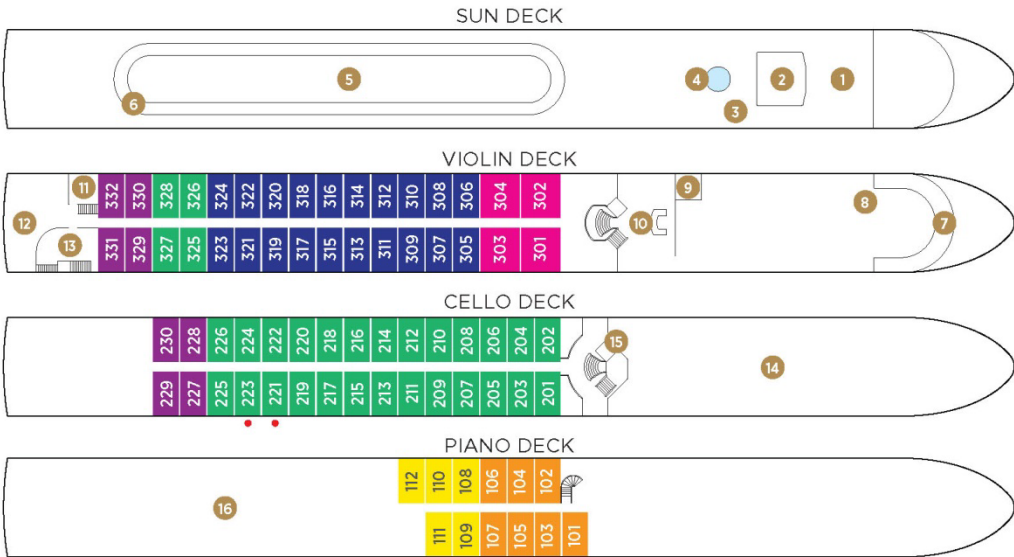

- 1 Observation Deck
- 2 Navigation Bridge
- 3 Bicycles
- 4 Whirlpool
- 5 Sun Deck
- 6 Walking Track
- 7 Bow Seating Area
- 8 Main Lounge & Bar
- 9 Gift Shop
- 10 Reception
- 11 Massage & Hair Salon
- 12 The Chef's Table Restaurant
- 13 Fitness Room
- 14 Main Restaurant
- 15 Elevator
- 16 Crew Cabins

Elevator reaches Main Restaurant, Lobby/Main Lounge and staterooms on Violin and Cello Deck.

Suite	Violin Deck / French Balcony - 255 sq. ft.	Cat. D	Piano Deck / Fixed Windows - 170 sq. ft.
Cat. A	Violin Deck / French Balcony - 170 sq. ft.	Cat. E	Piano Deck / Fixed Windows - 170 sq. ft.
Cat. B	Violin & Cello Deck / French Balcony - 170 sq. ft.	Single	Cello Deck / French Balcony - 140 sq. ft. (Single staterooms only available on AmaCello)
Cat. C	Violin & Cello Deck / French Balcony - 170 sq. ft.		

Fares listed are cruise-only, per person based on double occupancy inclusive of port charges of \$280 per person.