

# EXPLORE THE ENTICING DOURO WITH THE PETALUMA GAP WINEGROWERS ALLIANCE

Aboard AmaSintra • 7 Nights • May 14 to 21, 2027

Book by January 31, 2026  
and SAVE up to \$500 per person!

Note: Stateroom layouts shown below are not to scale.



Suite *Porto Deck* Balcony, 323 sq. ft.

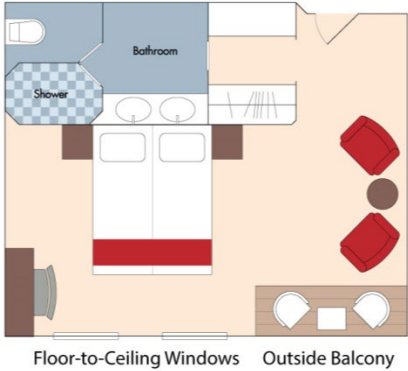

Brochure Fare: ~~\$10,077~~ pp  
Your Rate: \$9,577 pp



Category A *Porto Deck* Balcony, 215 sq. ft.

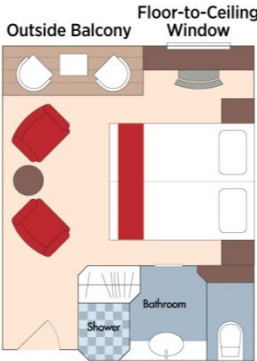

Brochure Fare: ~~\$8,577~~ pp  
Your Rate: \$8,077 pp



Category B *Lisbon Deck* Balcony, 215 sq. ft.

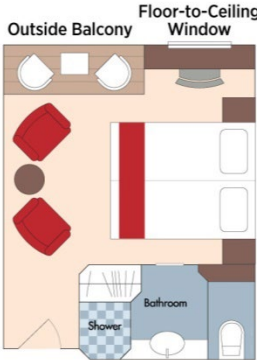

Brochure Fare: ~~\$8,277~~ pp  
Your Rate: \$7,777 pp

Fares listed are cruise-only, per person based on double occupancy AND INCLUDE port charges of \$280 per person.



Category C *Porto Deck* French Balcony, 161 sq. ft.

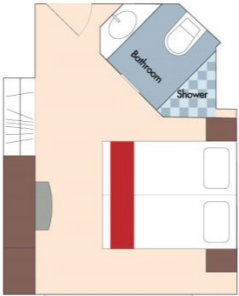

Brochure Fare: \$7,477 pp  
Your Rate: \$6,977 pp



Category D *Douro Deck* Panoramic Window, 161 sq. ft.



Category E *Douro Deck* Panoramic Window, 161 sq. ft.

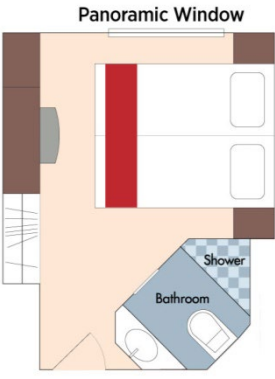

Category D  
Brochure Fare: ~~\$6,277~~ pp  
Your Rate: \$5,777 pp

Category E  
Brochure Fare: ~~\$5,878~~ pp  
Your Rate: \$5,378 pp

DECK PLAN

1	Main Lounge
2	Reception
3	Elevator
4	Main Restaurant
5	Fitness Room
6	Spa

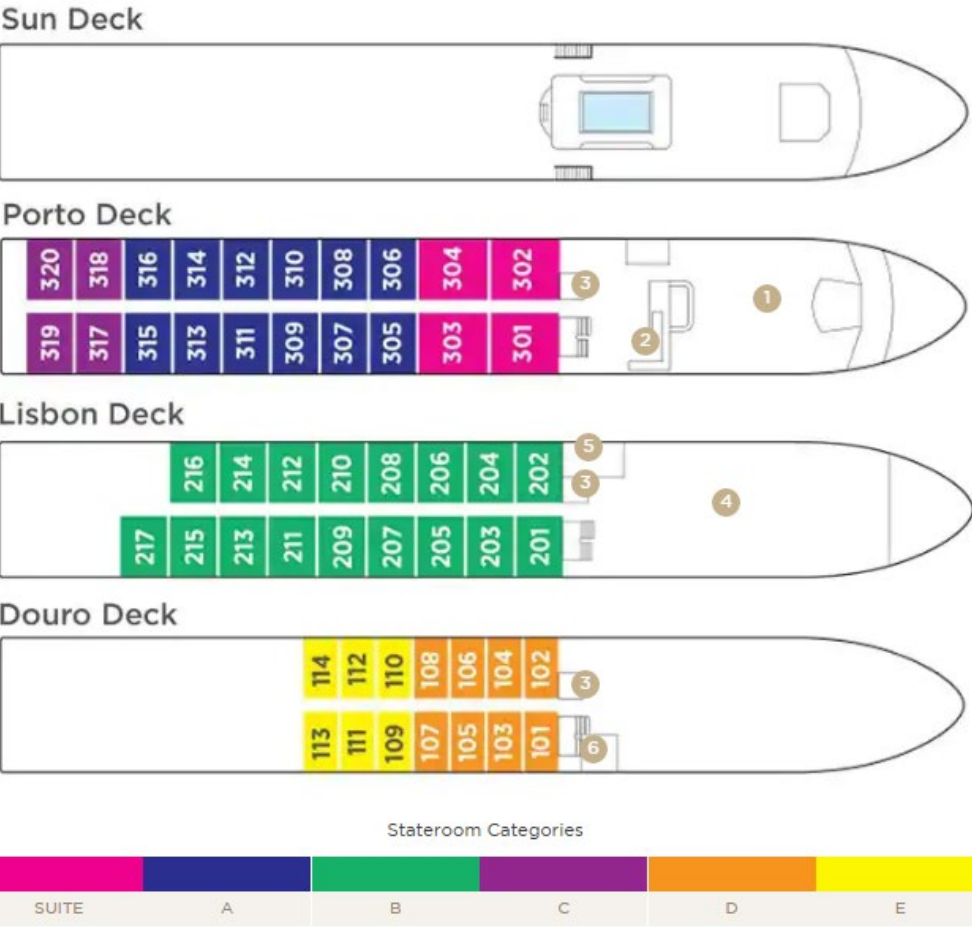

Fares listed are cruise-only, per person based on double occupancy AND INCLUDE port charges of \$280 per person.