

# EXPLORE THE ENTICING DOURO WITH PEDRONCELLI WINERY

Aboard AmaDouro • 7 Nights • May 25 to June 1, 2027

Book by January 31, 2026  
and SAVE \$250 per person!

Note: Stateroom layouts shown below are not to scale.



## Suite *Porto Deck* Balcony, 323 sq. ft.

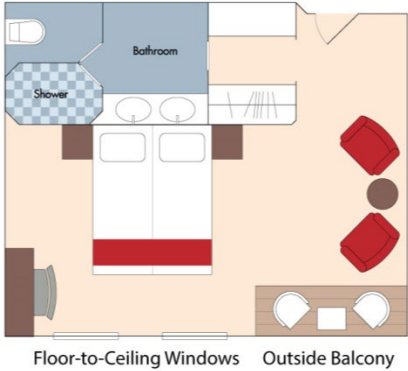

Brochure Fare: ~~\$9,877~~ pp  
Your Rate: \$9,627 pp



## Category A *Porto Deck* Balcony, 215 sq. ft.

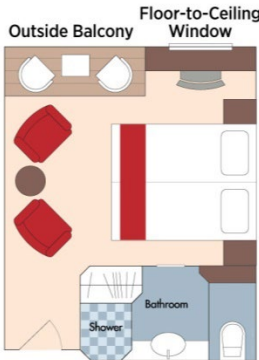

Brochure Fare: ~~\$8,377~~ pp  
Your Rate: \$8,127 pp



## Category B *Lisbon Deck* Balcony, 215 sq. ft.

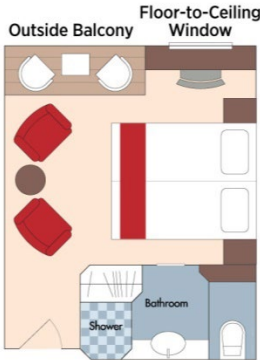

Brochure Fare: ~~\$8,077~~ pp  
Your Rate: \$7,827 pp

Fares listed are cruise-only, per person based on double occupancy AND INCLUDE port charges of \$280 per person.



Category C *Porto Deck* French Balcony, 161 sq. ft.

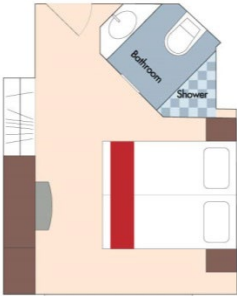

Brochure Fare: \$7,277 pp  
Your Rate: \$7,027 pp



Category D *Douro Deck* Panoramic Window, 161 sq. ft.



Category E *Douro Deck* Panoramic Window, 161 sq. ft.

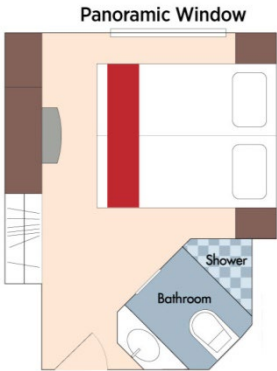

Category D  
Brochure Fare: ~~\$6,077~~ pp  
Your Rate: \$5,827 pp

Category E  
Brochure Fare: ~~\$5,678~~ pp  
Your Rate: \$5,428 pp

DECK PLAN

1	Main Lounge
2	Reception
3	Elevator
4	Main Restaurant
5	Fitness Room
6	Spa

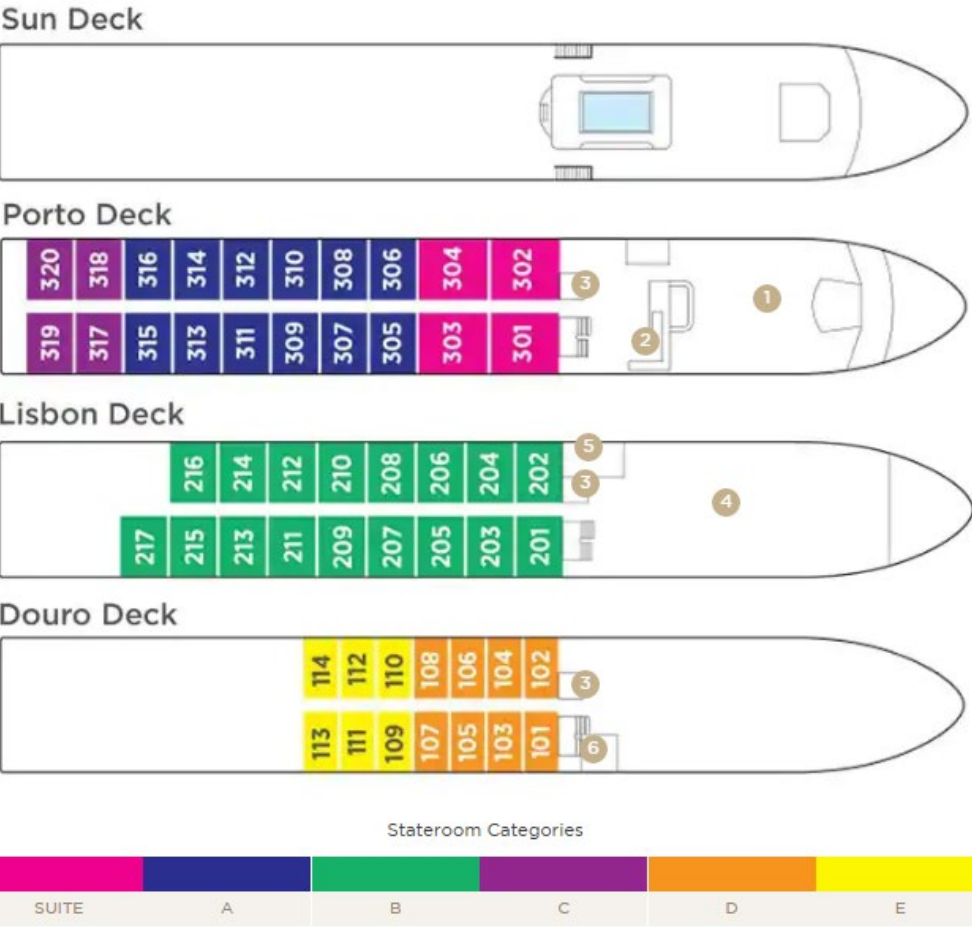

Fares listed are cruise-only, per person based on double occupancy AND INCLUDE port charges of \$280 per person.