

# SAVOR A WINE CRUISE THROUGH FRANCE WITH KOBLER ESTATE!

**Book by January 31, 2026  
and SAVE  
\$500 per person!**

**7 Nights • July 23 to 30, 2026  
Arles to Lyon – Aboard AmaKristina**

*Note: Stateroom layouts shown below are not to scale.*



## **Suite** *Violin Deck*

French Balcony & Outside Balcony, 350 sq. ft.

Brochure Rate ~~\$9,347~~ pp

**Wine cruise rate \$8,847 pp**

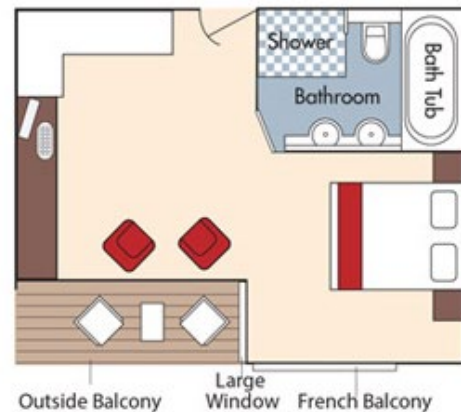

## **Category AA** *Violin Deck*

French Balcony & Outside Balcony, 235 sq. ft.

Brochure Rate ~~\$8,047~~ pp

**Wine cruise rate \$7,547 pp**

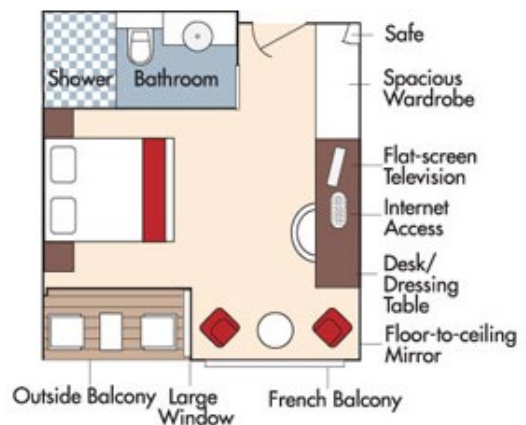

*Fares listed are cruise-only, per person based on double occupancy inclusive of port charges of \$250 per person and include the exclusive wine package.*



## Category AB *Cello Deck*

French Balcony & Outside Balcony, 235 sq. ft.

Brochure Rate ~~\$7,847 pp~~

Wine cruise rate \$7,347 pp

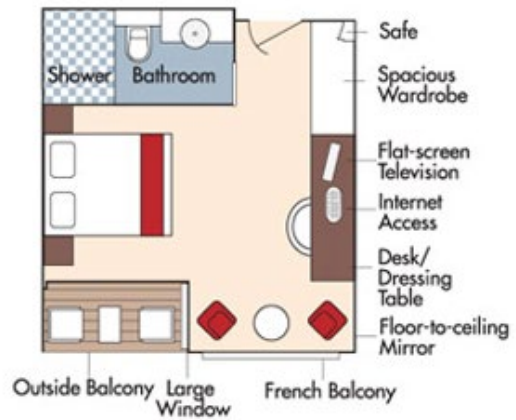

## Category BA *Violin Deck*

French Balcony & Outside Balcony, 210 sq. ft.

Brochure Rate ~~\$7,647 pp~~

Wine cruise rate \$7,147 pp

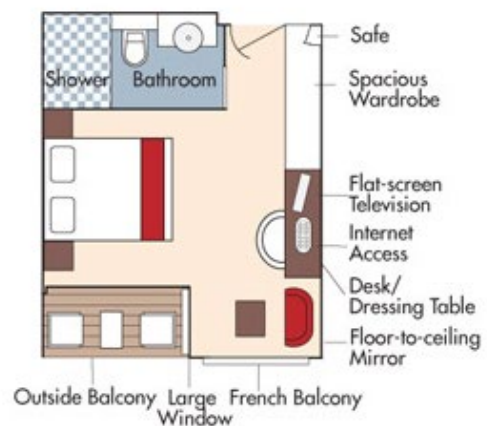





## Category BB *Cello Deck*

French Balcony & Outside Balcony, 210 sq. ft.

Brochure Rate ~~\$7,447 pp~~

Wine cruise rate \$6,947 pp

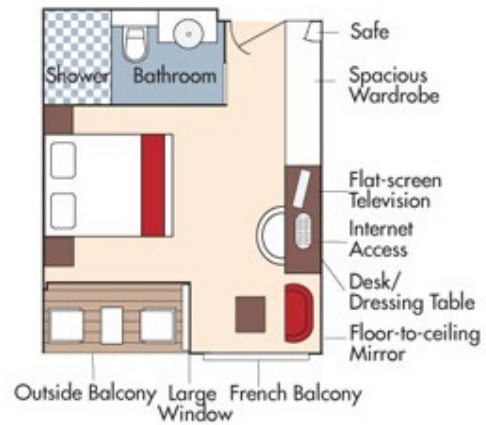

## Category CA *Violin & Cello Deck*

French Balcony, 170 sq. ft.

Brochure Rate ~~\$6,847 pp~~

Wine cruise rate \$6,347 pp

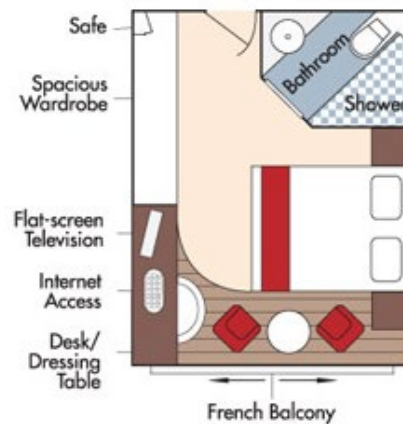

## Category CB *Violin Deck*

French Balcony, 155 sq. ft.

Brochure Rate ~~\$6,447 pp~~

Wine cruise rate \$5,947 pp

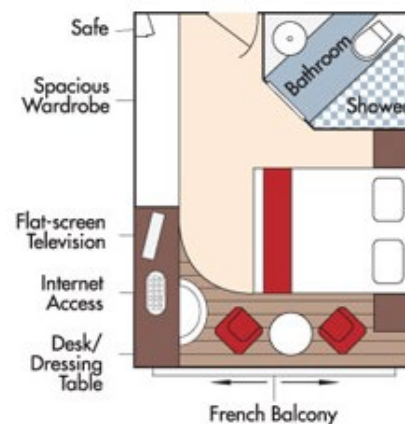

Fares listed are cruise-only, per person based on double occupancy inclusive of port charges of \$250 per person and include the exclusive wine package.



## Category D *Piano Deck*

Fixed Windows, 160 sq. ft.



Brochure Rate ~~\$5,647~~ pp

Wine cruise rate \$5,147 pp

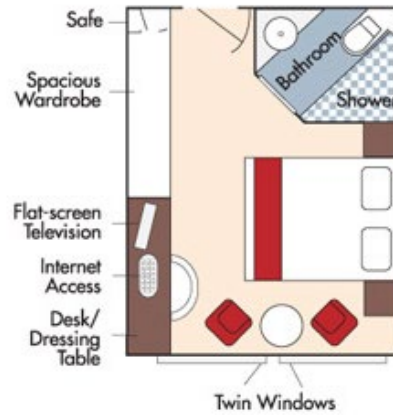

## Category E *Piano Deck*

Fixed Windows, 160 sq. ft.

Brochure Rate ~~\$5,348~~ pp

Wine cruise rate \$4,848 pp

## AmaKristina DECK PLAN

1	Lower Sun Deck
2	Navigation Bridge
3	Bicycles
4	Heated Pool
5	Sun Deck
6	Walking Track
7	Al Fresco Terrace
8	Observation Lounge
9	Main Lounge & Bar
10	Gift Shop
11	Reception
12	The Chef's Table Restaurant
13	Main Restaurant
14	Elevator
15	Massage & Hair Salon
16	Fitness Room
17	Crew Cabins

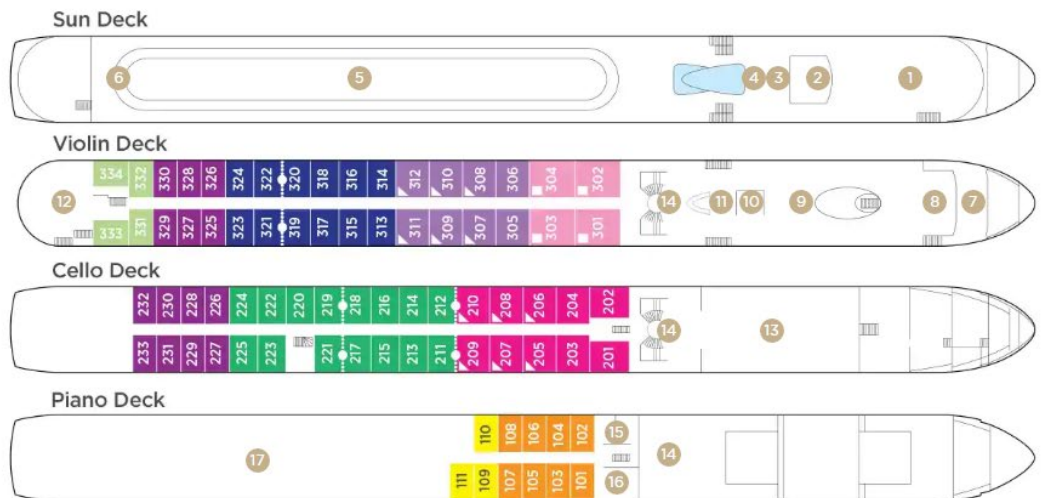

Note: Elevator reaches the Violin, Cello and Piano Deck (does not reach the Sun Deck).

..... Staterooms can become adjoining by request.

Up to triple occupancy

Stateroom Categories

SUITE	AA	AB	BA	BB	CA	CB	D	E
-------	----	----	----	----	----	----	---	---

Fares listed are cruise-only, per person based on double occupancy inclusive of port charges of \$250 per person and include the exclusive wine package.