

EXPLORE THE ENTICING DOURO WITH AMPHORA WINERY

Aboard AmaDouro • 7 Nights • April 7 to 14, 2026

Note: Stateroom layouts shown below are not to scale.

Suite *Porto Deck* Balcony, 323 sq. ft.

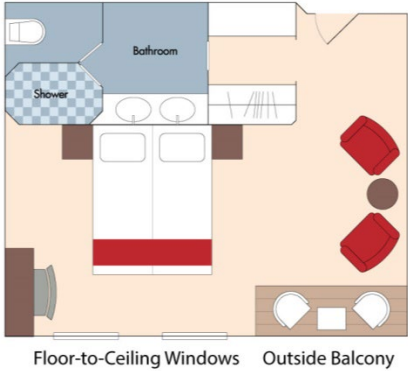

Wine Cruise Fare: \$8,747 pp

Category A *Porto Deck* Balcony, 215 sq. ft.

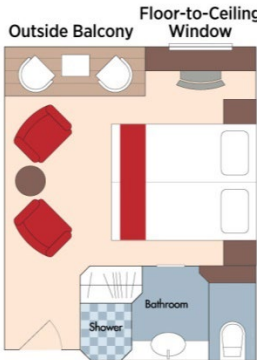

Wine Cruise Fare: \$7,247 pp

Category B *Lisbon Deck* Balcony, 215 sq. ft.

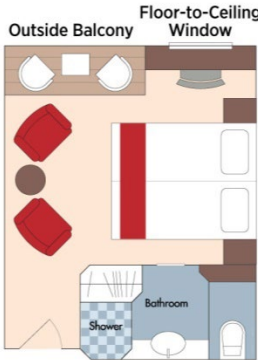

Wine Cruise Fare: \$6,947 pp

Fares listed are cruise-only, per person based on double occupancy AND INCLUDE port charges of \$250 per person.



Category C *Porto Deck* French Balcony, 161 sq. ft.

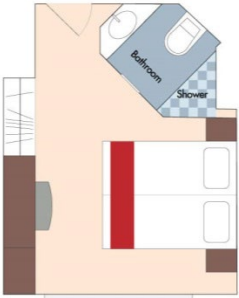

French Balcony

Wine Cruise Fare: \$6,247 pp



Category D *Douro Deck* Panoramic Window, 161 sq. ft.



Category E *Douro Deck* Panoramic Window, 161 sq. ft.

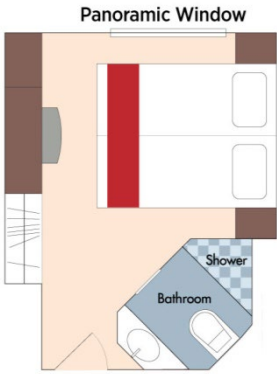

Category D
Wine Cruise Fare: \$5,097 pp

Category E
Wine Cruise Fare: \$4,748 pp

DECK PLAN

| | |
|---|-----------------|
| 1 | Main Lounge |
| 2 | Reception |
| 3 | Elevator |
| 4 | Main Restaurant |
| 5 | Fitness Room |
| 6 | Spa |

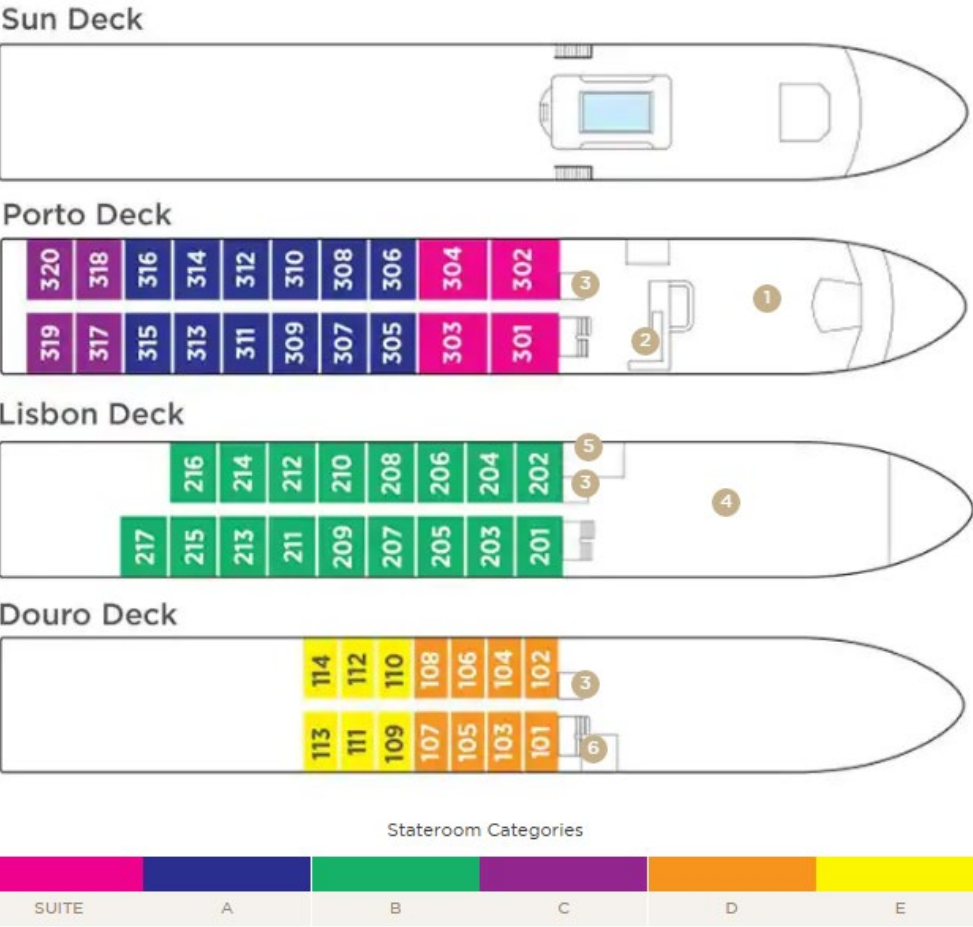

Fares listed are cruise-only, per person based on double occupancy AND INCLUDE port charges of \$250 per person.