

# SAVOR THE ESSENCE OF BURGUNDY AND PROVENCE WITH THE SONOMA VALLEY VINTNERS & GROWERS!

Aboard AmaCello • 7 Nights • June 4 to 11, 2026

Arles • Avignon • Viviers • Vienne • Lyon • Mâcon • Tournus • Chalon-Sur-Saône • Dijon

**Book by December 31, 2025  
and SAVE \$250 per person!**

*Note: Stateroom layouts shown below are not to scale.*

**Suite, Violin Deck**  
French Balcony, 255 sq. ft.

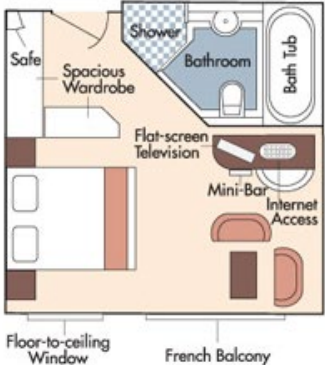

Wine Cruise Fare: ~~\$8,647~~ pp  
Your Rate: **\$8,397 pp**

**CAT. A, Violin Deck**  
French Balcony, 170 sq. ft.

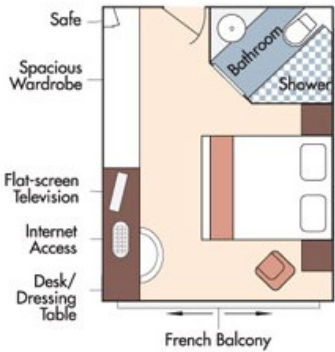

Wine Cruise Fare: ~~\$7,347~~ pp  
Your Rate: **\$7,097 pp**

**CAT. B, Violin & Cello Deck**  
French Balcony, 170 sq. ft.



Wine Cruise Fare: ~~\$7,247~~ pp  
Your Rate: **\$6,997 pp**

*Fares listed are cruise-only, per person based on double occupancy inclusive of port charges of \$250 per person.*

CAT. C, Violin & Cello Deck  
French Balcony, 170 sq. ft.

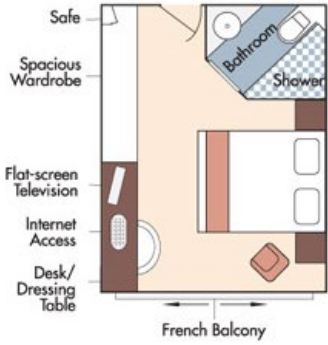

Wine Cruise Fare: ~~\$6,947~~ pp  
Your Rate: \$6,697 pp

CAT. E, Piano Deck  
Fixed Windows, 170 sq. ft.

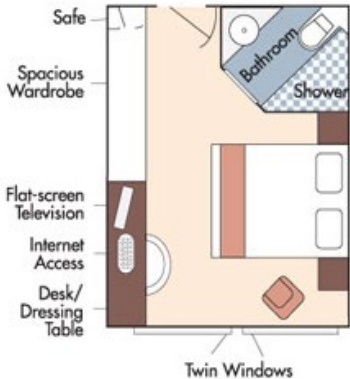

Category D  
Wine Cruise Fare: ~~\$5,747~~ pp  
Your Rate: \$5,497 pp

Category E  
Wine Cruise Fare: ~~\$5,448~~ pp  
Your Rate: \$5,198 pp

AmaCello  
DECK PLAN

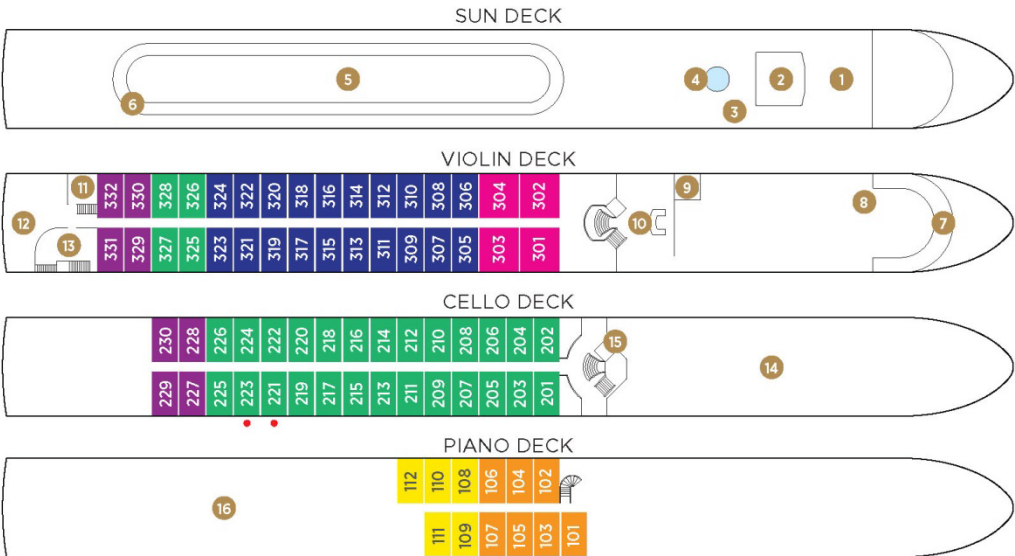

- 1 Observation Deck
- 2 Navigation Bridge
- 3 Bicycles
- 4 Whirlpool
- 5 Sun Deck
- 6 Walking Track
- 7 Bow Seating Area
- 8 Main Lounge & Bar
- 9 Gift Shop
- 10 Reception
- 11 Massage & Hair Salon
- 12 The Chef's Table Restaurant
- 13 Fitness Room
- 14 Main Restaurant
- 15 Elevator
- 16 Crew Cabins

Suite	Violin Deck / French Balcony - 255 sq. ft.	Cat. D	Piano Deck / Fixed Windows - 170 sq. ft.
Cat. A	Violin Deck / French Balcony - 170 sq. ft.	Cat. E	Piano Deck / Fixed Windows - 170 sq. ft.
Cat. B	Violin & Cello Deck / French Balcony - 170 sq. ft.	Single	Cello Deck / French Balcony - 140 sq. ft. (Single staterooms only available on AmaCello)
Cat. C	Violin & Cello Deck / French Balcony - 170 sq. ft.		

Fares listed are cruise-only, per person based on double occupancy inclusive of port charges of \$250 per person.