



Special Rates when you  
book by February 28, 2026

# RIVER CRUISE FOR WINE LOVERS

## Highland Valley Vineyards

Aboard AmaPrima • 7 Nights • March 18 – 25, 2026  
Amsterdam to Basel

*Note: Stateroom layouts shown below are not to scale.*



**Suite, Violin Deck**  
French Balcony & Outside Balcony, 300 sq. ft.

Brochure Fare \$7,548 pp  
**Your rate \$7,298 pp**

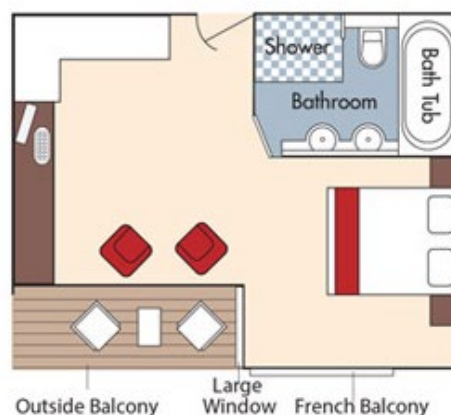

**CAT. AA, Violin Deck**  
French Balcony & Outside Balcony, 235 sq. ft.

Brochure Fare ~~\$6,248~~ pp  
**Your rate \$5,998 pp**

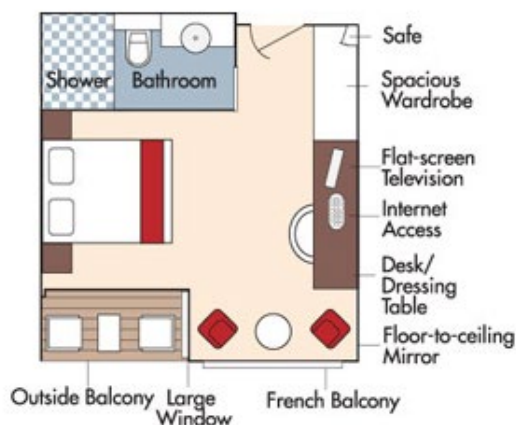

*Fares listed are cruise-only, per person based on double occupancy and INCLUDES port charges of \$250 per person.*



**CAT. AB, Cello Deck**  
**French Balcony & Outside Balcony, 235 sq. ft.**

Brochure Fare \$6,048 pp  
Your rate \$5,798 pp

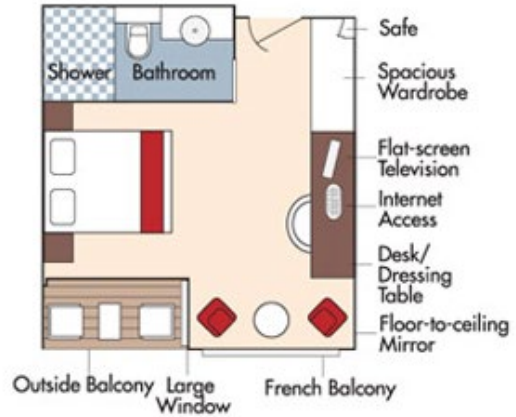

**CAT. BA, Violin Deck**  
**French Balcony & Outside Balcony, 210 sq. ft.**

Brochure Fare \$5,848 pp  
Your rate \$5,598 pp

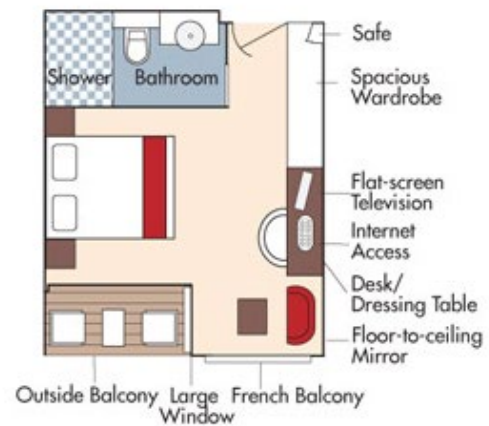



**CAT. BB, Cello Deck**  
**French Balcony & Outside Balcony, 210 sq. ft.**

Brochure Fare ~~\$5,648~~ pp  
Your rate **\$5,398** pp

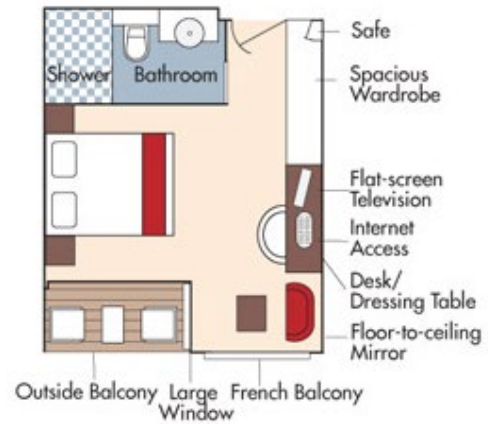

**CAT. C, Violin & Cello Deck**  
**French Balcony, 170 sq. ft.**

Category C  
Brochure Fare ~~\$5,048~~ pp  
Your rate **\$4,798** pp

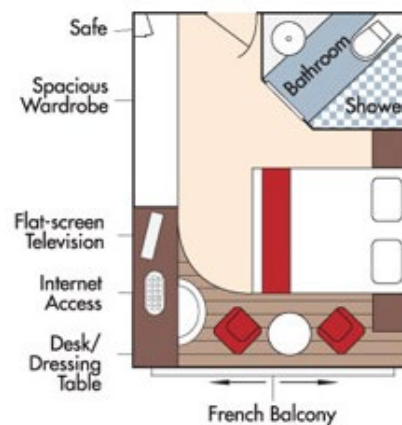





**CAT. D, Piano Deck**  
Fixed Windows, 160 sq. ft.

Brochure Fare ~~\$3,848~~ pp  
Your rate **\$3,598** pp

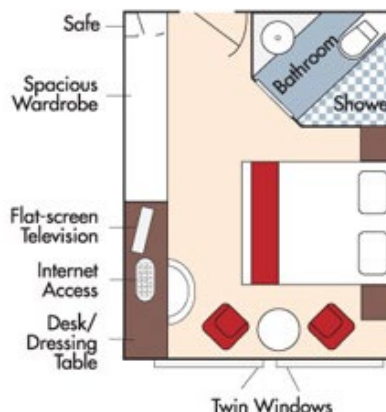

**CAT. E, Piano Deck**  
Fixed Windows, 160 sq. ft.

Brochure Fare ~~\$3,549~~ pp  
Your rate **\$3,299** pp

## AmaPrima DECK PLAN

1	Lower Sun Deck
2	Navigation Bridge
3	Bicycles
4	Heated Pool
5	Sun Deck
6	Walking Track
7	Al Fresco Dining Terrace
8	Observation Lounge
9	Main Lounge & Bar
10	Gift Shop
11	Reception
12	Fitness Room
13	Massage & Hair Salon
14	The Chef's Table Restaurant
15	Main Restaurant
16	Elevator
17	Crew Cabins

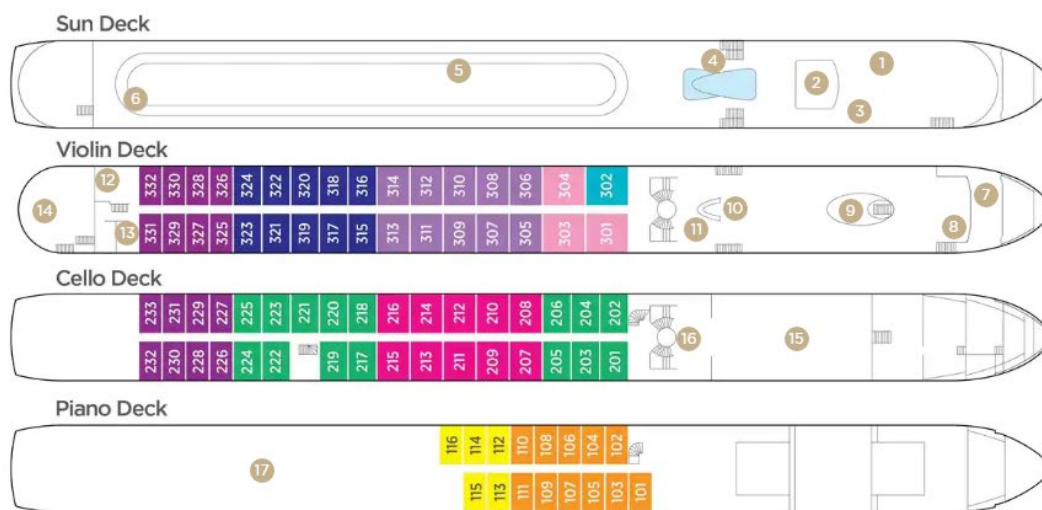

*Note: Elevator reaches the Violin and Cello Deck (does not reach Piano Deck or Sun Deck).*

### Stateroom Categories

SUITE	AA+	AA	AB	BA	BB	C	D	E
-------	-----	----	----	----	----	---	---	---

*Fares listed are cruise-only, per person based on double occupancy and INCLUDES port charges of \$250 per person.*