

EXPLORE THE ENTICING DOURO WITH GARY FARRELL VINEYARDS & WINERY

Aboard AmaSintra • 7 Nights • April 16 to 23, 2027

**Book by December 31, 2025
and SAVE up to \$500 per person!**

Note: Stateroom layouts shown below are not to scale.



Suite *Porto Deck* Balcony, 323 sq. ft.

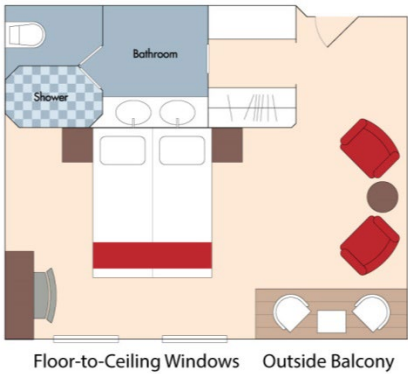

Brochure Fare: ~~\$9,777~~ pp
Your Rate: **\$9,277 pp**



Category A *Porto Deck* Balcony, 215 sq. ft.

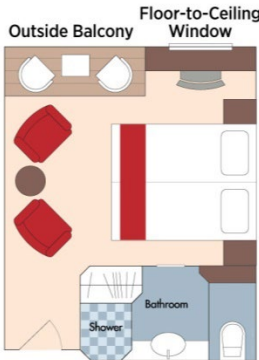

Brochure Fare: ~~\$8,277~~ pp
Your Rate: **\$7,777 pp**



Category B *Lisbon Deck* Balcony, 215 sq. ft.

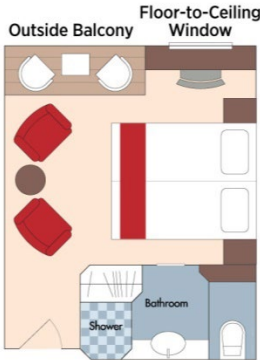

Brochure Fare: ~~\$7,977~~ pp
Your Rate: **\$7,477 pp**

Fares listed are cruise-only, per person based on double occupancy AND INCLUDE port charges of \$280 per person.



Category C *Porto Deck* French Balcony, 161 sq. ft.

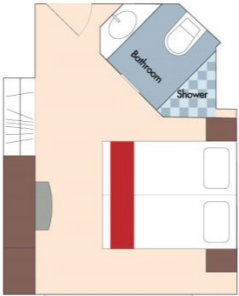

French Balcony

Brochure Fare: \$7,177 pp
Your Rate: \$6,677 pp



Category D *Douro Deck* Panoramic Window, 161 sq. ft.



Category E *Douro Deck* Panoramic Window, 161 sq. ft.

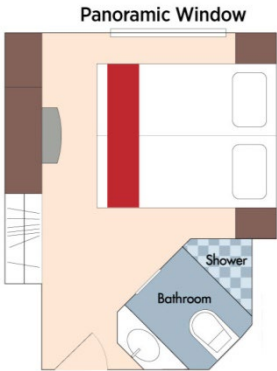

Category D
Brochure Fare: ~~\$5,977~~ pp
Your Rate: \$5,477 pp

Category E
Brochure Fare: ~~\$5,578~~ pp
Your Rate: \$5,078 pp

DECK PLAN

1	Main Lounge
2	Reception
3	Elevator
4	Main Restaurant
5	Fitness Room
6	Spa

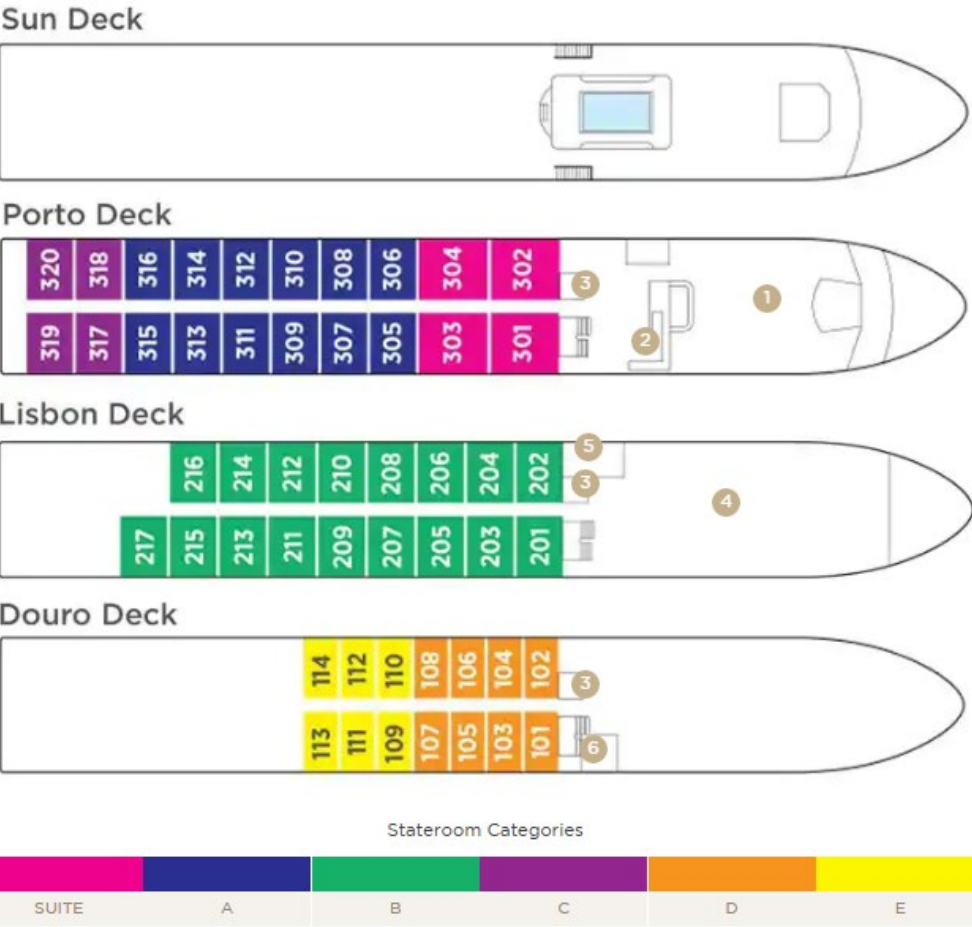

Fares listed are cruise-only, per person based on double occupancy AND INCLUDE port charges of \$280 per person.