

# UNCORK THE HISTORY, WINE & CULTURE OF PORTUGAL

Aboard AmaSintra • 7 Nights • July 24 to 31, 2026

Book by September 30, 2025  
and SAVE \$650 per person!

Note: Stateroom layouts shown below are not to scale.



Suite *Porto Deck* Balcony, 323 sq. ft.

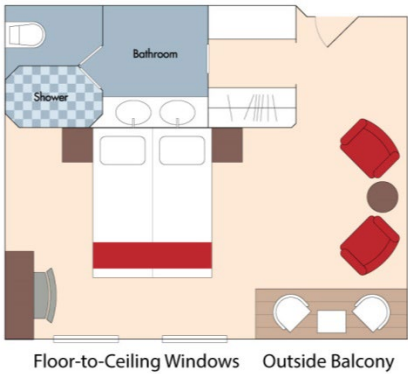

Brochure Fare: ~~\$9,247~~ pp  
Your Rate: \$8,597 pp



Category A *Porto Deck* Balcony, 215 sq. ft.

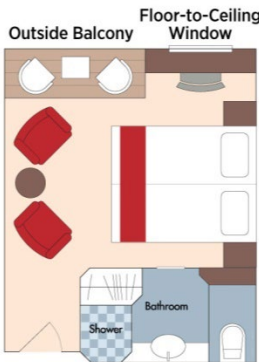

Brochure Fare: ~~\$7,747~~ pp  
Your Rate: \$7,097 pp



Category B *Lisbon Deck* Balcony, 215 sq. ft.

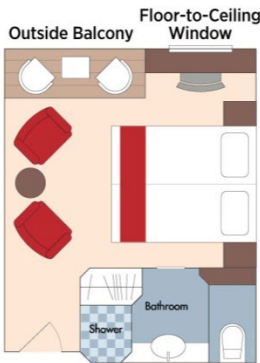

Brochure Fare: ~~\$7,447~~ pp  
Your Rate: \$6,797 pp

Fares listed are cruise-only, per person based on double occupancy AND INCLUDE port charges of \$250 per person.



Category C *Porto Deck* French Balcony, 161 sq. ft.

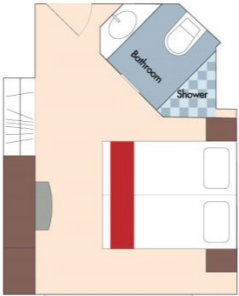

Brochure Fare: \$6,747 pp  
Your Rate: \$6,097 pp



Category D *Douro Deck* Panoramic Window, 161 sq. ft.



Category E *Douro Deck* Panoramic Window, 161 sq. ft.

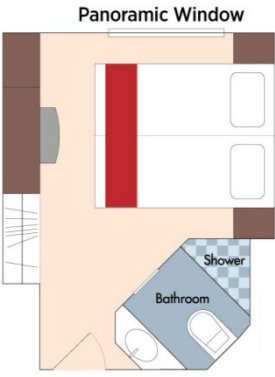

Category D  
Brochure Fare: ~~\$5,597~~ pp  
Your Rate: \$4,947 pp

Category E  
Brochure Fare: ~~\$5,248~~ pp  
Your Rate: \$4,598 pp

DECK PLAN

1	Main Lounge
2	Reception
3	Elevator
4	Main Restaurant
5	Fitness Room
6	Spa

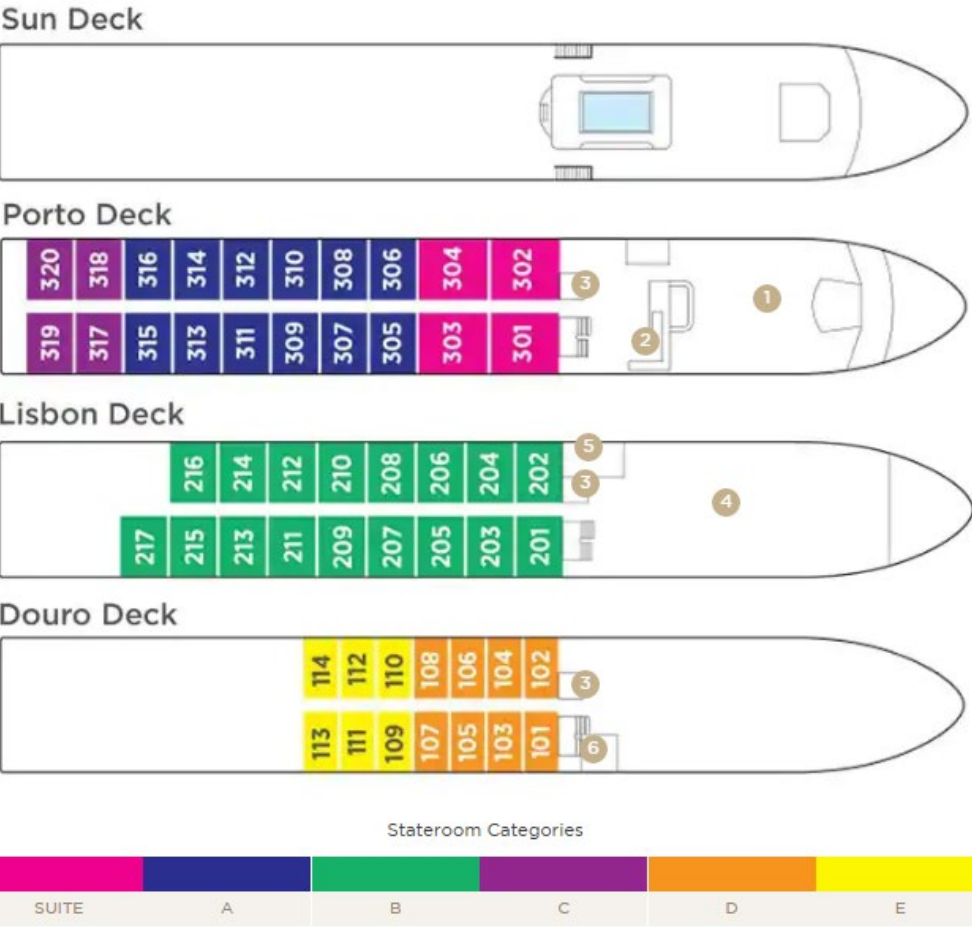

Fares listed are cruise-only, per person based on double occupancy AND INCLUDE port charges of \$250 per person.