

SAVOR A WINE CRUISE THROUGH FRANCE WITH SAMSARA WINE COMPANY

Aboard AmaKristina • 7 Nights • April 23 to 30, 2026
Lyon • Vienne • Tournon • Viviers • Avignon • Arles

Note: Stateroom layouts shown below are not to scale.

Suite *Violin Deck*

French Balcony & Outside Balcony, 350 sq. ft. Wine Cruise Rate = \$9,247 pp

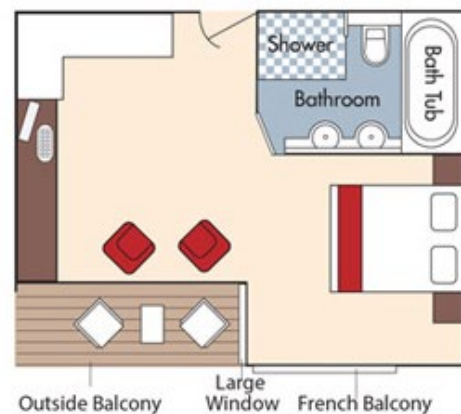

Category AA *Violin Deck*

French Balcony & Outside Balcony, 235 sq. ft. Wine Cruise Rate = \$7,947 pp

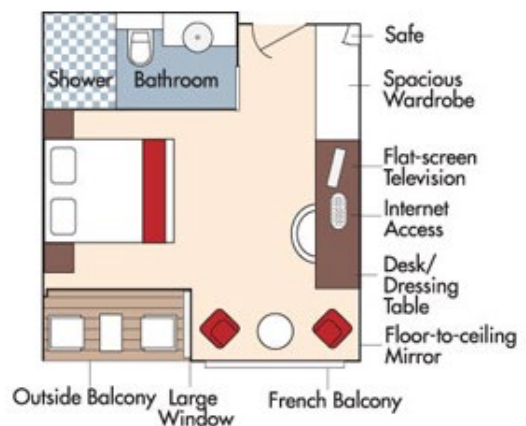

Fares listed are cruise-only, per person based on double occupancy and INCLUDE port charges of \$250 per person and include the exclusive wine package.

Category AB *Cello Deck*

French Balcony & Outside Balcony, 235 sq. ft. Wine Cruise Rate = \$7,747 pp

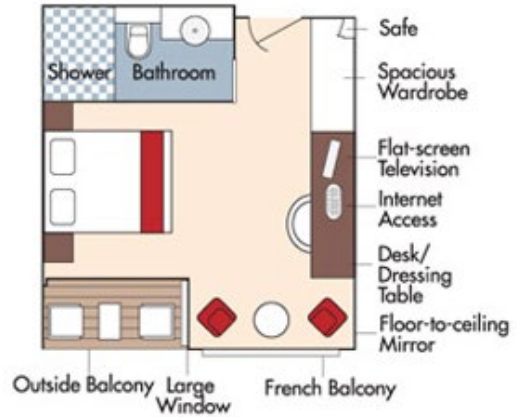

Category BA *Violin Deck*

French Balcony & Outside Balcony, 210 sq. ft. Wine Cruise Rate = \$7,547 pp

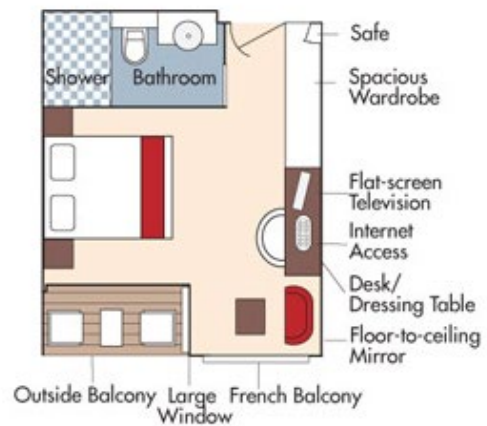

CAT. BB, Cello Deck

Category BB *Cello Deck*

French Balcony & Outside Balcony, 210 sq. ft.



Wine Cruise Rate \$7,347 pp

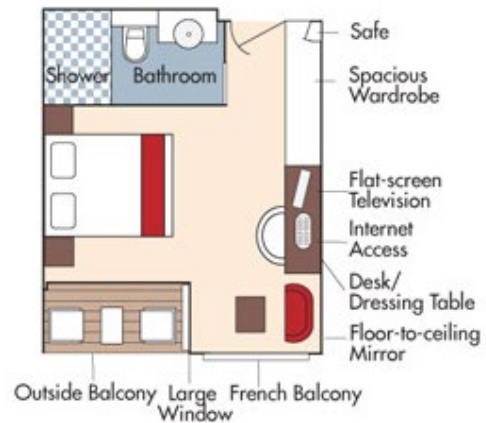

Category CA *Violin & Cello Deck*

French Balcony, 170 sq. ft.



Wine Cruise Rate = \$6,747 pp

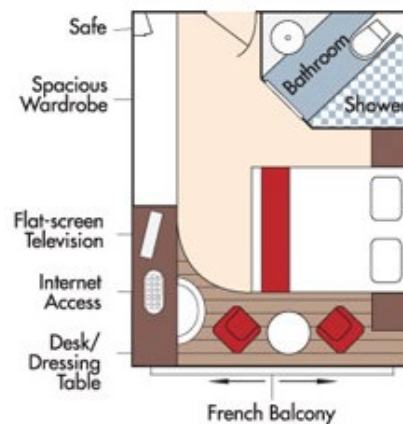

Category CB *Violin Deck*

French Balcony, 155 sq. ft.



Wine Cruise Rate = \$6,347 pp

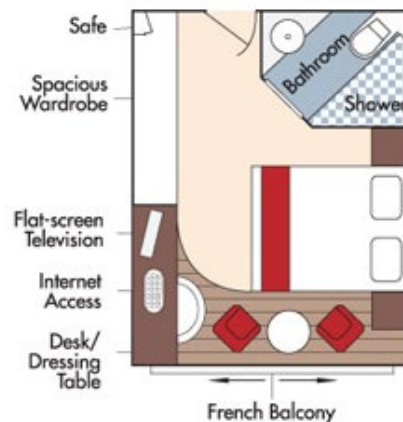

Fares listed are cruise-only, per person based on double occupancy and INCLUDE port charges of \$250 per person and include the exclusive wine package.

Category D *Piano Deck*
Fixed Windows, 160 sq. ft.



Wine Cruise Rate = \$5,547 pp

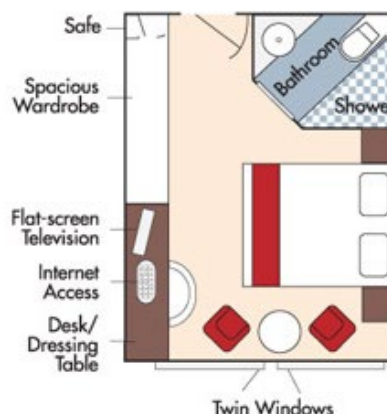

Category E *Piano Deck*
Fixed Windows, 160 sq. ft.

Wine Cruise Rate = \$5,248 pp

AmaKristina
DECK PLAN

1	Lower Sun Deck
2	Navigation Bridge
3	Bicycles
4	Heated Pool
5	Sun Deck
6	Walking Track
7	Al Fresco Terrace
8	Observation Lounge
9	Main Lounge & Bar
10	Gift Shop
11	Reception
12	The Chef's Table Restaurant
13	Main Restaurant
14	Elevator
15	Massage & Hair Salon
16	Fitness Room
17	Crew Cabins

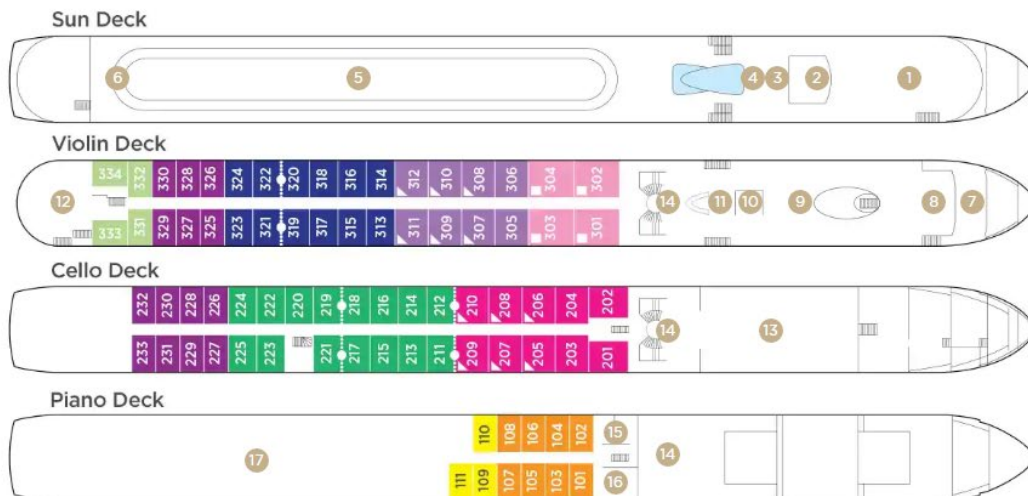

Note: Elevator reaches the Violin, Cello and Piano Deck (does not reach the Sun Deck).

Staterooms can become adjoining by request.

Up to triple occupancy

Stateroom Categories

SUITE	AA	AB	BA	BB	CA	CB	D	E
-------	----	----	----	----	----	----	---	---

Fares listed are cruise-only, per person based on double occupancy and INCLUDE port charges of \$250 per person and include the exclusive wine package.