

SAVOR A WINE CRUISE THROUGH BORDEAUX WITH MOUNT EDEN VINEYARDS & RIDGE VINEYARDS AND THE WINES OF THE SANTA CRUZ MOUNTAINS

AmaDolce • May 21 – 28, 2026

Bordeaux • Libourne • Blaye • Bourg • Cussac-Fort-Medoc • Cadillac • Bordeaux



Suite, Violin Deck
French Balcony, 255 sq. ft.

Note: Stateroom layouts shown below are not to scale.



Wine Cruise Rate: \$8,647 pp



CAT. A+, Violin Deck
French Balcony, 225 sq. ft.

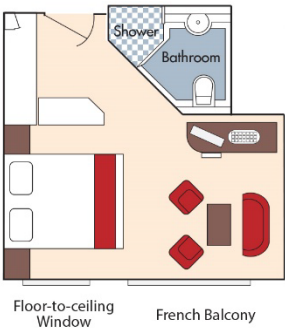

Wine Cruise Rate: \$8,347 pp



CAT. A, Violin Deck
French Balcony, 170 sq. ft.

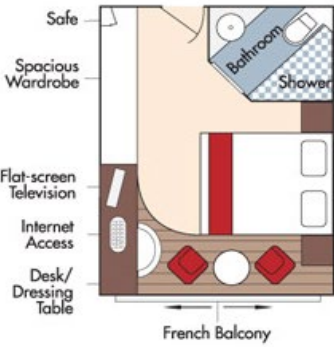

Wine Cruise Rate: \$7,347 pp

Fares listed are cruise-only, per person based on double occupancy AND INCLUDE port charges of \$250 per person.

CAT. B, Violin & Cello Deck
French Balcony, 170 sq. ft.

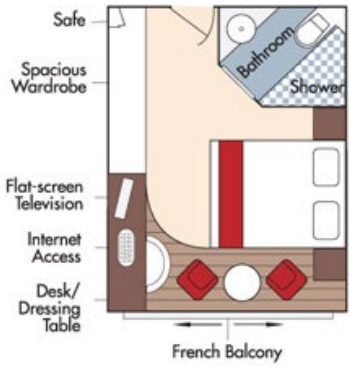

Wine Cruise Rate: \$7,247 pp

CAT. C, Violin & Cello Deck
French Balcony, 170 sq. ft.

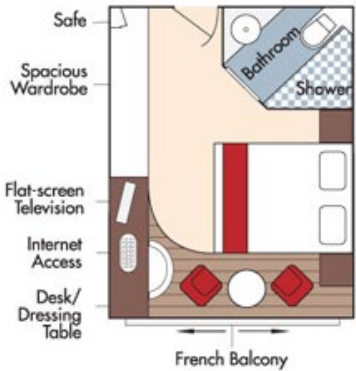

Wine Cruise Rate: \$6,947 pp

CAT. E, Piano Deck
Fixed Windows, 170 sq. ft.



CAT. D, Piano Deck
Fixed Windows, 170 sq. ft.

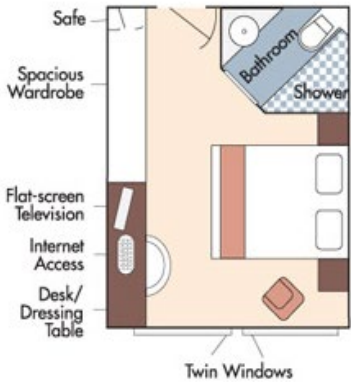

Category D
Wine Cruise Rate: \$5,747 pp

Category E
Wine Cruise Rate: \$5,448 pp

AmaDolce Deck Plan

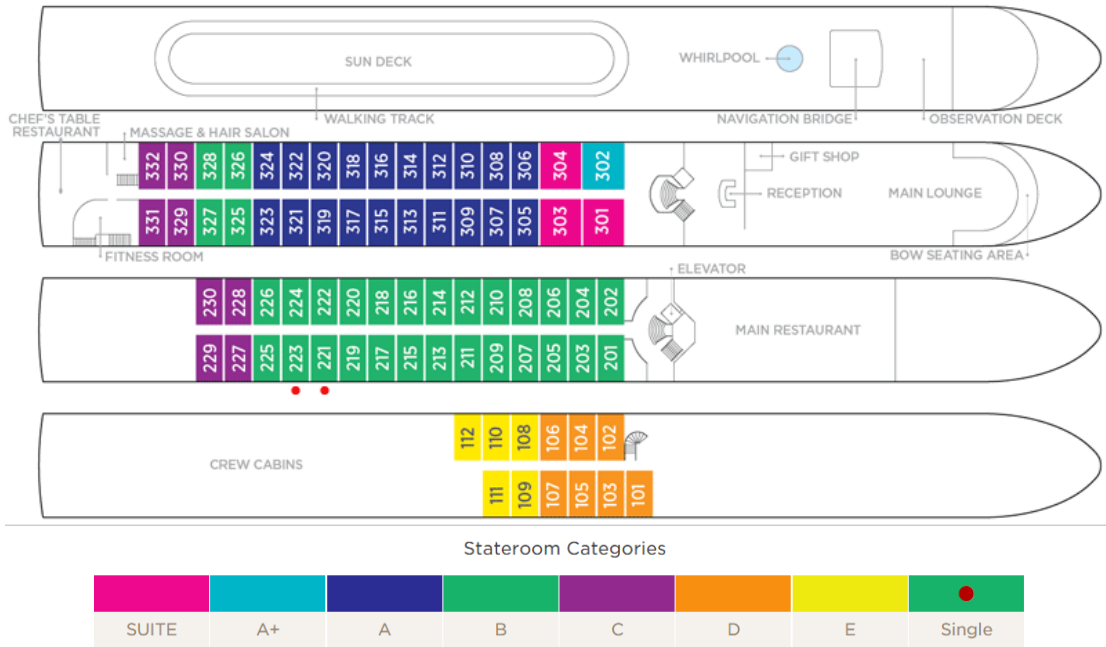

Fares listed are cruise-only, per person based on double occupancy AND INCLUDE port charges of \$250 per person.