

EXPLORE THE ENTICING DOURO WITH BLUE FARM AND MUSCARDINI CELLARS

Aboard AmaDouro • 7 Nights • June 23 to 30, 2026

Book by September 30, 2025
and SAVE up to \$450 per person!

Note: Stateroom layouts shown below are not to scale.



Suite *Porto Deck* Balcony, 323 sq. ft.

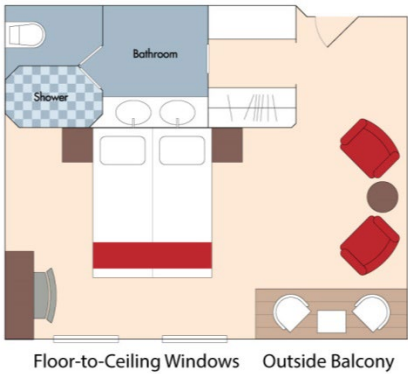

Brochure Fare: ~~\$9,147~~ pp
Your Rate: \$8,697 pp



Category A *Porto Deck* Balcony, 215 sq. ft.

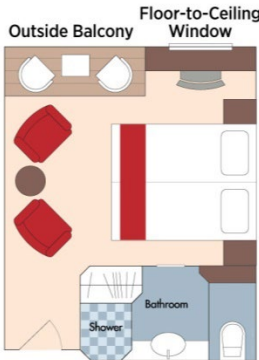

Brochure Fare: ~~\$7,647~~ pp
Your Rate: \$7,247 pp



Category B *Lisbon Deck* Balcony, 215 sq. ft.

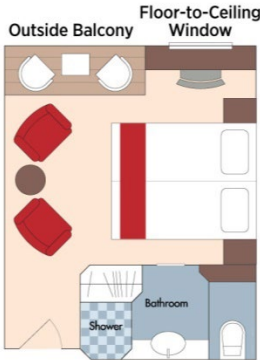

Brochure Fare: ~~\$7,347~~ pp
Your Rate: \$6,997 pp

Fares listed are cruise-only, per person based on double occupancy AND INCLUDE port charges of \$250 per person.



Category C *Porto Deck* French Balcony, 161 sq. ft.

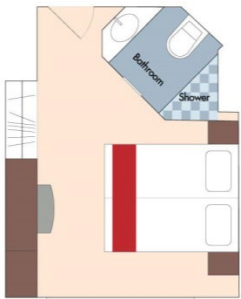

Brochure Fare: ~~\$6,647~~ pp
Your Rate: \$6,297 pp



Category D *Douro Deck* Panoramic Window, 161 sq. ft.



Category E *Douro Deck* Panoramic Window, 161 sq. ft.

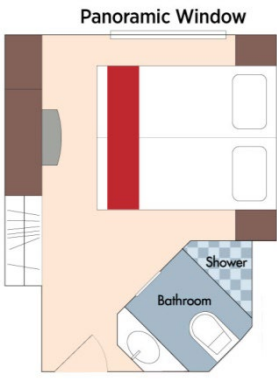

Category D
Brochure Fare: ~~\$5,497~~ pp
Your Rate: \$5,197 pp

Category E
Brochure Fare: ~~\$5,148~~ pp
Your Rate: \$4,898 pp

DECK PLAN

1	Main Lounge
2	Reception
3	Elevator
4	Main Restaurant
5	Fitness Room
6	Spa

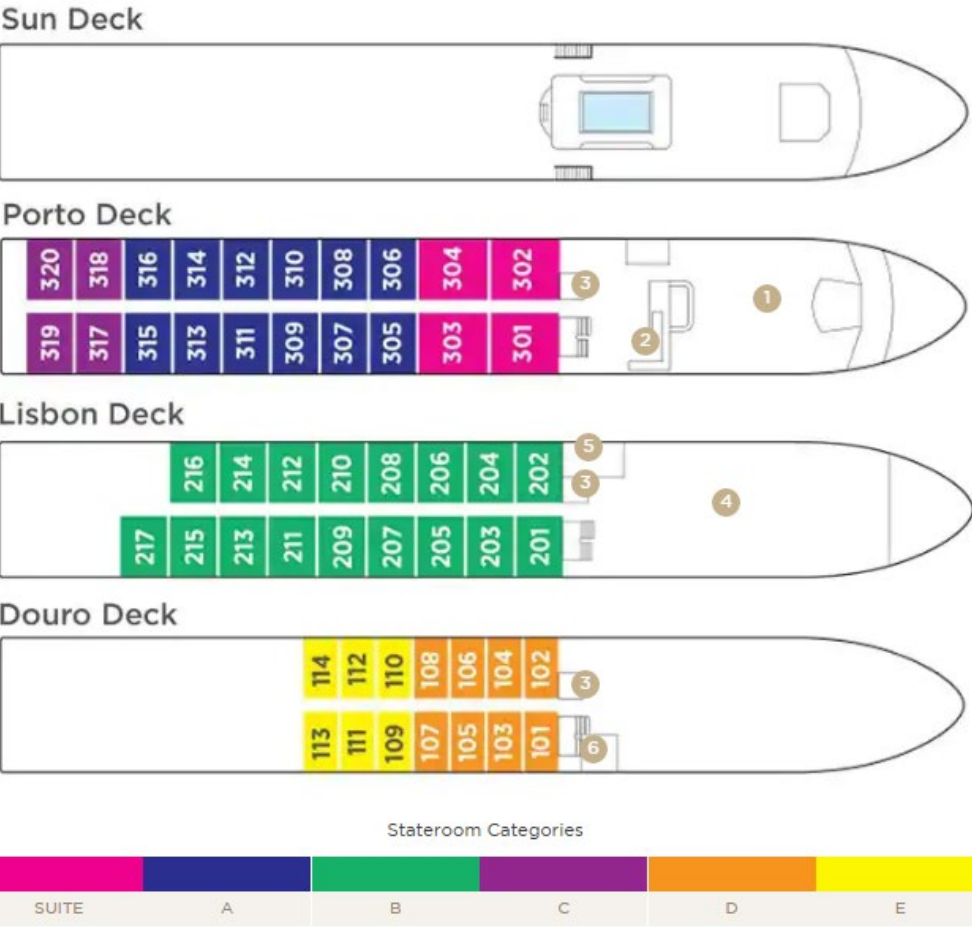

Fares listed are cruise-only, per person based on double occupancy AND INCLUDE port charges of \$250 per person.