

WINE & BOURBON CRUISE THROUGH BORDEAUX WITH SCOTT HARPER, MS

AmaDolce • October 2 – 9, 2025

Bordeaux • Libourne • Blaye • Bourg • Cussac-Fort-Medoc • Cadillac • Bordeaux

Special Rates when you book
by August 31, 2025



Suite, Violin Deck
French Balcony, 255 sq. ft.

Note: Stateroom layouts shown below are not to scale.



Wine Cruise Rate: \$8,428 pp



CAT. A+, Violin Deck
French Balcony, 225 sq. ft.

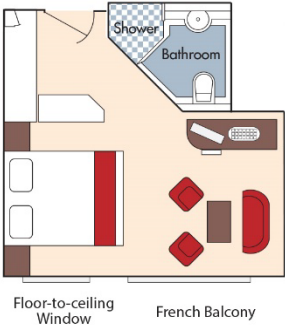

Wine Cruise Rate: \$8,128 pp



CAT. A, Violin Deck
French Balcony, 170 sq. ft.

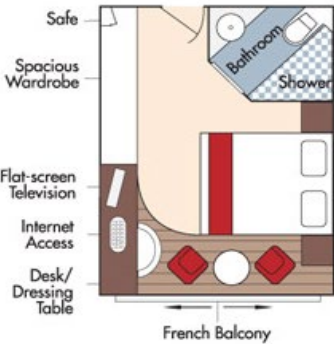

Wine Cruise Rate: \$7,128 pp

Fares listed are cruise-only, per person based on double occupancy AND INCLUDE port charges of \$231 per person.

CAT. B, Violin & Cello Deck
French Balcony, 170 sq. ft.

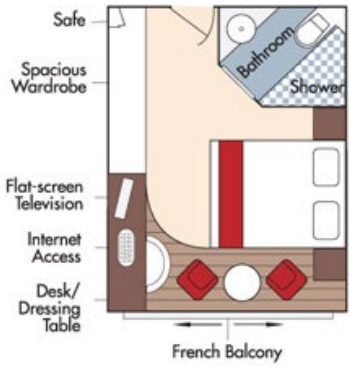

Wine Cruise Rate: \$7,028 pp

CAT. C, Violin & Cello Deck
French Balcony, 170 sq. ft.

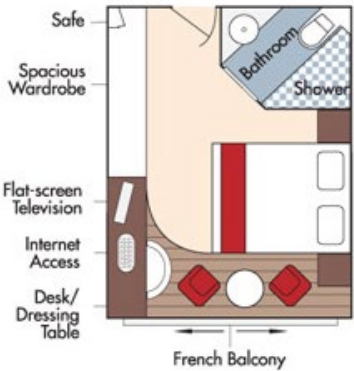

Wine Cruise Rate: \$6,728 pp

CAT. E, Piano Deck
Fixed Windows, 170 sq. ft.



CAT. D, Piano Deck
Fixed Windows, 170 sq. ft.

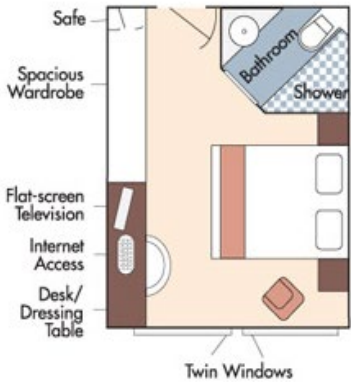

Category D
Wine Cruise Rate: \$5,628 pp
Category E
Wine Cruise Rate: \$5,329 pp

AmaDolce Deck Plan

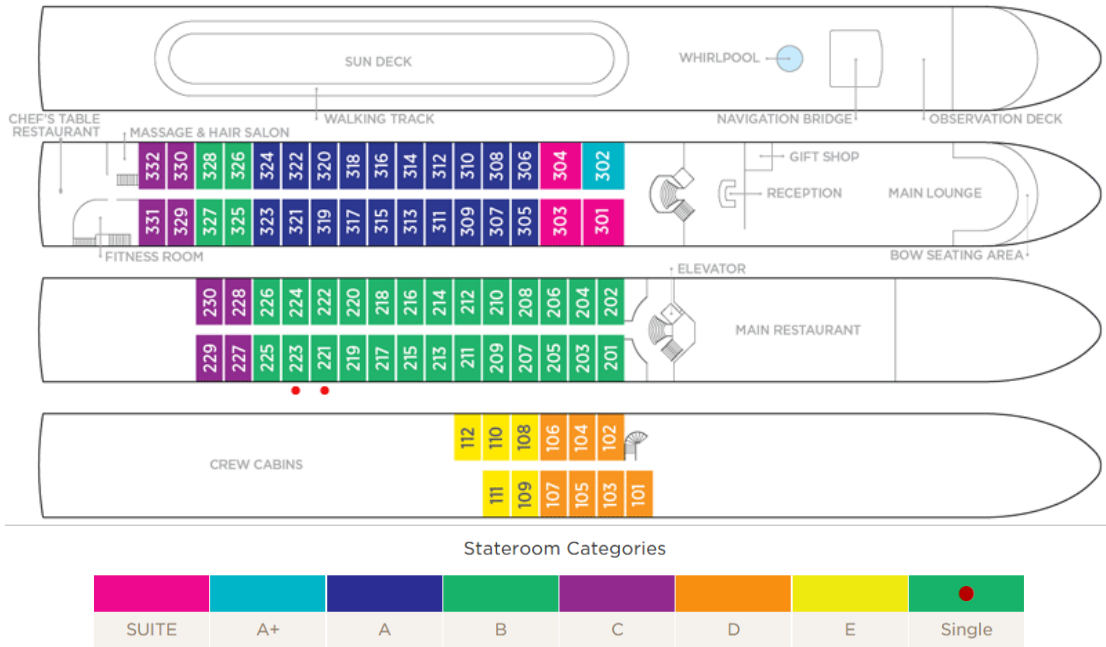

Fares listed are cruise-only, per person based on double occupancy AND INCLUDE port charges of \$231 per person.