

# SAVOR A WINE CRUISE THROUGH BORDEAUX WITH MOUNT EDEN VINEYARDS & RIDGE VINEYARDS AND THE WINES OF THE SANTA CRUZ MOUNTAINS

**AmaDolce • May 21 – 28, 2026**

**Bordeaux • Libourne • Blaye • Bourg • Cussac-Fort-Medoc • Cadillac • Bordeaux**

**Special Rates when you book  
by June 30, 2025**



Suite, Violin Deck  
French Balcony, 255 sq. ft.

*Note: Stateroom layouts shown below are not to scale.*



Brochure Rate: ~~\$8,647 pp~~

Wine Cruise Rate: \$8,247 pp



CAT. A+, Violin Deck  
French Balcony, 225 sq. ft.

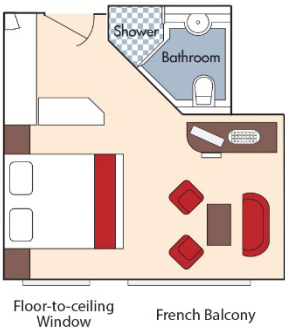

Brochure Rate: ~~\$8,347 pp~~

Wine Cruise Rate: \$7,947 pp



CAT. A, Violin Deck  
French Balcony, 170 sq. ft.

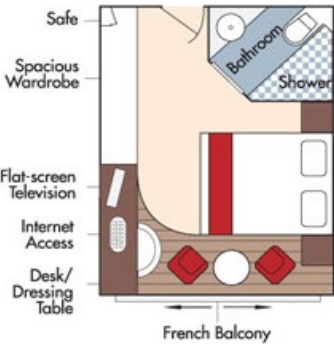

Brochure Rate: ~~\$7,347 pp~~

Wine Cruise Rate: \$6,997 pp

*Fares listed are cruise-only, per person based on double occupancy AND INCLUDE port charges of \$250 per person.*

CAT. B, Violin & Cello Deck  
French Balcony, 170 sq. ft.

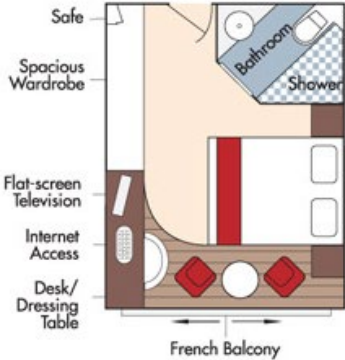

Brochure Rate: ~~\$7,247 pp~~

Wine Cruise Rate: \$6,898 pp

CAT. C, Violin & Cello Deck  
French Balcony, 170 sq. ft.

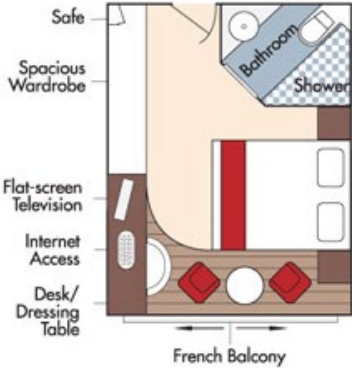

Brochure Rate: ~~\$6,947 pp~~

Wine Cruise Rate: \$6,597 pp

CAT. E, Piano Deck  
Fixed Windows, 170 sq. ft.



CAT. D, Piano Deck  
Fixed Windows, 170 sq. ft.

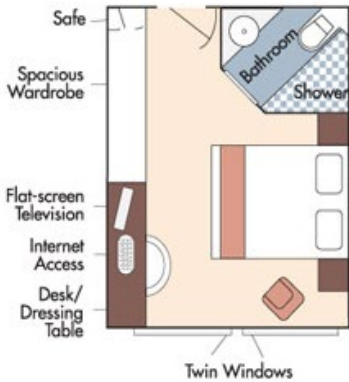

Category D

Brochure Rate: ~~\$5,747 pp~~

Wine Cruise Rate: \$5,497 pp

Category E

Brochure Rate: ~~\$5,448 pp~~

Wine Cruise Rate: \$5,198 pp

AmaDolce Deck Plan

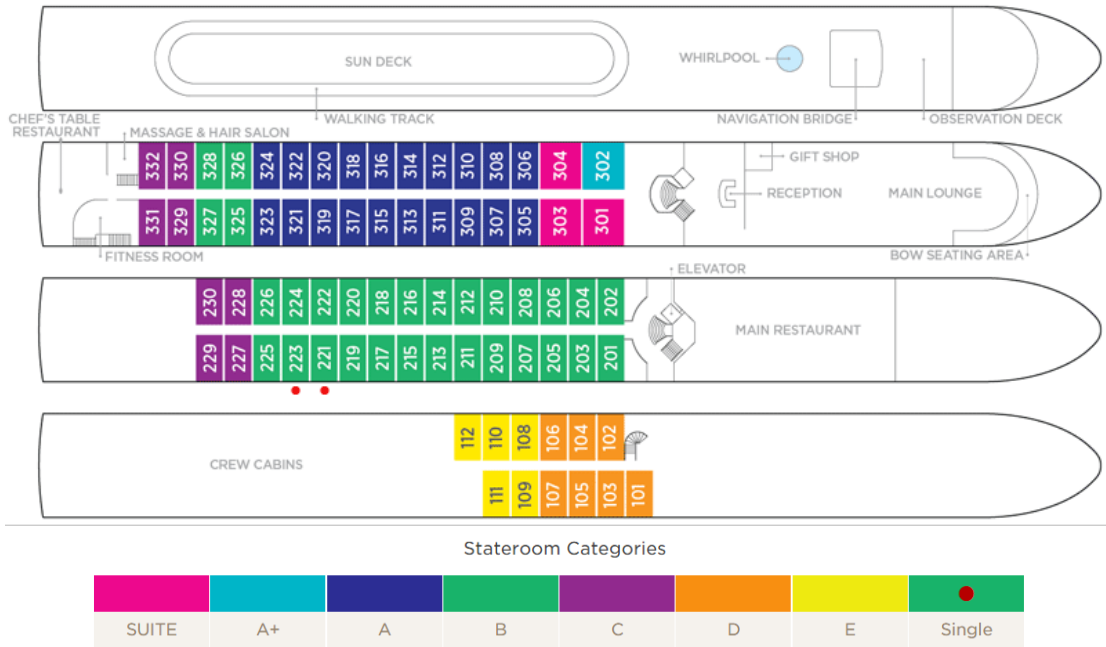

Fares listed are cruise-only, per person based on double occupancy AND INCLUDE port charges of \$250 per person.