

UNCORK THE HISTORY, WINE & CULTURE OF PORTUGAL

Aboard AmaSintra • 7 Nights • July 24 to 31, 2026

**Book by July 31, 2025
and SAVE \$650 per person!**

Note: Stateroom layouts shown below are not to scale.

Suite *Porto Deck* Balcony, 323 sq. ft.

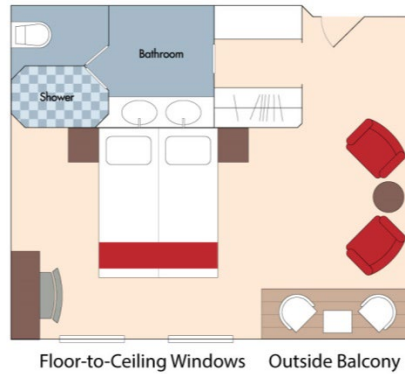

Brochure Fare: ~~\$9,247~~ pp
Your Rate: **\$8,597** pp

Category A *Porto Deck* Balcony, 215 sq. ft.

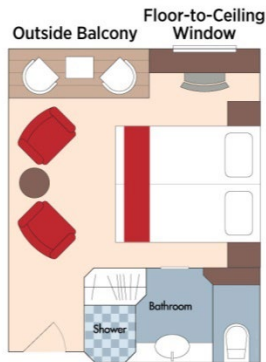

Brochure Fare: ~~\$7,747~~ pp
Your Rate: **\$7,097** pp

Category B *Lisbon Deck* Balcony, 215 sq. ft.

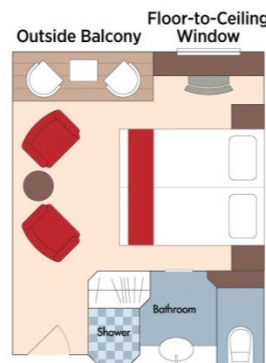

Brochure Fare: ~~\$7,447~~ pp
Your Rate: **\$6,797** pp

Category C *Porto Deck* French Balcony, 161 sq. ft.

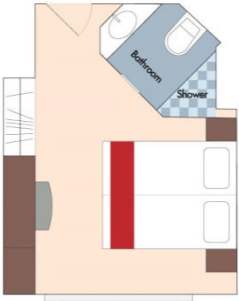

French Balcony

Brochure Fare: \$6,747 pp
Your Rate: \$6,097 pp

Category D *Douro Deck* Panoramic Window, 161 sq. ft.

Category E *Douro Deck* Panoramic Window, 161 sq. ft.



Category D
Brochure Fare: \$5,597 pp
Your Rate: \$4,947 pp

Category E
Brochure Fare: \$5,248 pp
Your Rate: \$4,598 pp

DECK PLAN

1	Main Lounge
2	Reception
3	Elevator
4	Main Restaurant
5	Fitness Room
6	Spa

Sun Deck



Porto Deck

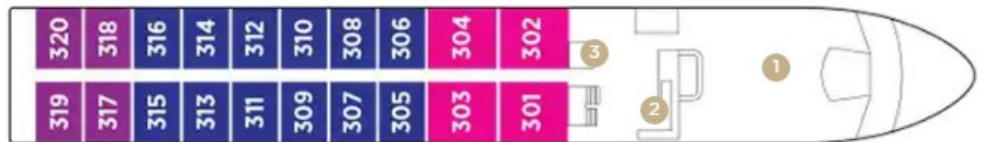

Lisbon Deck



Douro Deck



Stateroom Categories



Fares listed are cruise-only, per person based on double occupancy AND INCLUDE port charges of \$250 per person.