



**Special Rates when you book  
by June 30, 2025!**

# RIVER CRUISE FOR WINE LOVERS

## Mill Creek Vineyards & Winery

Aboard AmaKristina • 7 Nights • July 31 to August 7, 2025  
Lyon to Arles

*Note: Stateroom layouts shown below are not to scale.*



### Suite *Violin Deck*

French Balcony & Outside Balcony, 350 sq. ft.

Brochure Fare ~~\$8,729~~ pp

**Wine cruise rate \$8,479 pp**

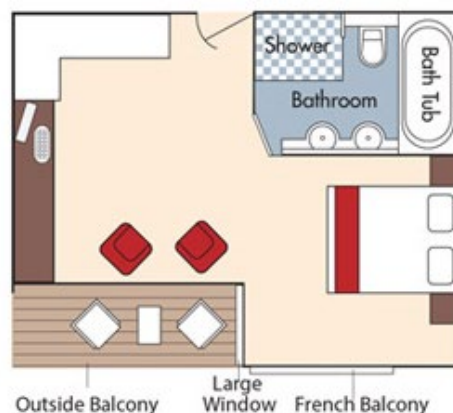

### Category AA *Violin Deck*

French Balcony & Outside Balcony, 235 sq. ft.

Brochure Fare ~~\$7,429~~ pp

**Wine cruise rate \$7,179 pp**

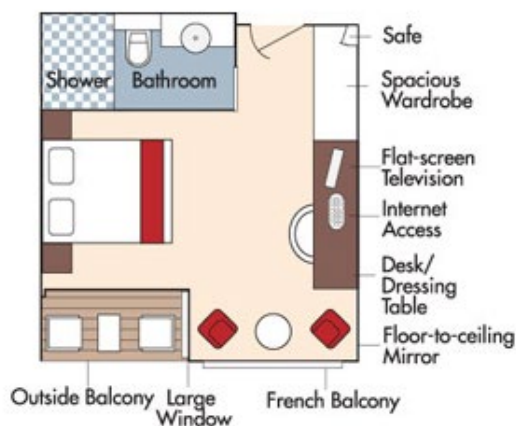

*Fares listed are cruise-only per person based on double occupancy inclusive of port charges of \$231 pp and include the exclusive wine package.*



## Category AB *Cello Deck*

French Balcony & Outside Balcony, 235 sq. ft.

Brochure Fare \$7,229 pp

Wine cruise rate \$6,979 pp

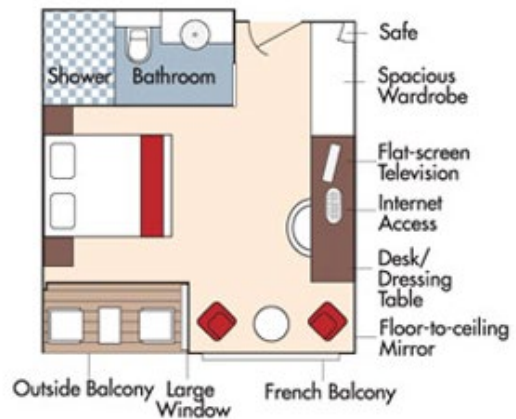

## Category BA *Violin Deck*

French Balcony & Outside Balcony, 210 sq. ft.

Brochure Fare \$7,029 pp

Wine cruise rate \$6,779 pp

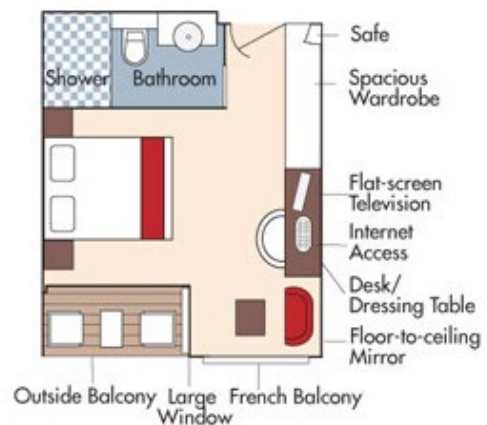



CAT. BB, Cello Deck

## Category BB *Cello Deck*

French Balcony & Outside Balcony, 210 sq. ft.



Brochure Fare \$6,829 pp  
Wine cruise rate \$6,579 pp

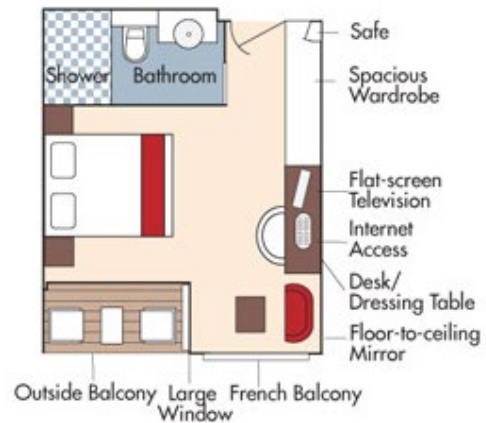

## Category CA *Violin & Cello Deck*

French Balcony, 170 sq. ft.



Brochure Fare \$6,229 pp  
Wine cruise rate \$5,979 pp

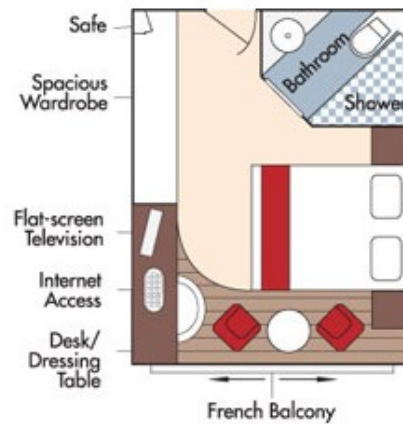

## Category CB *Violin Deck*

French Balcony, 155 sq. ft.



Brochure Fare \$5,829 pp  
Wine cruise rate \$5,579 pp

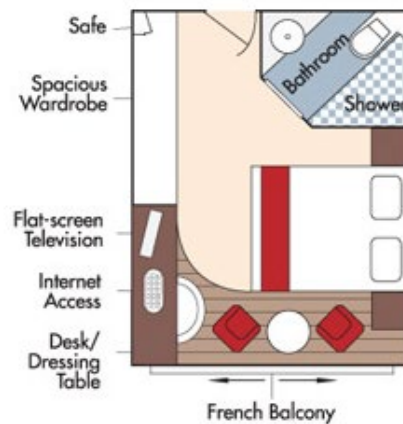

Fares listed are cruise-only per person based on double occupancy inclusive of port charges of \$231 pp and include the exclusive wine package.

**Category D** *Piano Deck*  
Fixed Windows, 160 sq. ft.



Brochure Fare ~~\$5,129~~ pp  
Wine cruise rate \$4,879 pp

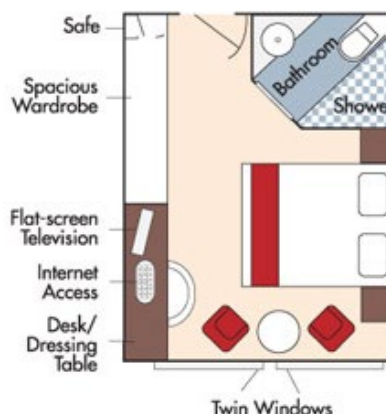

**Category E** *Piano Deck*  
Fixed Windows, 160 sq. ft.

Brochure Fare ~~\$4,830~~ pp  
Wine cruise rate \$4,580 pp

*AmaKristina*  
**DECK PLAN**

1	Lower Sun Deck
2	Navigation Bridge
3	Bicycles
4	Heated Pool
5	Sun Deck
6	Walking Track
7	Al Fresco Terrace
8	Observation Lounge
9	Main Lounge & Bar
10	Gift Shop
11	Reception
12	The Chef's Table Restaurant
13	Main Restaurant
14	Elevator
15	Massage & Hair Salon
16	Fitness Room
17	Crew Cabins

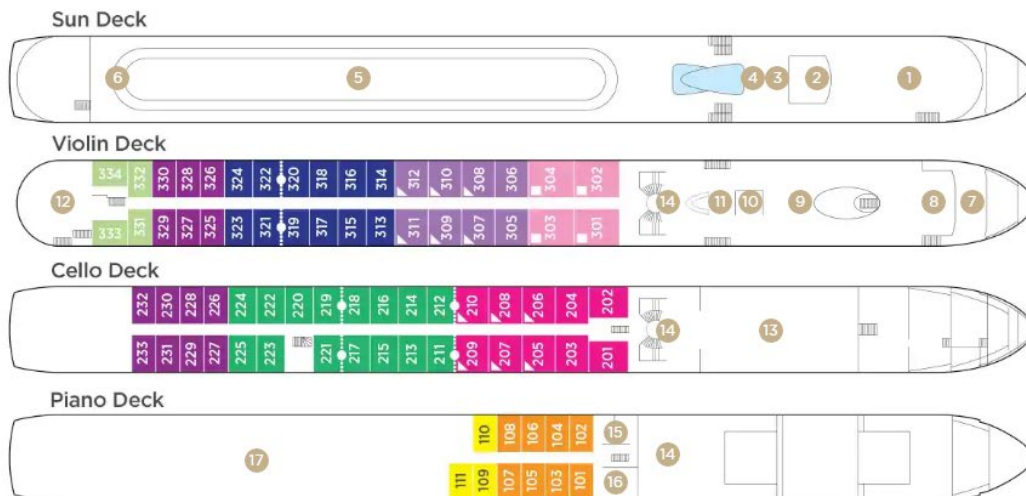

Note: Elevator reaches the Violin, Cello and Piano Deck (does not reach the Sun Deck).

Staterooms can become adjoining by request.

Up to triple occupancy

Stateroom Categories

SUITE	AA	AB	BA	BB	CA	CB	D	E
-------	----	----	----	----	----	----	---	---

Fares listed are cruise-only per person based on double occupancy inclusive of port charges of \$231 pp and include the exclusive wine package.