

# SAVOR A WINE CRUISE THROUGH FRANCE WITH SAMSARA WINE COMPANY

Aboard AmaKristina • 7 Nights • April 23 to 30, 2026  
Lyon • Vienne • Tournon • Viviers • Avignon • Arles

*Note: Stateroom layouts shown below are not to scale.*

**Book by April 30, 2025  
for this Special Pricing!**

**Suite** *Violin Deck*  
French Balcony & Outside Balcony, 350 sq. ft.

Brochure Rate = ~~\$9,247~~ pp  
Wine Cruise Rate = **\$8,797** pp

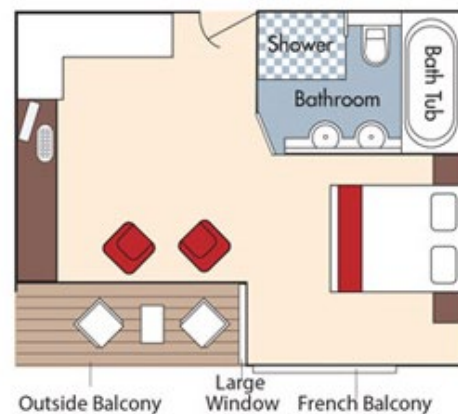
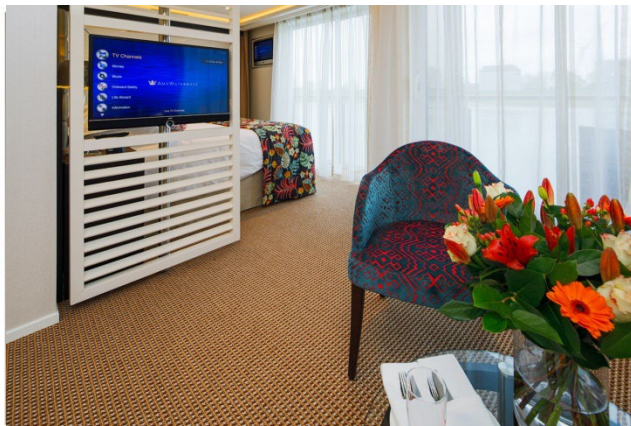

**Category AA** *Violin Deck*  
French Balcony & Outside Balcony, 235 sq. ft.

Brochure Rate = ~~\$7,947~~ pp  
Wine Cruise Rate = **\$7,547** pp

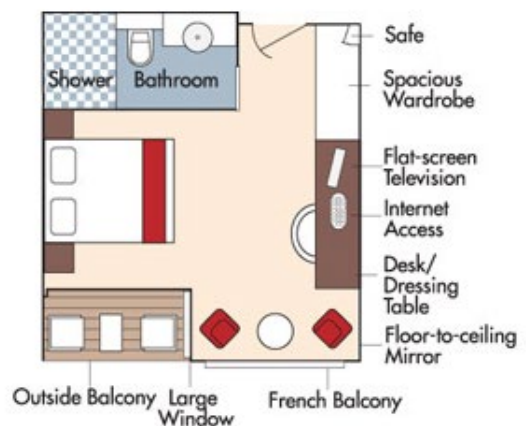



### Category AB *Cello Deck*

French Balcony & Outside Balcony, 235 sq. ft.

Brochure Rate = ~~\$7,747~~ pp

Wine Cruise Rate = \$7,347 pp

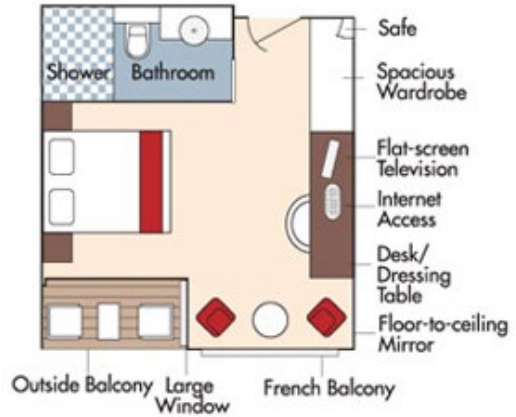

### Category BA *Violin Deck*

French Balcony & Outside Balcony, 210 sq. ft.

Brochure Rate = ~~\$7,547~~ pp

Wine Cruise Rate = \$7,147 pp

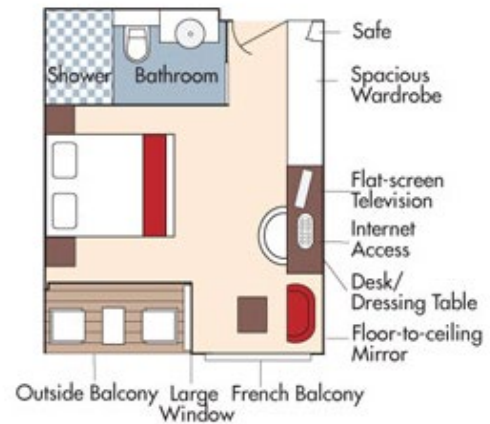



CAT. BB, Cello Deck

### Category BB *Cello Deck*

French Balcony & Outside Balcony, 210 sq. ft.

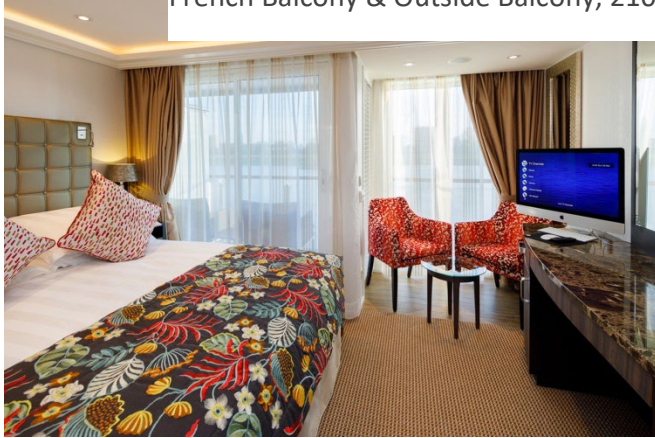

Brochure Rate = ~~\$7,347~~ pp  
Wine Cruise Rate \$6,947 pp

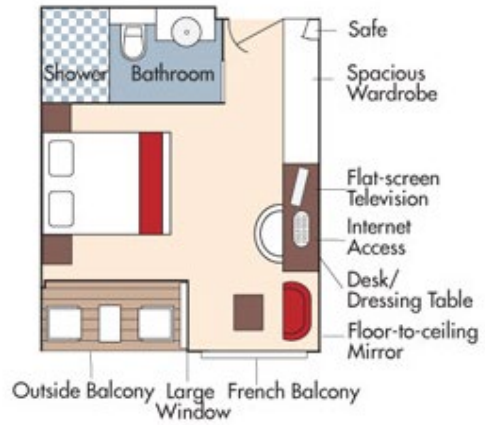

### Category CA *Violin & Cello Deck*

French Balcony, 170 sq. ft.



Brochure Rate = ~~\$6,747~~ pp  
Wine Cruise Rate = \$6,447 pp

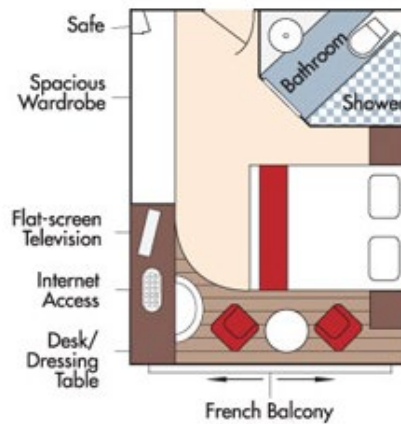

### Category CB *Violin Deck*

French Balcony, 155 sq. ft.



Brochure Rate = ~~\$6,347~~ pp  
Wine Cruise Rate = \$6,047 pp

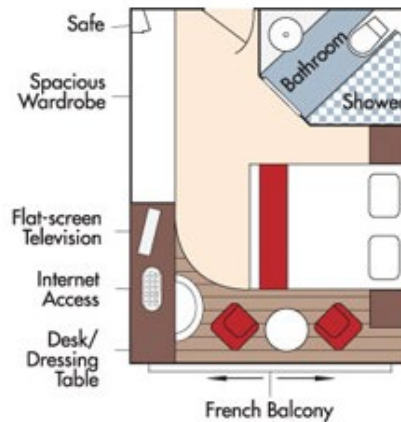

**Category D** *Piano Deck*  
Fixed Windows, 160 sq. ft.



Brochure Rate = \$5,547 pp  
Wine Cruise Rate = \$5,297 pp

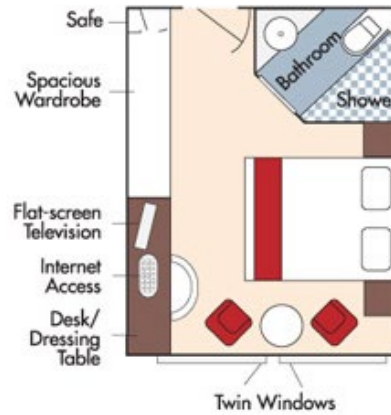

**Category E** *Piano Deck*  
Fixed Windows, 160 sq. ft.

Brochure Rate = \$5,248 pp  
Wine Cruise Rate = \$4,998 pp

## AmaKristina DECK PLAN

1	Lower Sun Deck
2	Navigation Bridge
3	Bicycles
4	Heated Pool
5	Sun Deck
6	Walking Track
7	Al Fresco Terrace
8	Observation Lounge
9	Main Lounge & Bar
10	Gift Shop
11	Reception
12	The Chef's Table Restaurant
13	Main Restaurant
14	Elevator
15	Massage & Hair Salon
16	Fitness Room
17	Crew Cabins

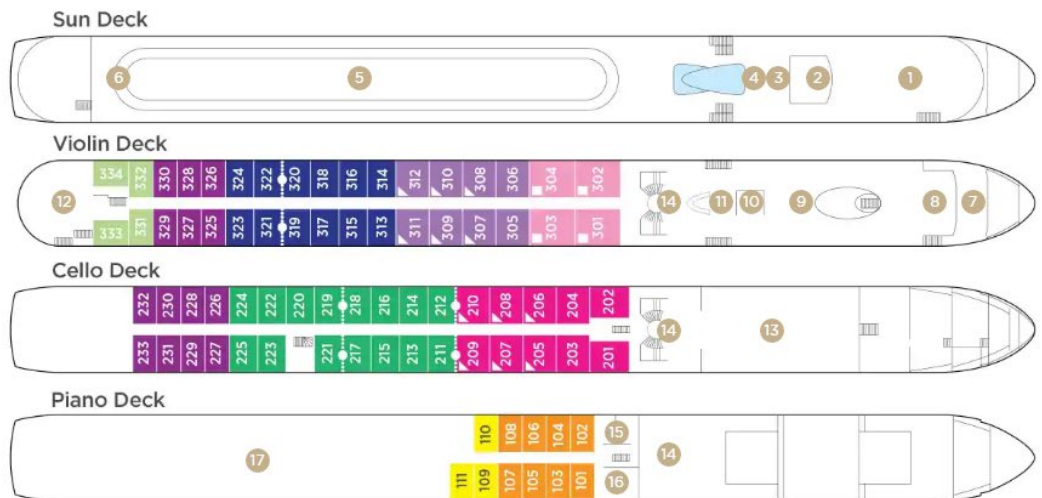

Note: Elevator reaches the Violin, Cello and Piano Deck (does not reach the Sun Deck).

Staterooms can become adjoining by request.

Up to triple occupancy

Stateroom Categories



Fares listed are cruise-only, per person based on double occupancy and INCLUDE port charges of \$250 per person and include the exclusive wine package.