

# EXPLORE THE ENTICING DOURO WITH BLUE FARM AND MUSCARDINI CELLARS

Aboard AmaDouro • 7 Nights • June 23 to 30, 2026

**Book by May 31, 2025  
and SAVE up to \$450 per person!**

Note: Stateroom layouts shown below are not to scale.

## Suite *Porto Deck* Balcony, 323 sq. ft.

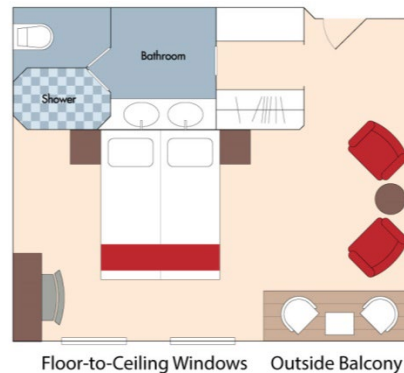

Brochure Fare: ~~\$9,147~~ pp  
Your Rate: \$8,697 pp

## Category A *Porto Deck* Balcony, 215 sq. ft.

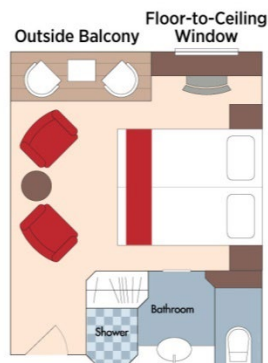

Brochure Fare: ~~\$7,647~~ pp  
Your Rate: \$7,247 pp

## Category B *Lisbon Deck* Balcony, 215 sq. ft.

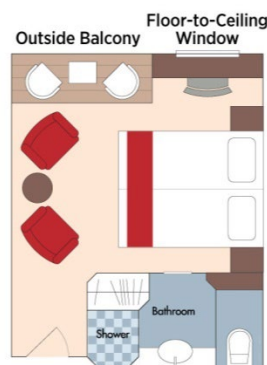

Brochure Fare: ~~\$7,347~~ pp  
Your Rate: \$6,997 pp

**Category C *Porto Deck*** French Balcony, 161 sq. ft.

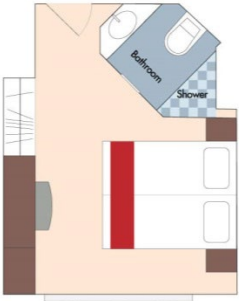

French Balcony

Brochure Fare: \$6,647 pp  
Your Rate: \$6,297 pp

**Category D *Douro Deck*** Panoramic Window, 161 sq. ft.

**Category E *Douro Deck*** Panoramic Window, 161 sq. ft.



Category D  
Brochure Fare: \$5,497 pp  
Your Rate: \$5,197 pp

Category E  
Brochure Fare: \$5,148 pp  
Your Rate: \$4,898 pp

## DECK PLAN

1	Main Lounge
2	Reception
3	Elevator
4	Main Restaurant
5	Fitness Room
6	Spa

### Sun Deck



### Porto Deck

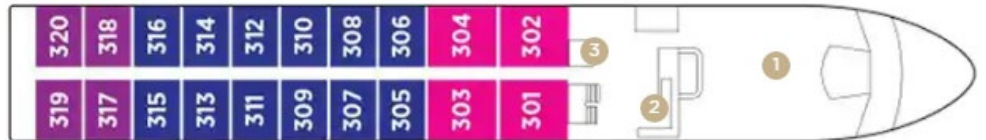

### Lisbon Deck



### Douro Deck



Stateroom Categories



Fares listed are cruise-only, per person based on double occupancy AND INCLUDE port charges of \$250 per person.