



Special Rates when you book by May 31, 2025

RIVER CRUISE FOR WINE LOVERS

Highland Valley Vineyards

Aboard AmaPrima • 7 Nights • March 18 – 25, 2026
Amsterdam to Basel

Note: Stateroom layouts shown below are not to scale.



Suite, Violin Deck
French Balcony & Outside Balcony, 300 sq. ft.

Brochure Fare \$7,548 pp
Your rate \$7,048 pp

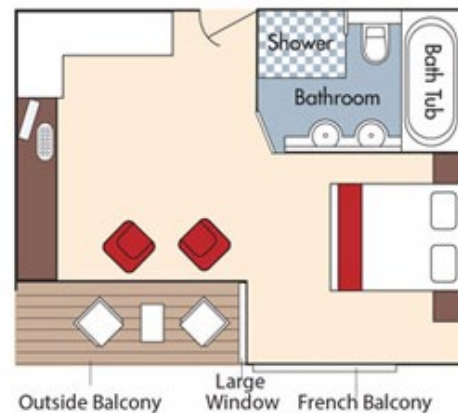

CAT. AA, Violin Deck
French Balcony & Outside Balcony, 235 sq. ft.

Brochure Fare \$6,248 pp
Your rate \$5,748 pp

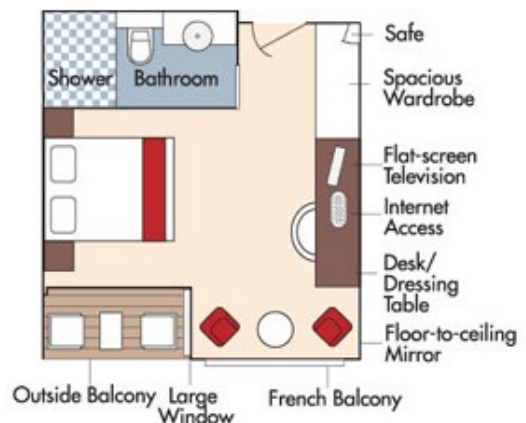

Fares listed are cruise-only, per person based on double occupancy and INCLUDES port charges of \$250 per person.



CAT. AB, Cello Deck
French Balcony & Outside Balcony, 235 sq. ft.

Brochure Fare \$6,048 pp
 Your rate \$5,548 pp

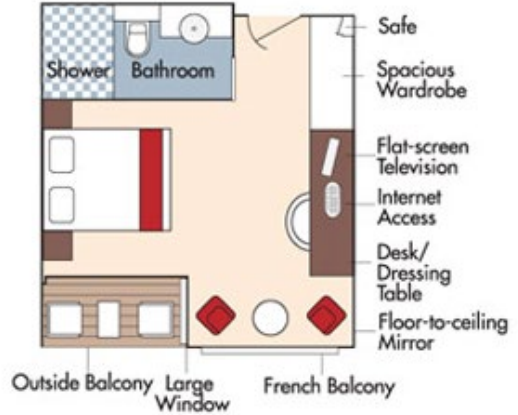

CAT. BA, Violin Deck
French Balcony & Outside Balcony, 210 sq. ft.

Brochure Fare \$5,848 pp
 Your rate \$5,348 pp

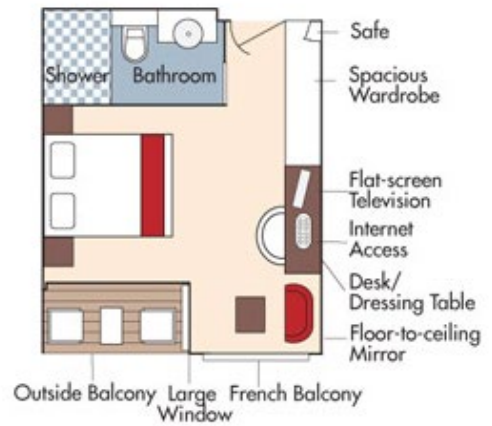



CAT. BB, Cello Deck
French Balcony & Outside Balcony, 210 sq. ft.

Brochure Fare ~~\$5,648~~ pp
 Your rate **\$5,148** pp

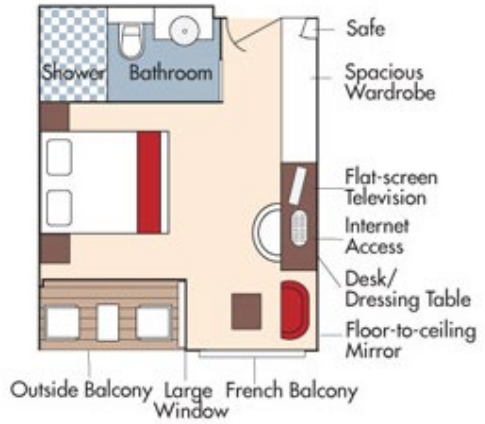

CAT. C, Violin & Cello Deck
French Balcony, 170 sq. ft.

Category C
 Brochure Fare ~~\$5,048~~ pp
 Your rate **\$4,548** pp

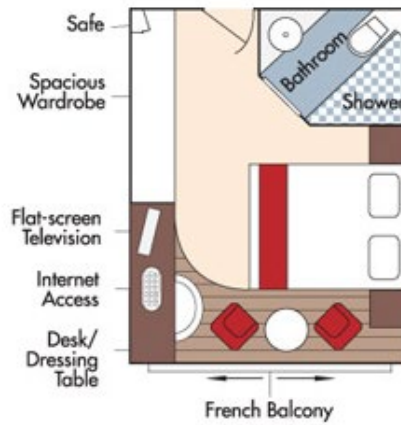



CAT. D, Piano Deck
Fixed Windows, 160 sq. ft.

Brochure Fare ~~\$3,848~~ pp
Your rate **\$3,348** pp

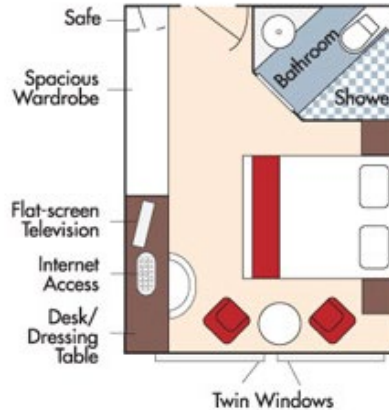

CAT. E, Piano Deck
Fixed Windows, 160 sq. ft.

Brochure Fare ~~\$3,549~~ pp
Your rate **\$3,049** pp

AmaPrima DECK PLAN

1	Lower Sun Deck
2	Navigation Bridge
3	Bicycles
4	Heated Pool
5	Sun Deck
6	Walking Track
7	Al Fresco Dining Terrace
8	Observation Lounge
9	Main Lounge & Bar
10	Gift Shop
11	Reception
12	Fitness Room
13	Massage & Hair Salon
14	The Chef's Table Restaurant
15	Main Restaurant
16	Elevator
17	Crew Cabins

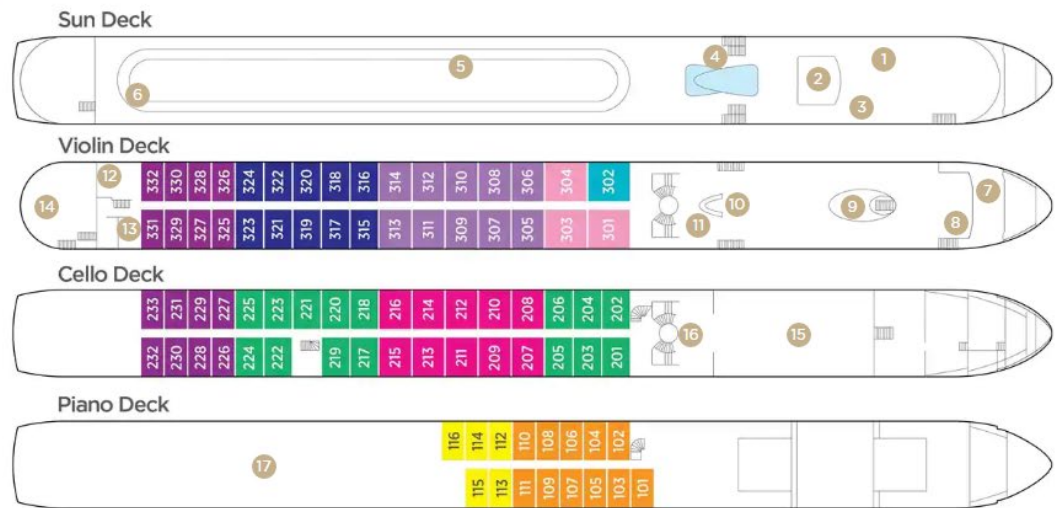

Note: Elevator reaches the Violin and Cello Deck (does not reach Piano Deck or Sun Deck).

Stateroom Categories

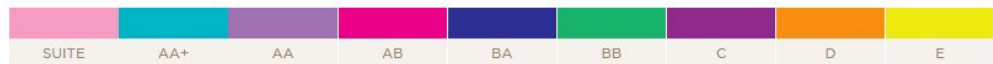

Fares listed are cruise-only, per person based on double occupancy and INCLUDES port charges of \$250 per person.