

# EXPLORE THE ENTICING DOURO WITH TORR NA LOCHS VINEYARD & WINERY

Aboard AmaSintra • 7 Nights • November 6 to 13, 2026

**WAITLIST ONLY**

Note: Stateroom layouts shown below are not to scale.

## Suite *Porto Deck* Balcony, 323 sq. ft.

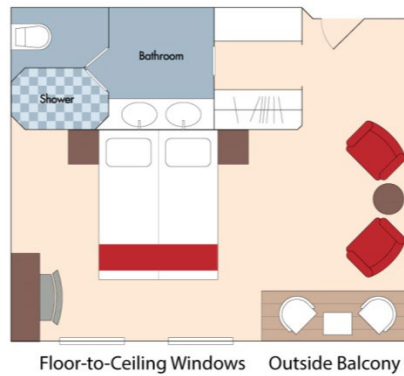

Wine Cruise Fare: \$8,847 pp

## Category A *Porto Deck* Balcony, 215 sq. ft.

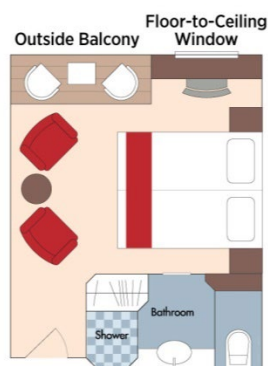

Wine Cruise Fare: \$7,347 pp

## Category B *Lisbon Deck* Balcony, 215 sq. ft.

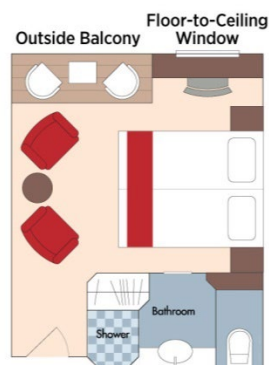

Wine Cruise Fare: \$7,047 pp

Fares listed are cruise-only, per person based on double occupancy inclusive of port charges of \$250 per person.

**Category C *Porto Deck*** French Balcony, 161 sq. ft.

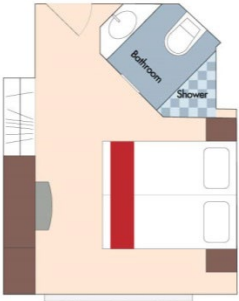

French Balcony

Wine Cruise Fare: \$6,347 pp

**Category D *Douro Deck*** Panoramic Window, 161 sq. ft.

**Category E *Douro Deck*** Panoramic Window, 161 sq. ft.

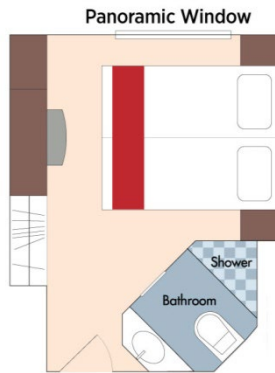

Category D  
Wine Cruise Fare: \$5,197 pp

Category E  
Wine Cruise Fare: \$4,848 pp

## DECK PLAN

1	Main Lounge
2	Reception
3	Elevator
4	Main Restaurant
5	Fitness Room
6	Spa

### Sun Deck



### Porto Deck

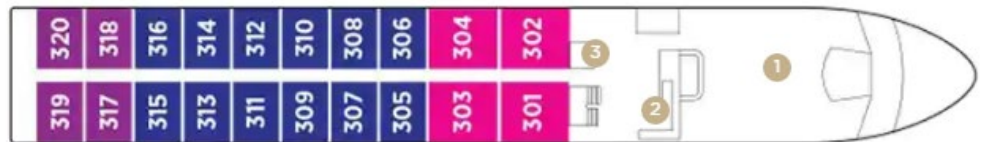

### Lisbon Deck



### Douro Deck



Stateroom Categories



Fares listed are cruise-only, per person based on double occupancy inclusive of port charges of \$250 per person.