

EXPLORE THE ENTICING DOURO WITH DRY CREEK VINEYARD

Aboard AmaDouro • 7 Nights • May 27 to June 3, 2025
 Porto • Entre-os-Rios • Régua • Pinhão • Vega Terrón • Salamanca • Barca d'Alva • Porto

**Special Rates when you book
 by March 31, 2025**

Note: Stateroom layouts shown below are not to scale.

Suite Porto Deck Balcony, 323 sq. ft.

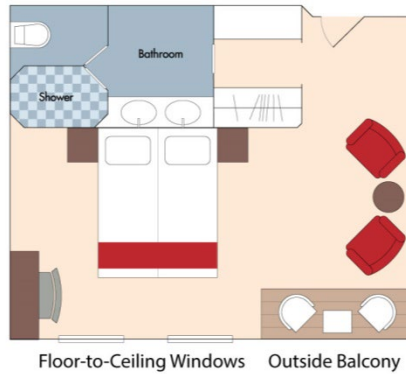

Wine Cruise Fare: ~~\$9,228~~ pp
Your Rate: \$9,028 pp

Category A Porto Deck Balcony, 215 sq. ft.

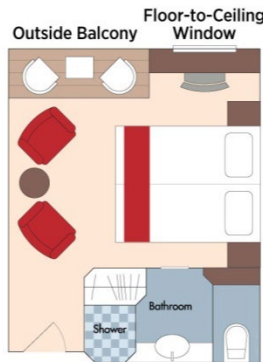

Wine Cruise Fare: ~~\$7,528~~ pp
Your Rate: \$7,328 pp

Category B Lisbon Deck Balcony, 215 sq. ft.

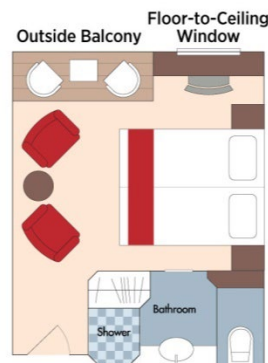

Wine Cruise Fare: ~~\$7,228~~ pp
Your Rate: \$7,028 pp

Fares listed are cruise-only, per person based on double occupancy inclusive of port charges of \$231 per person.

Category C *Porto Deck* French Balcony, 161 sq. ft.

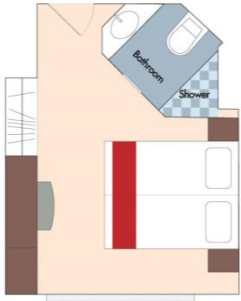

French Balcony

Wine Cruise Fare: ~~\$6,619~~ pp
Your Rate: \$6,419 pp

Category D *Douro Deck* Panoramic Window, 161 sq. ft.

Category E *Douro Deck* Panoramic Window, 161 sq. ft.



Category D
 Wine Cruise Fare: ~~\$5,528~~ pp
Your Rate: \$5,328 pp

Category E
 Wine Cruise Fare: ~~\$5,229~~ pp
Your Rate: \$5,029 pp

AmaDouro
DECK PLAN

- 1 Main Lounge
- 2 Reception
- 3 Elevator
- 4 Main Restaurant
- 5 Fitness Room
- 6 Spa

Sun Deck



Porto Deck



Lisbon Deck



Douro Deck



Stateroom Categories



Fares listed are cruise-only, per person based on double occupancy inclusive of port charges of \$231 per person.