

# SAVOR THE ESSENCE OF BURGUNDY AND PROVENCE WITH AMPHORA WINERY!

Aboard AmaCello • 7 Nights • May 1-8, 2025

Dijon • Beaune • Chalon-Sur-Saône • Tournus • Mâcon • Lyon • Vienne • Viviers • Avignon • Arles

**Book by March 31, 2025  
and SAVE \$250 per person!**

*Note: Stateroom layouts shown below are not to scale.*



**Suite, Violin Deck**  
French Balcony, 255 sq. ft.

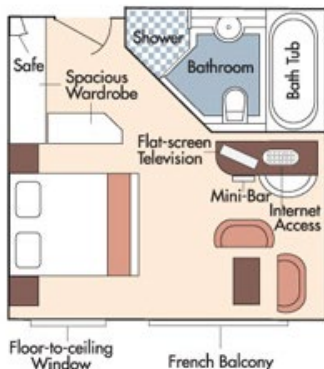

Wine Cruise Fare: ~~\$8,428~~ pp  
Your Rate: **\$8,178** pp



**CAT. A, Violin Deck**  
French Balcony, 170 sq. ft.



Wine Cruise Fare: ~~\$7,128~~ pp  
Your Rate: **\$6,878** pp



**CAT. B, Violin & Cello Deck**  
French Balcony, 170 sq. ft.



Wine Cruise Fare: ~~\$7,028~~ pp  
Your Rate: **\$6,778** pp

**CAT. C, Violin & Cello Deck**  
French Balcony, 170 sq. ft.

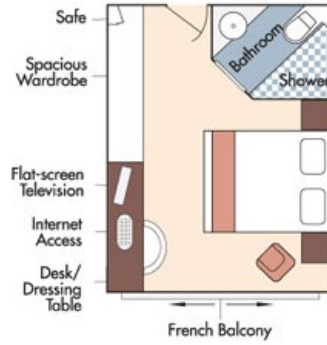

Wine Cruise Fare: ~~\$6,728~~ pp  
Your Rate: **\$6,478 pp**

**CAT. E, Piano Deck**  
Fixed Windows, 170 sq. ft.

**CAT. D, Piano Deck**  
Fixed Windows, 170 sq. ft.

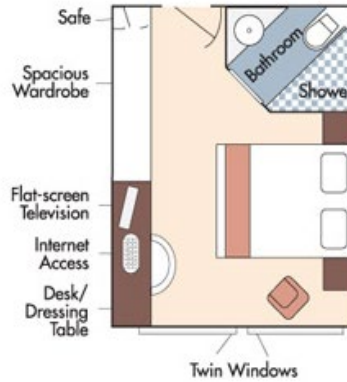

Category D  
Wine Cruise Fare: ~~\$5,628~~ pp  
Your Rate: **\$5,378 pp**

Category E  
Wine Cruise Fare: ~~\$5,329~~ pp  
Your Rate: **\$5,097 pp**

## AmaCello DECK PLAN

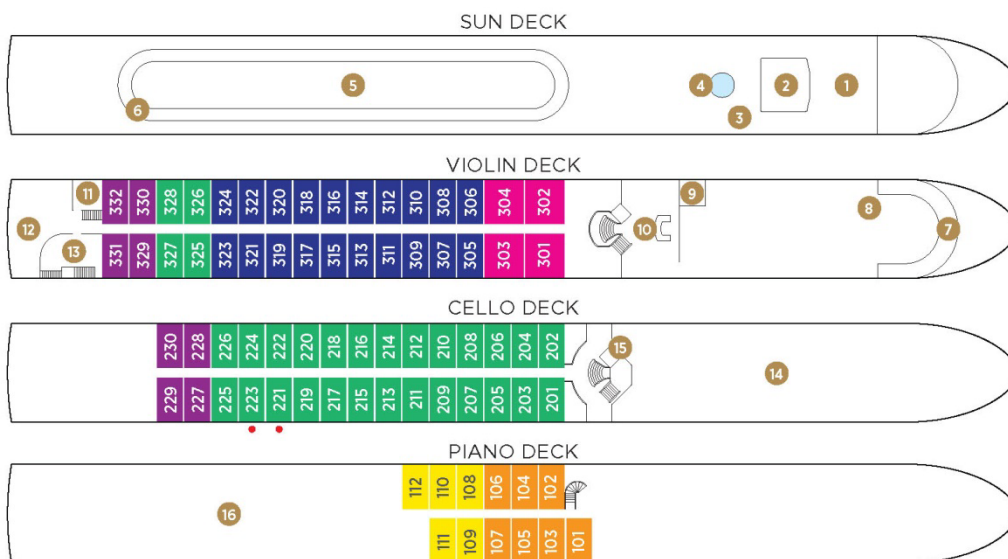

- 1 Observation Deck
- 2 Navigation Bridge
- 3 Bicycles
- 4 Whirlpool
- 5 Sun Deck
- 6 Walking Track
- 7 Bow Seating Area
- 8 Main Lounge & Bar
- 9 Gift Shop
- 10 Reception
- 11 Massage & Hair Salon
- 12 The Chef's Table Restaurant
- 13 Fitness Room
- 14 Main Restaurant
- 15 Elevator
- 16 Crew Cabins

*Elevator reaches Main Restaurant, Lobby/Main Lounge and staterooms on Violin and Cello Deck.*

<b>Suite</b>	Violin Deck / French Balcony - 255 sq. ft.	<b>Cat. D</b>	Piano Deck / Fixed Windows - 170 sq. ft.
<b>Cat. A</b>	Violin Deck / French Balcony - 170 sq. ft.	<b>Cat. E</b>	Piano Deck / Fixed Windows - 170 sq. ft.
<b>Cat. B</b>	Violin & Cello Deck / French Balcony - 170 sq. ft.	<b>Single</b>	Cello Deck / French Balcony - 140 sq. ft. <i>(Single staterooms only available on AmaCello)</i>
<b>Cat. C</b>	Violin & Cello Deck / French Balcony - 170 sq. ft.		

Fares listed are cruise-only, per person based on double occupancy inclusive of port charges of \$231 per person.