

CRUISE THE VINEYARDS OF SOUTHERN FRANCE WITH ALPHA OMEGA WINERY

Book by March 31, 2025

and SAVE

\$250 per person!

7 Nights • May 15 to 22, 2025

Arles to Lyon – Aboard AmaKristina

Note: Stateroom layouts shown below are not to scale.



Suite *Violin Deck*

French Balcony & Outside Balcony, 350 sq. ft.

Brochure Rate ~~\$9,378 pp~~

Wine cruise rate \$9,128 pp

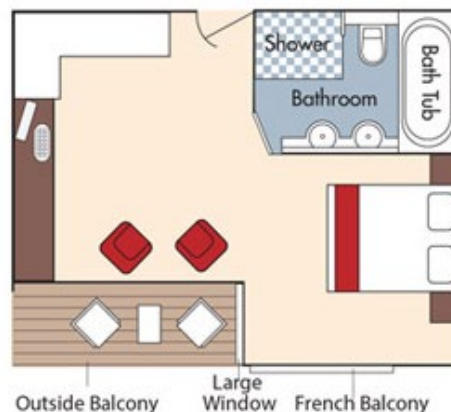

Category AA *Violin Deck*

French Balcony & Outside Balcony, 235 sq. ft.

Brochure Rate ~~\$8,078 pp~~

Wine cruise rate \$7,828 pp

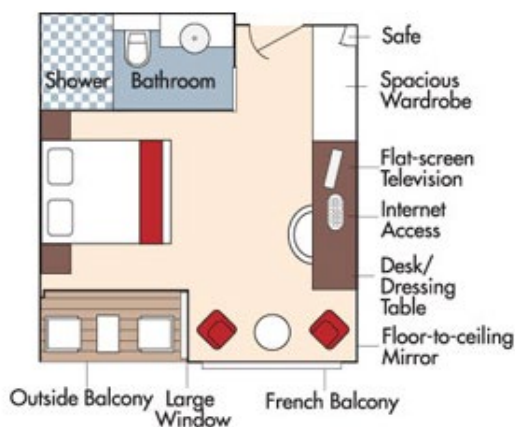

Fares listed are cruise-only, per person based on double occupancy inclusive of port charges of \$231 per person and include the exclusive wine package.



Category AB *Cello Deck*

French Balcony & Outside Balcony, 235 sq. ft.

Brochure Rate ~~\$7,859~~ pp

Wine cruise rate \$7,628 pp

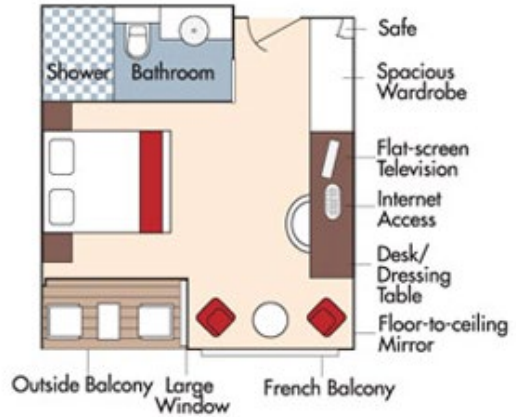

Category BA *Violin Deck*

French Balcony & Outside Balcony, 210 sq. ft.

Brochure Rate ~~\$7,678~~ pp

Wine cruise rate \$7,428 pp

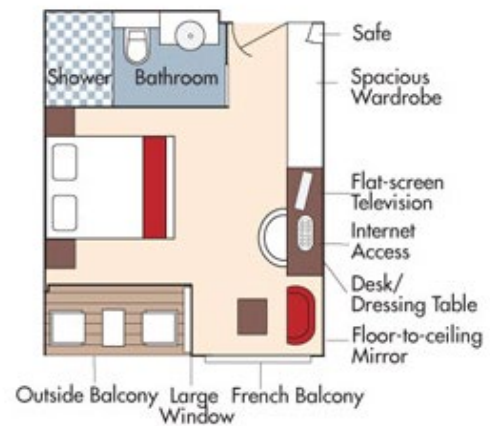

CAT. BB, Cello Deck

Category BB *Cello Deck*

French Balcony & Outside Balcony, 210 sq. ft.

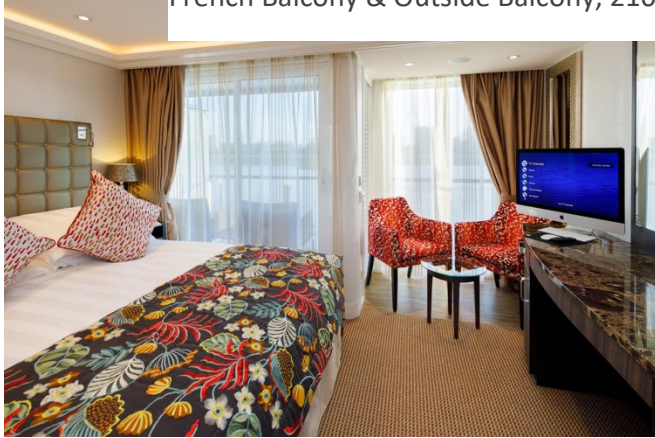

Brochure Rate ~~\$7,478 pp~~

Wine cruise rate \$7,228 pp

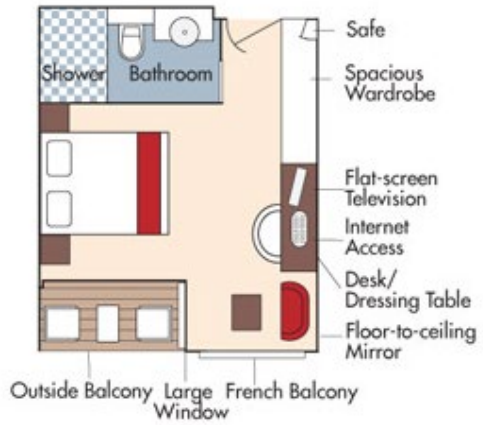

Category CA *Violin & Cello Deck*

French Balcony, 170 sq. ft.



Brochure Rate ~~\$6,878 pp~~

Wine cruise rate \$6,628 pp

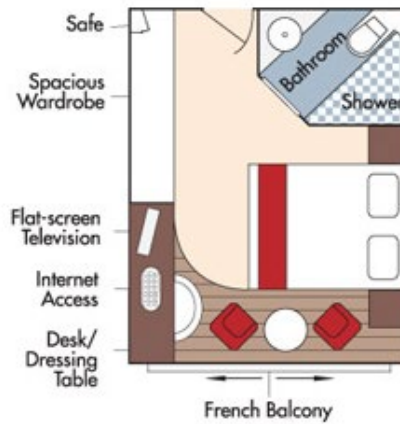

Category CB *Violin Deck*

French Balcony, 155 sq. ft.



Brochure Rate ~~\$6,478 pp~~

Wine cruise rate \$6,228 pp

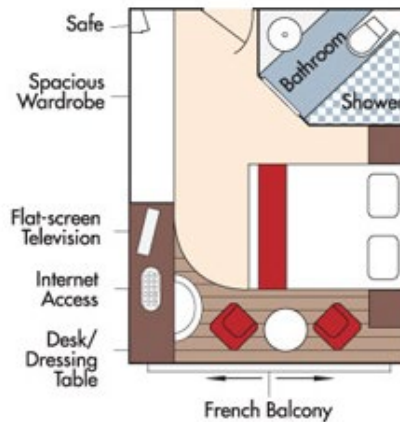

Category D *Piano Deck*
Fixed Windows, 160 sq. ft.



Brochure Rate ~~\$5,778~~ pp
Wine cruise rate \$5,528 pp

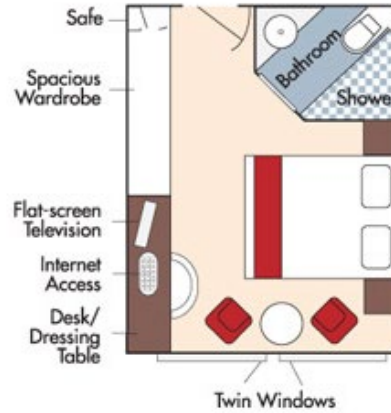

Category E *Piano Deck*
Fixed Windows, 160 sq. ft.

Brochure Rate ~~\$5,479~~ pp
Wine cruise rate \$5,229 pp

AmaKristina
DECK PLAN

- 1 Lower Sun Deck
- 2 Navigation Bridge
- 3 Bicycles
- 4 Heated Pool
- 5 Sun Deck
- 6 Walking Track
- 7 Al Fresco Terrace
- 8 Observation Lounge
- 9 Main Lounge & Bar
- 10 Gift Shop
- 11 Reception
- 12 The Chef's Table Restaurant
- 13 Main Restaurant
- 14 Elevator
- 15 Massage & Hair Salon
- 16 Fitness Room
- 17 Crew Cabins

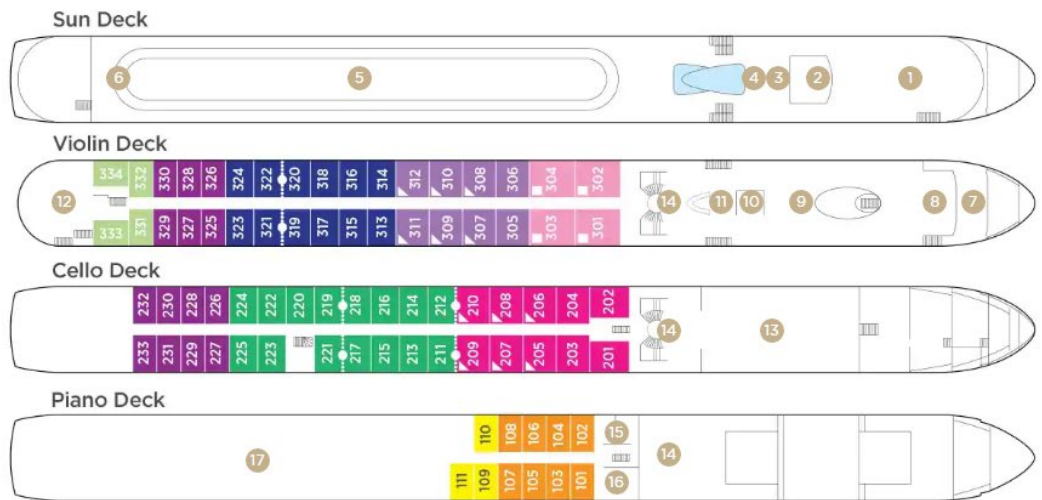

Note: Elevator reaches the Violin, Cello and Piano Deck (does not reach the Sun Deck).

.....
Staterooms can become adjoining by request.

▲
Up to triple occupancy

Stateroom Categories



Fares listed are cruise-only, per person based on double occupancy inclusive of port charges of \$231 per person and include the exclusive wine package.