



Special Rates when you book by March 31, 2025!

RIVER CRUISE FOR WINE LOVERS

Forrest Wines

Aboard AmaBella • 7 Nights • June 2 to 9, 2025

Giurgiu, Romania to Budapest, Hungary

Note: Stateroom layouts shown below are not to scale.



Suite, Violin Deck
French Balcony & Outside Balcony, 350 sq. ft.

Brochure Fare \$13,494NZD / \$8,129USD pp
Wine Cruise \$13,079NZD / \$7,879USD pp

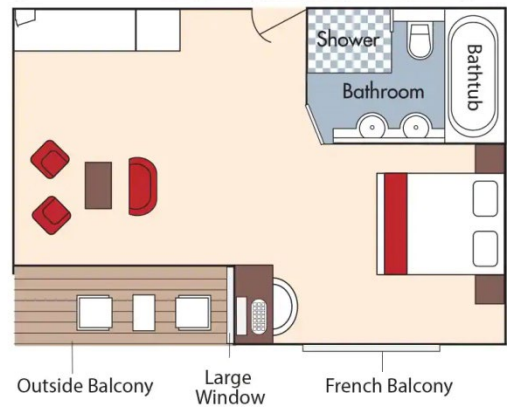

CAT. AA, Violin Deck
French Balcony & Outside Balcony, 235 sq. ft.

Brochure Fare \$11,336NZD / \$6,829USD pp
Wine Cruise \$10,921NZD / \$6,579USD pp



Fares listed are cruise-only, per person based on double occupancy and INCLUDE port charges of \$383 NZD / \$231 USD per person. New Zealand prices are estimates only; all charges will be made in USD subject to the then-current exchange rate.



CAT. AB, Cello Deck
French Balcony & Outside Balcony, 235 sq. ft.

Brochure Fare **\$11,004NZD / \$6,629USD pp**
 Wine Cruise **\$10,589NZD / \$6,379USD pp**



CAT. BA, Violin Deck
French Balcony & Outside Balcony, 210 sq. ft.

Brochure Fare **\$10,672NZD / \$6,429USD pp**
 Wine Cruise **\$10,257NZD / \$6,179USD pp**

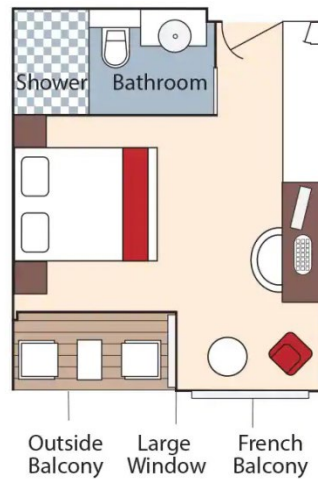

Fares listed are cruise-only, per person based on double occupancy and INCLUDE port charges of \$383 NZD / \$231 USD per person. New Zealand prices are estimates only; all charges will be made in USD subject to the then-current exchange rate.



CAT. BB, Cello Deck
 French Balcony & Outside Balcony, 210 sq. ft.

Brochure Fare ~~\$10,340~~NZD / ~~\$6,229~~USD pp
 Wine Cruise \$9,925NZD / \$5,979USD pp

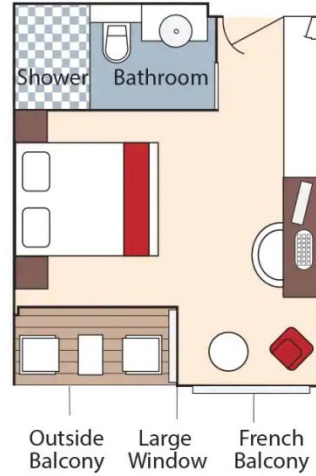

CAT. C, Violin & Cello Deck
 French Balcony, 170 sq. ft.

Brochure Fare ~~\$9,344~~NZD / ~~\$5,629~~USD pp
 Wine Cruise \$8,929NZD / \$5,379USD pp

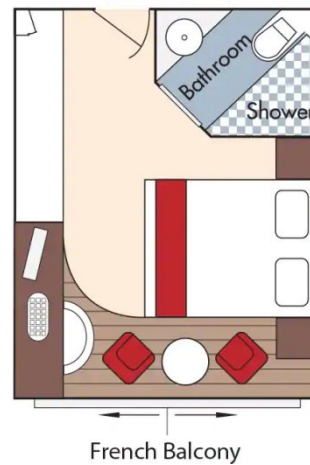

Fares listed are cruise-only, per person based on double occupancy and INCLUDE port charges of \$383 NZD / \$231 USD per person. New Zealand prices are estimates only; all charges will be made in USD subject to the then-current exchange rate.



CAT. D, Piano Deck
Fixed Windows, 170 sq. ft.

Brochure Fare \$7,518NZD / \$4,529USD pp
Wine Cruise \$7,103NZD / \$4,279USD pp



CAT. E, Piano Deck
Fixed Windows, 170 sq. ft.

Brochure Fare \$7,022NZD / \$4,230USD pp
Wine Cruise \$6,607NZD / \$3,980USD pp

AmaBella DECK PLAN

1	Lower Sun Deck
2	Navigation Bridge
3	Bicycles
4	Heated Pool
5	Sun Deck
6	Walking Track
7	Putting Green
8	Bow Seating Area
9	Observation Lounge
10	Main Lounge & Bar
11	Gift Shop
12	Reception
13	Massage & Hair Salon
14	Fitness Room
15	The Chef's Table Restaurant
16	Main Restaurant
17	Elevator
18	Crew Cabins

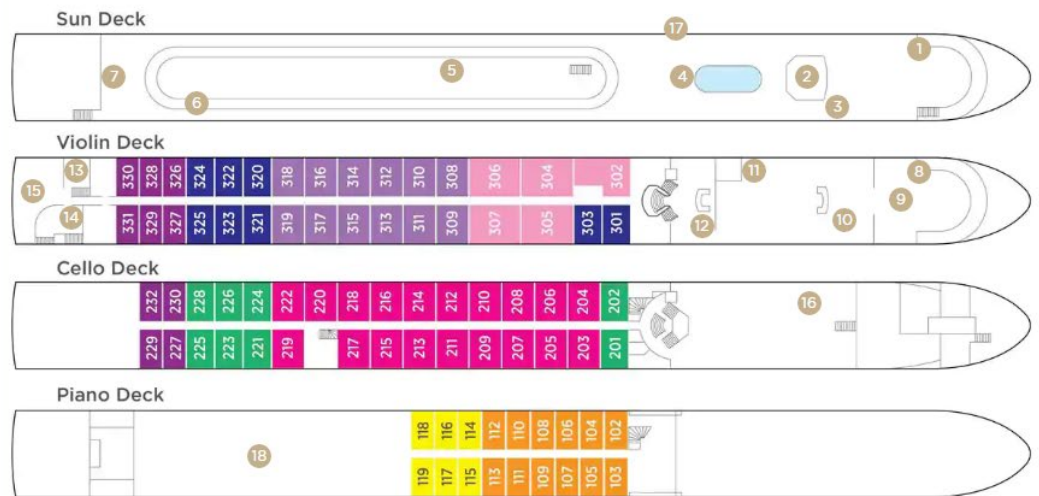

Stateroom Categories



Fares listed are cruise-only, per person based on double occupancy and INCLUDE port charges of \$383 NZD / \$231 USD per person.
New Zealand prices are estimates only; all charges will be made in USD subject to the then-current exchange rate.