

EXPLORE THE ENTICING DOURO WITH BLUE FARM AND MUSCARDINI CELLARS

Aboard AmaDouro • 7 Nights • June 23 to 30, 2026

**Book by December 31, 2024
and SAVE up to \$450 per person!**

Note: Stateroom layouts shown below are not to scale.

Suite *Porto Deck* Balcony, 323 sq. ft.

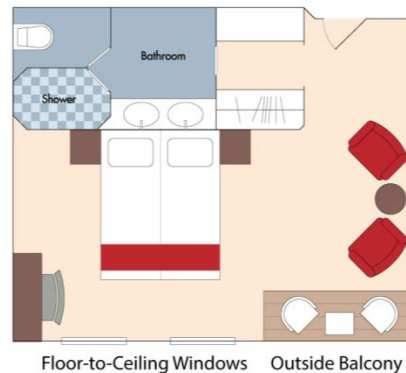

Brochure Fare: ~~\$9,147~~ pp
Your Rate: \$8,697 pp

Category A *Porto Deck* Balcony, 215 sq. ft.

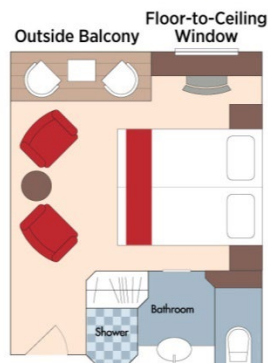

Brochure Fare: ~~\$7,647~~ pp
Your Rate: \$7,247 pp

Category B *Lisbon Deck* Balcony, 215 sq. ft.

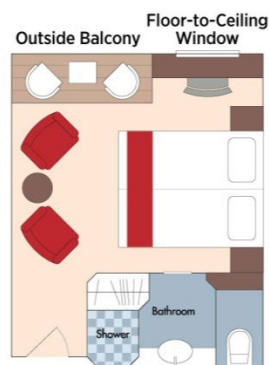

Brochure Fare: ~~\$7,347~~ pp
Your Rate: \$6,997 pp

Fares listed are cruise-only, per person based on double occupancy AND INCLUDE port charges of \$250 per person.

Category C *Porto Deck* French Balcony, 161 sq. ft.

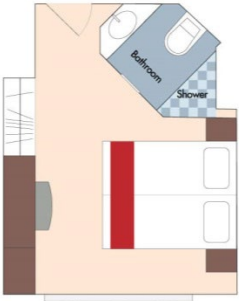

French Balcony

Brochure Fare: \$6,647 pp

Your Rate: \$6,297 pp

Category D *Douro Deck* Panoramic Window, 161 sq. ft.

Category E *Douro Deck* Panoramic Window, 161 sq. ft.



Category D

Brochure Fare: \$5,497 pp

Your Rate: \$5,197 pp

Category E

Brochure Fare: \$5,148 pp

Your Rate: \$4,898 pp

DECK PLAN

| | |
|---|-----------------|
| 1 | Main Lounge |
| 2 | Reception |
| 3 | Elevator |
| 4 | Main Restaurant |
| 5 | Fitness Room |
| 6 | Spa |

Sun Deck



Porto Deck

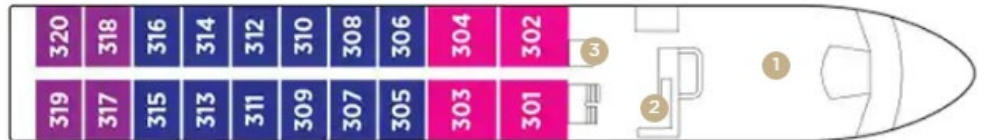

Lisbon Deck



Douro Deck



Stateroom Categories



Fares listed are cruise-only, per person based on double occupancy AND INCLUDE port charges of \$250 per person.