

# EXPLORE THE ENTICING DOURO WITH AMPHORA WINERY

Aboard AmaDouro • 7 Nights • April 7 to 14, 2026

**Book by December 31, 2024  
and SAVE up to \$450 per person!**

Note: Stateroom layouts shown below are not to scale.

## Suite *Porto Deck* Balcony, 323 sq. ft.

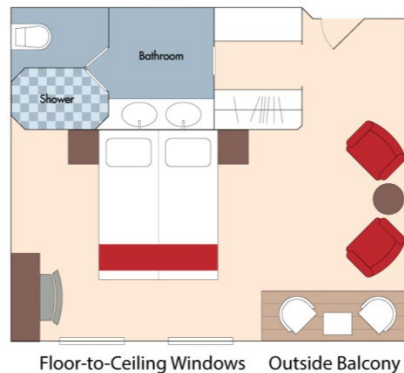

Brochure Fare: ~~\$8,747~~ pp  
Your Rate: \$8,297 pp

## Category A *Porto Deck* Balcony, 215 sq. ft.

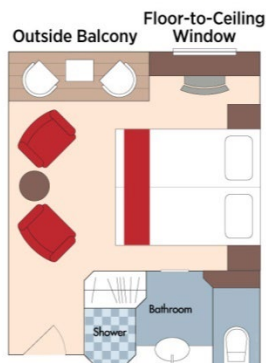

Brochure Fare: ~~\$7,247~~ pp  
Your Rate: \$6,897 pp

## Category B *Lisbon Deck* Balcony, 215 sq. ft.

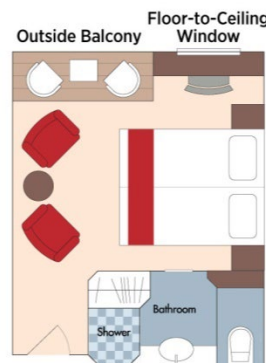

Brochure Fare: ~~\$6,947~~ pp  
Your Rate: \$6,597 pp

**Category C *Porto Deck*** French Balcony, 161 sq. ft.

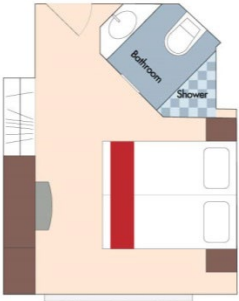

French Balcony

Brochure Fare: \$6,247 pp  
Your Rate: \$5,897 pp

**Category D *Douro Deck*** Panoramic Window, 161 sq. ft.

**Category E *Douro Deck*** Panoramic Window, 161 sq. ft.

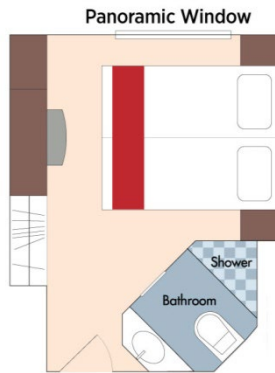

Category D  
Brochure Fare: \$5,097 pp  
Your Rate: \$4,847 pp

Category E  
Brochure Fare: \$4,748 pp  
Your Rate: \$4,498 pp

## DECK PLAN

1	Main Lounge
2	Reception
3	Elevator
4	Main Restaurant
5	Fitness Room
6	Spa

### Sun Deck



### Porto Deck

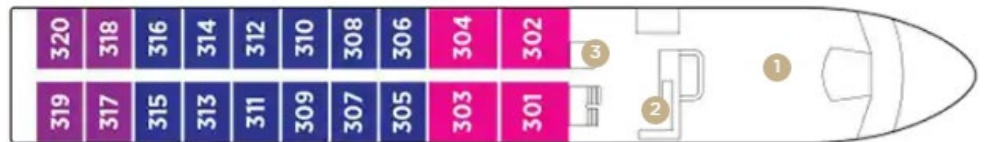

### Lisbon Deck



### Douro Deck



Stateroom Categories



Fares listed are cruise-only, per person based on double occupancy AND INCLUDE port charges of \$250 per person.