

# SAVOR A WINE CRUISE THROUGH BORDEAUX WITH MOUNT EDEN VINEYARDS & RIDGE VINEYARDS AND THE WINES OF THE SANTA CRUZ MOUNTAINS

## AmaDolce • May 21 – 28, 2026

Bordeaux • Libourne • Blaye • Bourg • Cussac-Fort-Medoc • Cadillac • Bordeaux

**Special Rates when you book  
by December 31, 2024**



Suite, Violin Deck  
French Balcony, 255 sq. ft.

*Note: Stateroom layouts shown below are not to scale.*

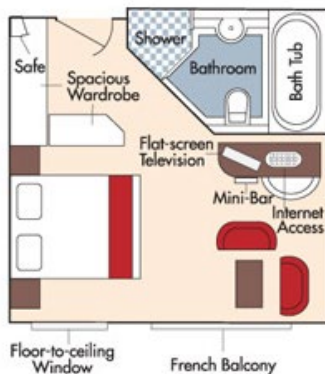

Brochure Rate: ~~\$8,647 pp~~

Wine Cruise Rate: \$8,247 pp



CAT. A+, Violin Deck  
French Balcony, 225 sq. ft.

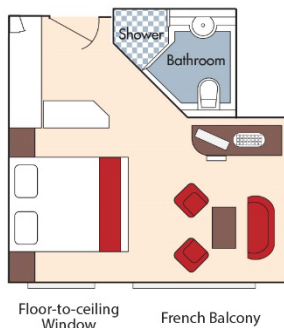

Brochure Rate: ~~\$8,347 pp~~

Wine Cruise Rate: \$7,947 pp



CAT. A, Violin Deck  
French Balcony, 170 sq. ft.

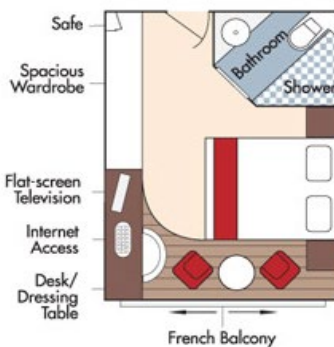

Brochure Rate: ~~\$7,347 pp~~

Wine Cruise Rate: \$6,997 pp

**CAT. B, Violin & Cello Deck**  
French Balcony, 170 sq. ft.

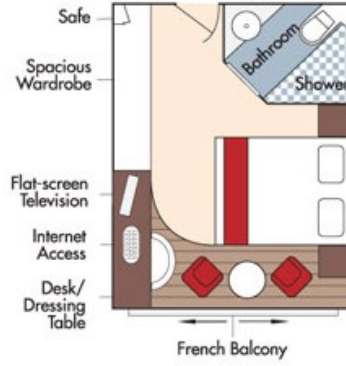

Brochure Rate: ~~\$7,247~~ pp  
Wine Cruise Rate: \$6,898 pp

**CAT. C, Violin & Cello Deck**  
French Balcony, 170 sq. ft.

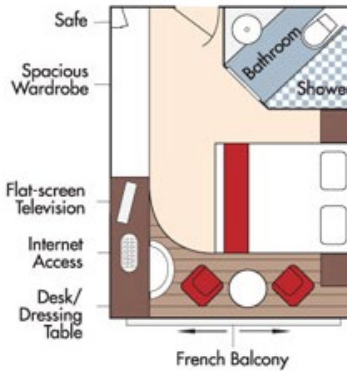

Brochure Rate: ~~\$6,947~~ pp  
Wine Cruise Rate: \$6,597 pp

**CAT. E, Piano Deck**  
Fixed Windows, 170 sq. ft.

**CAT. D, Piano Deck**  
Fixed Windows, 170 sq. ft.

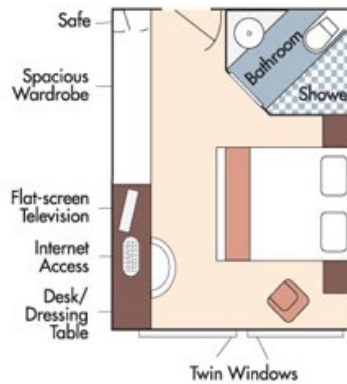

Category D  
Brochure Rate: ~~\$5,747~~ pp  
Wine Cruise Rate: \$5,497 pp

Category E  
Brochure Rate: ~~\$5,448~~ pp  
Wine Cruise Rate: \$5,198 pp

## AmaDolce Deck Plan

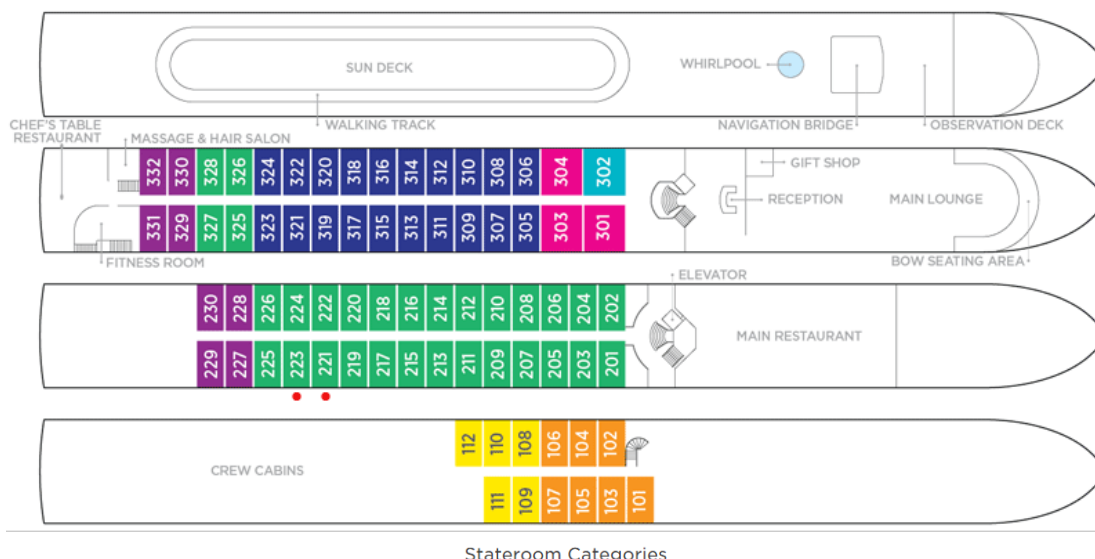

Fares listed are cruise-only, per person based on double occupancy AND INCLUDE port charges of \$250 per person.