

RIVER CRUISE FOR WINE LOVERS

UNCORK LOCAL TRADITIONS, SAVOR INTENSE FLAVORS AND ENJOY PALATE-PLEASING ADVENTURES DURING AN AMAWATERWAYS WINE CRUISE

Judd's Hill Winery

Aboard AmaKristina • 7 Nights • April 2 to 9, 2026

Note: Stateroom layouts shown below are not to scale.

**Book by December 31, 2024
for this Special Pricing!**



Suite *Violin Deck*

French Balcony & Outside Balcony, 350 sq. ft.

Brochure Rate = ~~\$8,648~~ pp

Wine Cruise Rate = \$7,991 pp

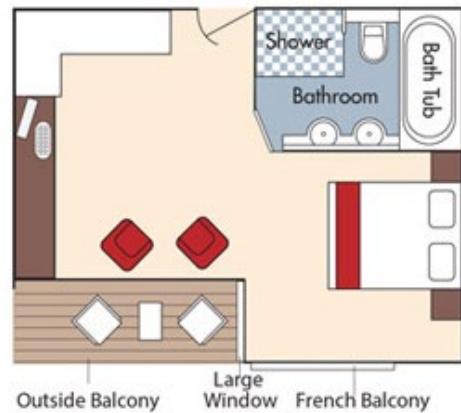

Category AA *Violin Deck*

French Balcony & Outside Balcony, 235 sq. ft.

Brochure Rate = ~~\$7,348~~ pp

Wine Cruise Rate = \$6,756 pp

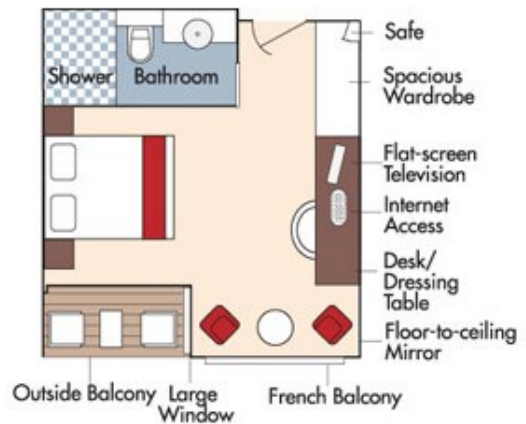



Category AB *Cello Deck*

French Balcony & Outside Balcony, 235 sq. ft.

Brochure Rate = ~~\$7,148~~ pp

Wine Cruise Rate = \$6,566 pp

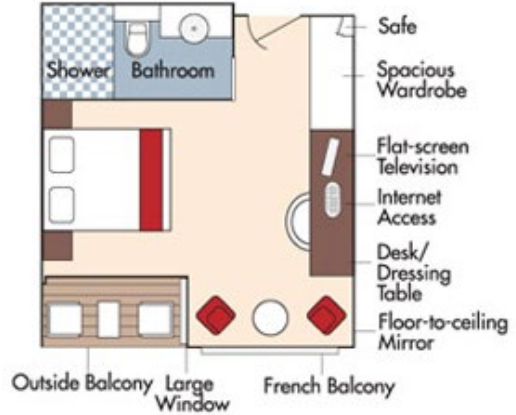

Category BA *Violin Deck*

French Balcony & Outside Balcony, 210 sq. ft.

Brochure Rate = ~~\$6,948~~ pp

Wine Cruise Rate = \$6,376 pp

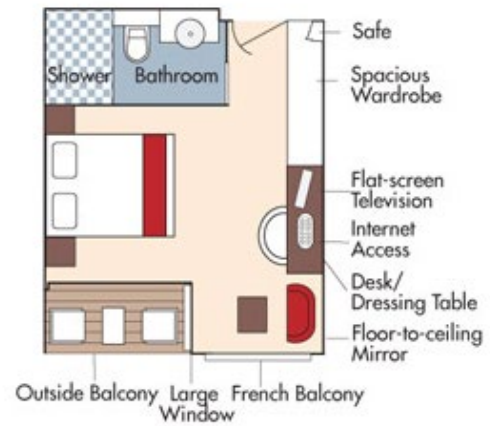

Category BB *Cello Deck*

French Balcony & Outside Balcony, 210 sq. ft.



Brochure Rate = ~~\$6,748 pp~~
Wine Cruise Rate \$6,186 pp

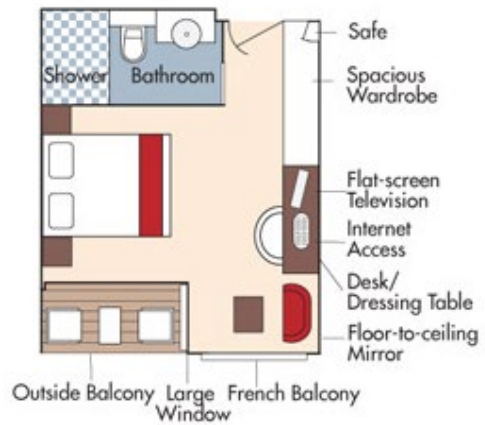

Category CA *Violin & Cello Deck*

French Balcony, 170 sq. ft.



Brochure Rate = ~~\$6,148 pp~~
Wine Cruise Rate = \$5,616 pp

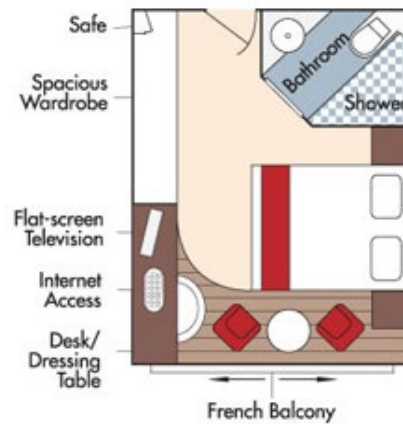

Category CB *Violin Deck*

French Balcony, 155 sq. ft.



Brochure Rate = ~~\$5,748 pp~~
Wine Cruise Rate = \$5,236 pp

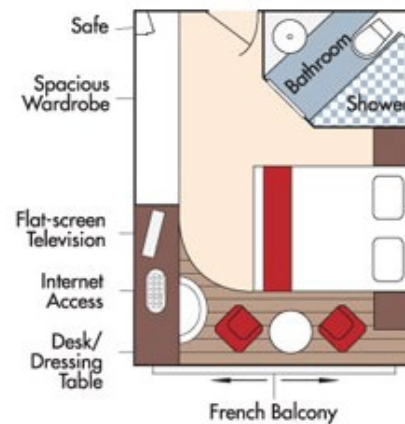

Category D *Piano Deck*
Fixed Windows, 160 sq. ft.



Brochure Rate = \$4,948 pp
Wine Cruise Rate = \$4,476 pp

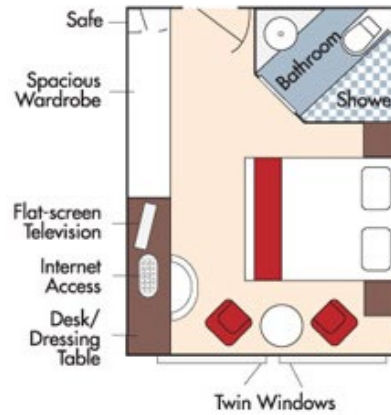

Category E *Piano Deck*
Fixed Windows, 160 sq. ft.

Brochure Rate = \$4,649 pp
Wine Cruise Rate = \$4,192 pp

AmaKristina DECK PLAN

1	Lower Sun Deck
2	Navigation Bridge
3	Bicycles
4	Heated Pool
5	Sun Deck
6	Walking Track
7	Al Fresco Terrace
8	Observation Lounge
9	Main Lounge & Bar
10	Gift Shop
11	Reception
12	The Chef's Table Restaurant
13	Main Restaurant
14	Elevator
15	Massage & Hair Salon
16	Fitness Room
17	Crew Cabins

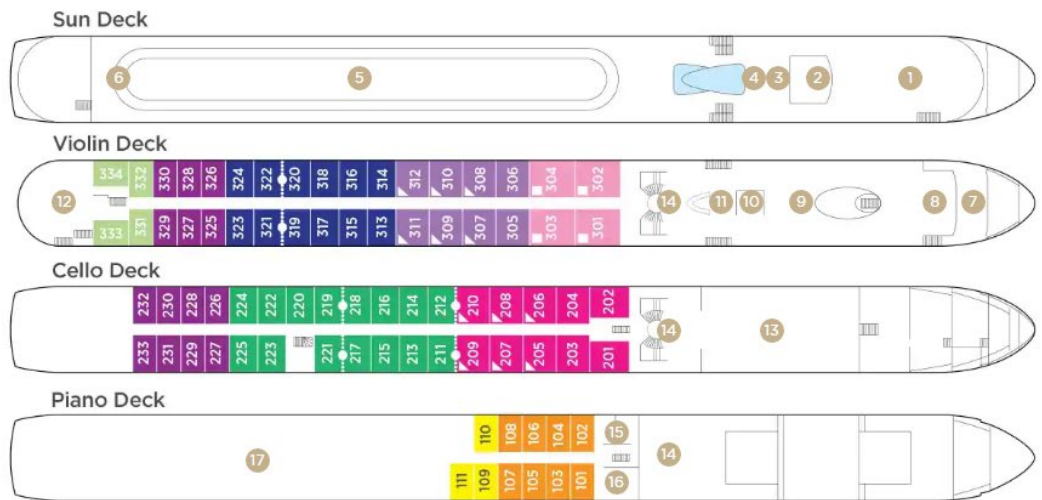

Note: Elevator reaches the Violin, Cello and Piano Deck (does not reach the Sun Deck).

Staterooms can become adjoining by request.

Up to triple occupancy

Stateroom Categories



Fares listed are cruise-only, per person based on double occupancy and INCLUDE port charges of \$250 per person.