

SAVOR A WINE CRUISE THROUGH FRANCE WITH MOLON LAVE AND RAPPAHANNOCK CELLARS

Aboard AmaKristina • 7 Nights • June 19 to 26, 2025
Lyon • Vienne • Tournon • Viviers • Avignon • Arles

Note: Stateroom layouts shown below are not to scale.

**Book by December 31, 2024
for this Special Pricing**



Suite *Violin Deck*

French Balcony & Outside Balcony, 350 sq. ft. Wine Cruise rate = \$9,078 pp

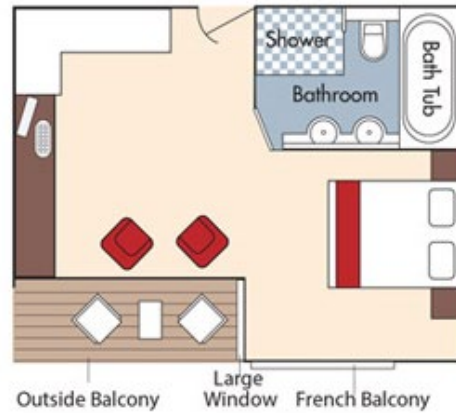

Category AA *Violin Deck*

French Balcony & Outside Balcony, 235 sq. ft. Wine Cruise rate = \$7,778 pp

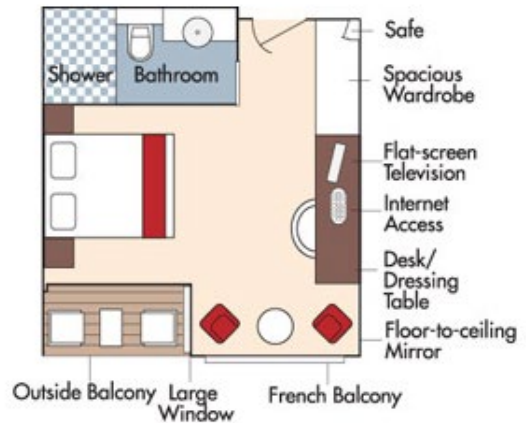

Fares listed are cruise-only, per person based on double occupancy inclusive of port charges of \$231 per person and include the exclusive wine package.



Category AB *Cello Deck*

French Balcony & Outside Balcony, 235 sq. ft. Wine Cruise rate = \$7,578 pp

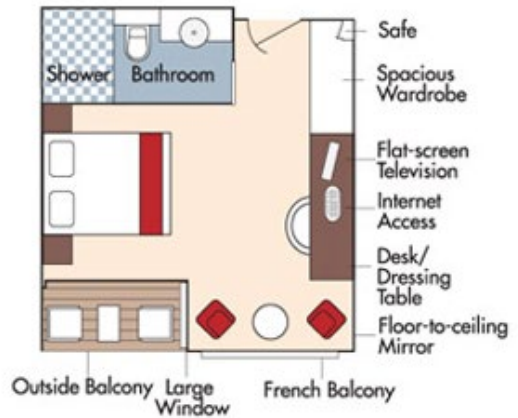

Category BA *Violin Deck*

French Balcony & Outside Balcony, 210 sq. ft. Wine Cruise rate = \$7,378 pp

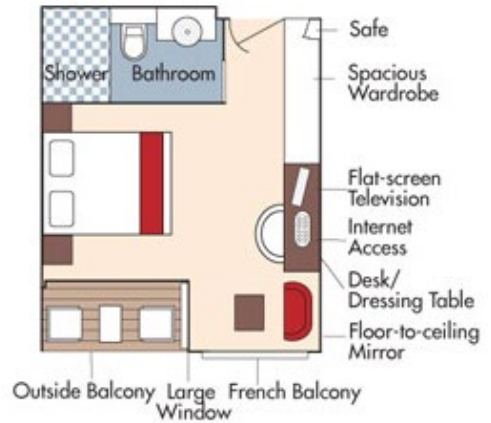



CAT. BB, Cello Deck

Category BB *Cello Deck*

French Balcony & Outside Balcony, 210 sq. ft.

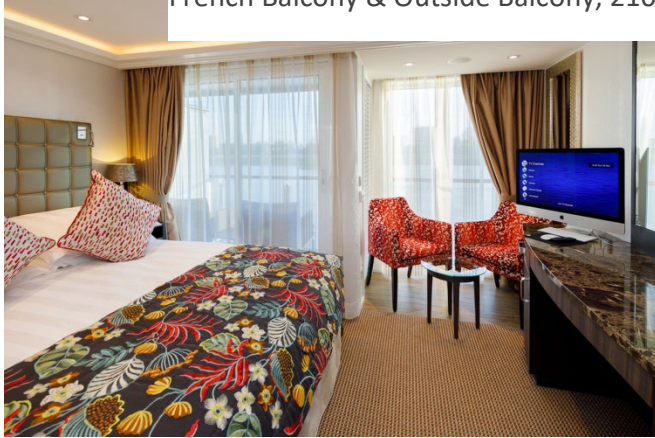

Wine Cruise rate \$7,178 pp

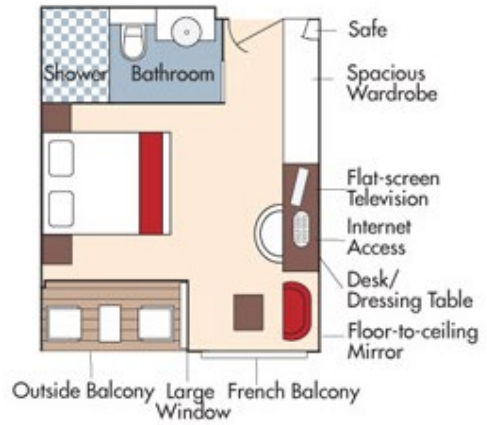

Category CA *Violin & Cello Deck*

French Balcony, 170 sq. ft.



Wine Cruise rate = \$6,578 pp

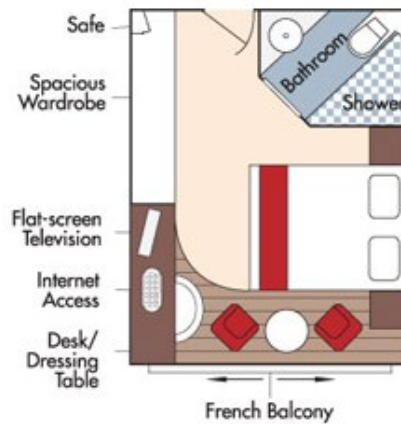

Category CB *Violin Deck*

French Balcony, 155 sq. ft.



Wine Cruise rate = \$6,178 pp

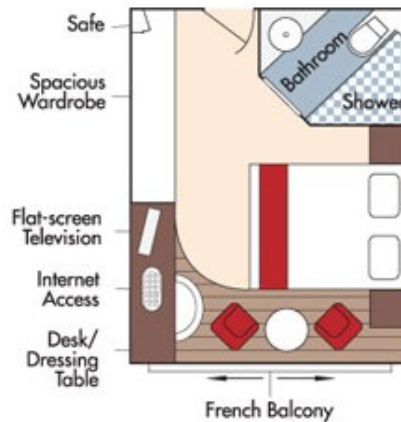

Category D *Piano Deck*
Fixed Windows, 160 sq. ft.

Wine Cruise rate = \$5,478 pp

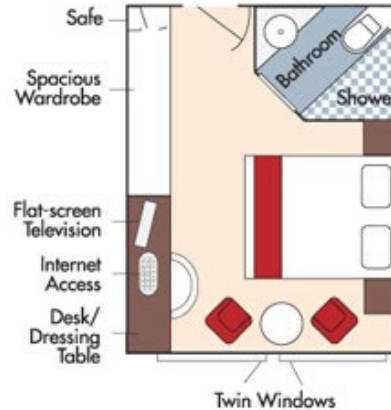

Category E *Piano Deck*
Fixed Windows, 160 sq. ft.

Wine Cruise rate = \$5,179 pp

AmaKristina
DECK PLAN

- 1 Lower Sun Deck
- 2 Navigation Bridge
- 3 Bicycles
- 4 Heated Pool
- 5 Sun Deck
- 6 Walking Track
- 7 Al Fresco Terrace
- 8 Observation Lounge
- 9 Main Lounge & Bar
- 10 Gift Shop
- 11 Reception
- 12 The Chef's Table Restaurant
- 13 Main Restaurant
- 14 Elevator
- 15 Massage & Hair Salon
- 16 Fitness Room
- 17 Crew Cabins

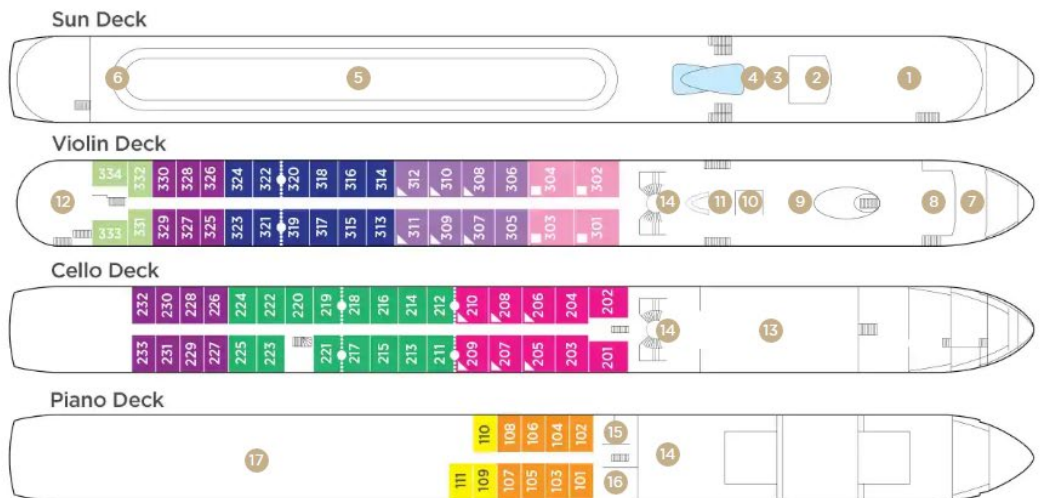

Note: Elevator reaches the Violin, Cello and Piano Deck (does not reach the Sun Deck).

.....
Staterooms can become adjoining by request.

▲
Up to triple occupancy

Stateroom Categories



Fares listed are cruise-only, per person based on double occupancy inclusive of port charges of \$231 per person and include the exclusive wine package.