



Special Rates when you book by October 31, 2024!

RIVER CRUISE FOR WINE LOVERS

Sonoma-Cutrer Vineyards

Aboard AmaCello • 7 Nights • July 24-31, 2025

Port of Dijon • Seurre • Beaune • Chalon-Sur-Saône • Tournus • Brancion • Mâcon • Lyon

Note: Stateroom layouts shown below are not to scale.



Suite, Violin Deck
French Balcony, 255 sq. ft.

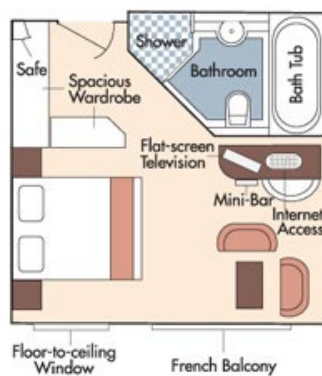

Brochure Fare: ~~\$7,929~~ pp
Your Rate: **\$6,679 pp**



CAT. A, Violin Deck
French Balcony, 170 sq. ft.



Brochure Fare: ~~\$6,629~~ pp
Your Rate: **\$5,379 pp**



CAT. B, Violin & Cello Deck
French Balcony, 170 sq. ft.

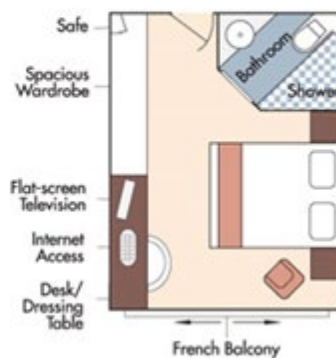

Brochure Fare: ~~\$6,529~~ pp
Your Rate: **\$5,279 pp**

Fares listed are cruise-only, per person based on double occupancy inclusive of port charges of \$231 per person.

CAT. C, Violin & Cello Deck
French Balcony, 170 sq. ft.

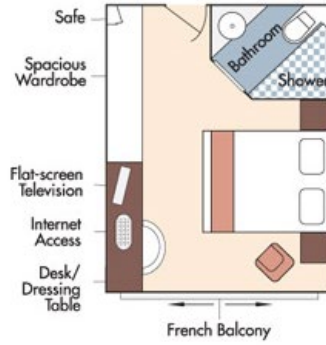

Brochure Fare: ~~\$6,229~~ pp

Your Rate: \$4,979 pp

CAT. E, Piano Deck
Fixed Windows, 170 sq. ft.

CAT. D, Piano Deck
Fixed Windows, 170 sq. ft.

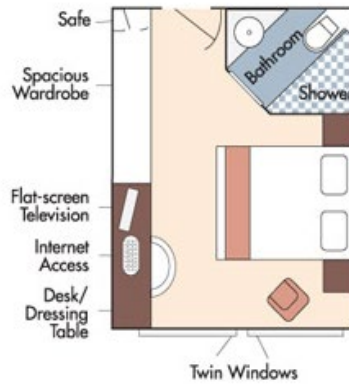

Category D

Brochure Fare: ~~\$5,129~~ pp

Your Rate: \$3,879 pp

Category E

Brochure Fare: ~~\$4,830~~ pp

Your Rate: \$3,580 pp

AmaCello DECK PLAN

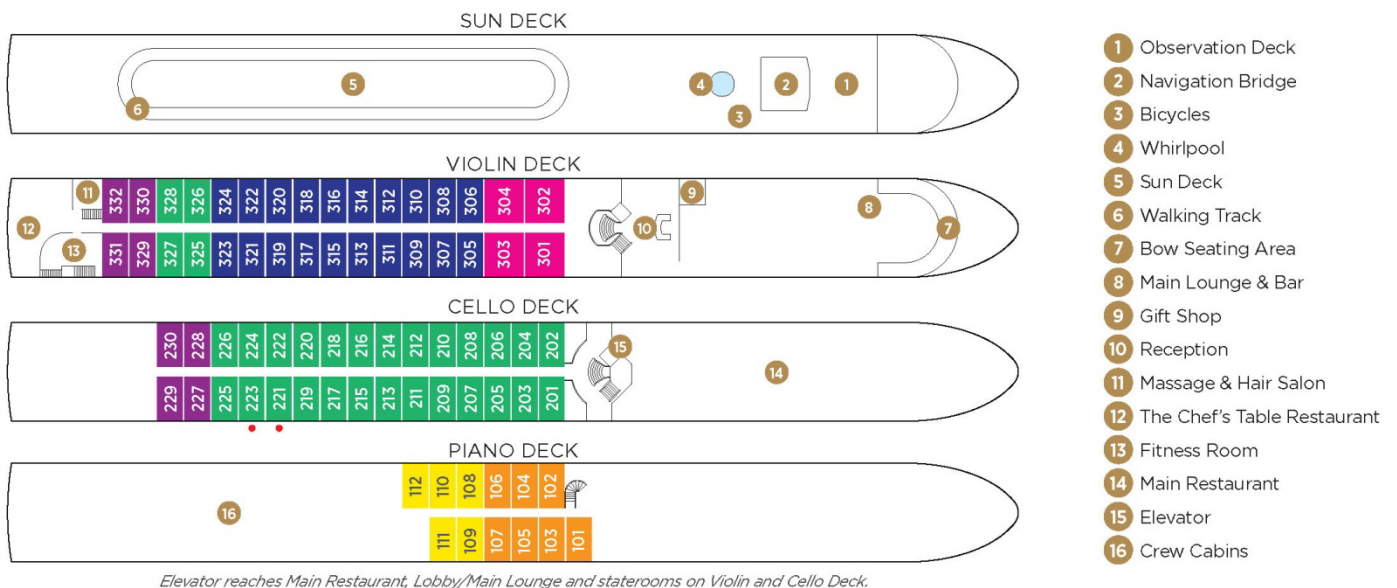

Suite Violin Deck / French Balcony - 255 sq. ft.
Cat. A Violin Deck / French Balcony - 170 sq. ft.
Cat. B Violin & Cello Deck / French Balcony - 170 sq. ft.
Cat. C Violin & Cello Deck / French Balcony - 170 sq. ft.

Cat. D Piano Deck / Fixed Windows - 170 sq. ft.
Cat. E Piano Deck / Fixed Windows - 170 sq. ft.
Single Cello Deck / French Balcony - 140 sq. ft.
(Single staterooms only available on AmaCello)