

# RIVER CRUISE FOR WINE LOVERS

UNCORK LOCAL TRADITIONS, SAVOR INTENSE FLAVORS AND ENJOY PALATE-PLEASING ADVENTURES DURING AN AMAWATERWAYS WINE CRUISE

## FLAVORS OF BURGUNDY

Aboard AmaCello • 7 Nights • April 16-23, 2026

Port of Dijon • Seurre • Beaune • Chalon-Sur-Saône • Tournus • Brancion • Mâcon • Lyon

*Book by December 31, 2024  
and SAVE \$500 per stateroom  
PLUS 5% Early Booking Reward*

*Note: Stateroom layouts shown below are not to scale.*

 Suite, Violin Deck  
French Balcony, 255 sq. ft.



Brochure Fare: ~~\$8,048~~ pp  
 Your Rate: \$7,420.60 pp

 CAT. A, Violin Deck  
French Balcony, 170 sq. ft.

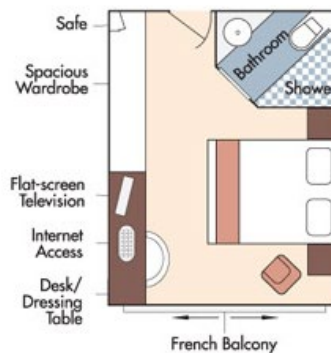

Brochure Fare: ~~\$6,748~~ pp  
 Your Rate: \$6,185.60 pp

 CAT. B, Violin & Cello Deck  
French Balcony, 170 sq. ft.

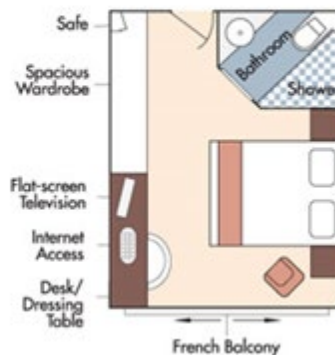

Brochure Fare: ~~\$6,648~~ pp  
 Your Rate: \$6,090.60 pp

CAT. C, Violin & Cello Deck  
French Balcony, 170 sq. ft.

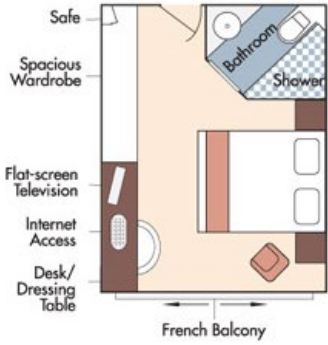

Brochure Fare: ~~\$6,348~~ pp  
Your Rate: \$5,805.60 pp

CAT. E, Piano Deck  
Fixed Windows, 170 sq. ft.



CAT. D, Piano Deck  
Fixed Windows, 170 sq. ft.

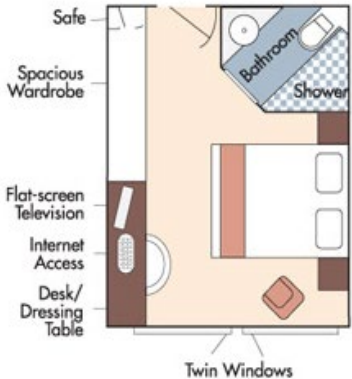

Category D  
Brochure Fare: ~~\$5,148~~ pp  
Your Rate: \$4,665.60 pp

Category E  
Brochure Fare: ~~\$4,849~~ pp  
Your Rate: \$4,381.55 pp

AmaCello  
DECK PLAN

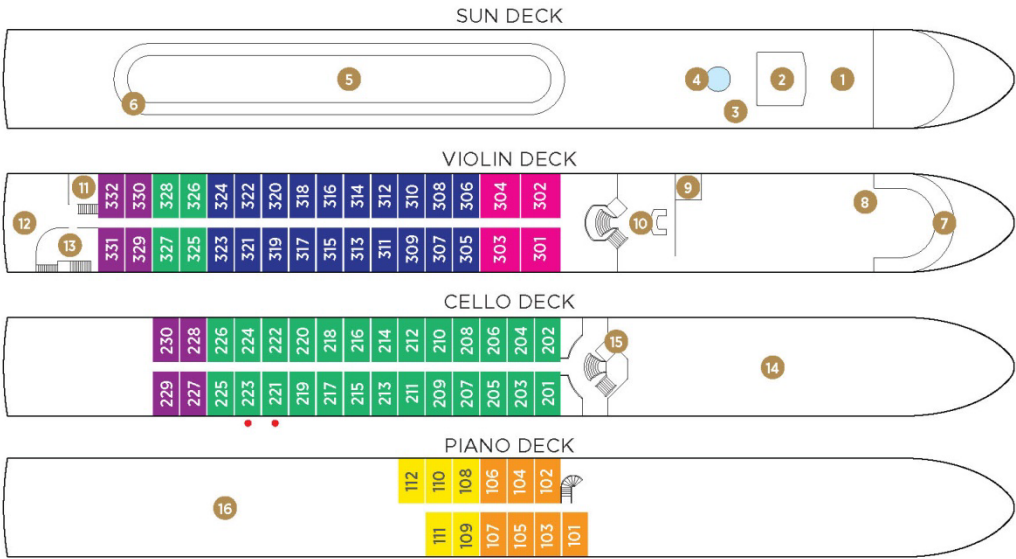

- 1 Observation Deck
- 2 Navigation Bridge
- 3 Bicycles
- 4 Whirlpool
- 5 Sun Deck
- 6 Walking Track
- 7 Bow Seating Area
- 8 Main Lounge & Bar
- 9 Gift Shop
- 10 Reception
- 11 Massage & Hair Salon
- 12 The Chef's Table Restaurant
- 13 Fitness Room
- 14 Main Restaurant
- 15 Elevator
- 16 Crew Cabins

Elevator reaches Main Restaurant, Lobby/Main Lounge and staterooms on Violin and Cello Deck.

Suite	Violin Deck / French Balcony - 255 sq. ft.	Cat. D	Piano Deck / Fixed Windows - 170 sq. ft.
Cat. A	Violin Deck / French Balcony - 170 sq. ft.	Cat. E	Piano Deck / Fixed Windows - 170 sq. ft.
Cat. B	Violin & Cello Deck / French Balcony - 170 sq. ft.	Single	Cello Deck / French Balcony - 140 sq. ft. (Single staterooms only available on AmaCello)
Cat. C	Violin & Cello Deck / French Balcony - 170 sq. ft.		

Fares listed are cruise-only, per person based on double occupancy AND INCLUDE port charges of \$250 per person.