

# EXPLORE THE ENTICING DOURO WITH DRY CREEK VINEYARD

Aboard AmaDouro • 7 Nights • May 27 to June 3, 2025  
Porto • Entre-os-Rios • Régua • Pinhão • Vega Terrón • Salamanca • Barca d'Alva • Porto

**Special Rates when you book  
by December 31, 2024**

Note: Stateroom layouts shown below are not to scale.

## Suite Porto Deck Balcony, 323 sq. ft.

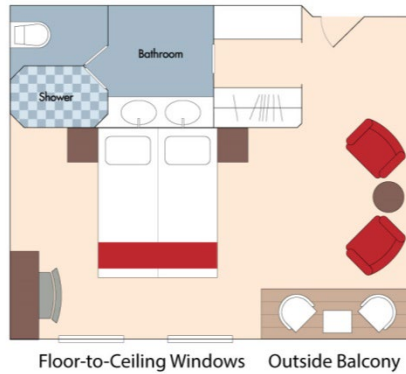

Wine Cruise Fare: ~~\$9,228~~ pp  
Your Rate: **\$9,028 pp**

## Category A Porto Deck Balcony, 215 sq. ft.

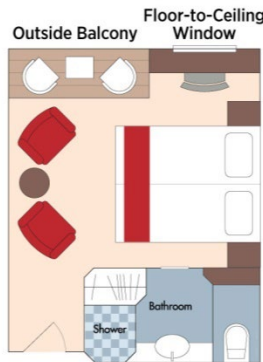

Wine Cruise Fare: ~~\$7,528~~ pp  
Your Rate: **\$7,328 pp**

## Category B Lisbon Deck Balcony, 215 sq. ft.

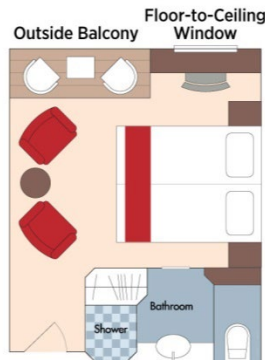

Wine Cruise Fare: ~~\$7,228~~ pp  
Your Rate: **\$7,028 pp**

**Category C *Porto Deck*** French Balcony, 161 sq. ft.

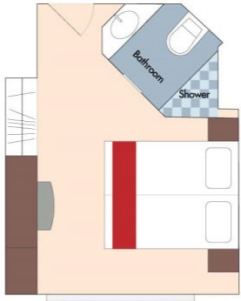

French Balcony

Wine Cruise Fare: ~~\$6,619~~ pp  
**Your Rate: \$6,419 pp**

**Category D *Douro Deck*** Panoramic Window, 161 sq. ft.

**Category E *Douro Deck*** Panoramic Window, 161 sq. ft.



**Category D**  
 Wine Cruise Fare: ~~\$5,528~~ pp  
**Your Rate: \$5,328 pp**

**Category E**  
 Wine Cruise Fare: ~~\$5,229~~ pp  
**Your Rate: \$5,029 pp**

*AmaDouro*  
**DECK PLAN**

- 1 Main Lounge
- 2 Reception
- 3 Elevator
- 4 Main Restaurant
- 5 Fitness Room
- 6 Spa

**Sun Deck**

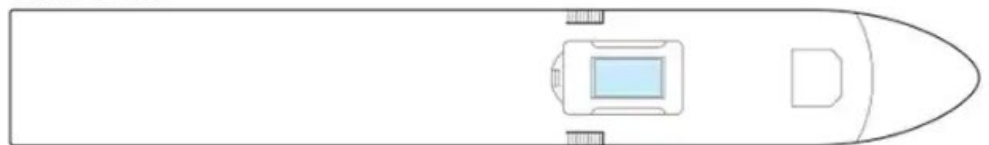

**Porto Deck**

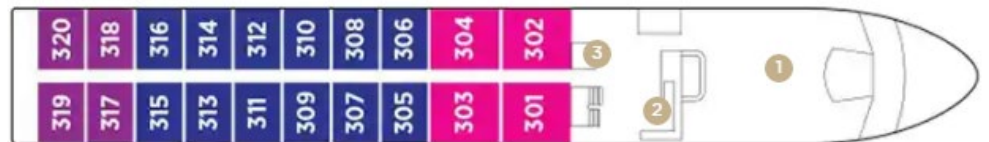

**Lisbon Deck**



**Douro Deck**



Stateroom Categories



Fares listed are cruise-only, per person based on double occupancy inclusive of port charges of \$231 per person.