

SAVOR A WINE CRUISE THROUGH FRANCE WITH SAMSARA WINE COMPANY

Aboard AmaKristina • 7 Nights • April 23 to 30, 2026
Lyon • Vienne • Tournon • Viviers • Avignon • Arles

Note: Stateroom layouts shown below are not to scale.

**Book by November 30, 2024
for this Special Pricing!**

Suite, Violin Deck
French Balcony & Outside Balcony, 350 sq. ft.

Brochure Rate = ~~\$9,247~~ pp
Wine Cruise Rate = \$8,797 pp



0 sq. ft.

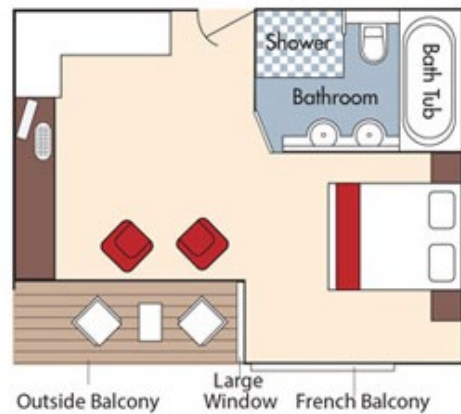

Category AA Violin Deck
French Balcony & Outside Balcony, 235 sq. ft.

Brochure Rate = ~~\$7,947~~ pp
Wine Cruise Rate = \$7,547 pp

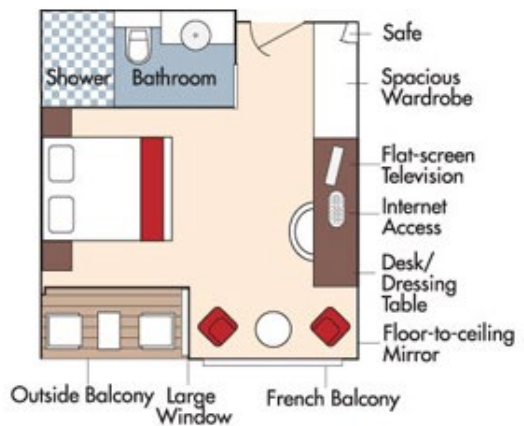



Category AB *Cello Deck*

French Balcony & Outside Balcony, 235 sq. ft.

Brochure Rate = ~~\$7,747~~ pp

Wine Cruise Rate = \$7,347 pp

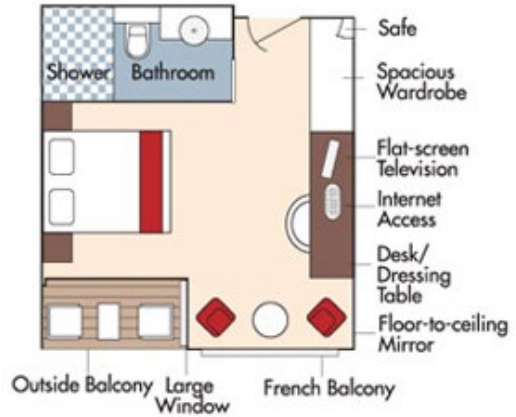

Category BA *Violin Deck*

French Balcony & Outside Balcony, 210 sq. ft.

Brochure Rate = ~~\$7,547~~ pp

Wine Cruise Rate = \$7,147 pp

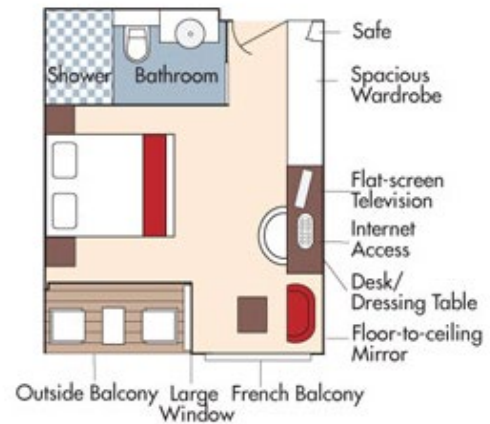



CAT. BB, Cello Deck

Category BB *Cello Deck*

French Balcony & Outside Balcony, 210 sq. ft.

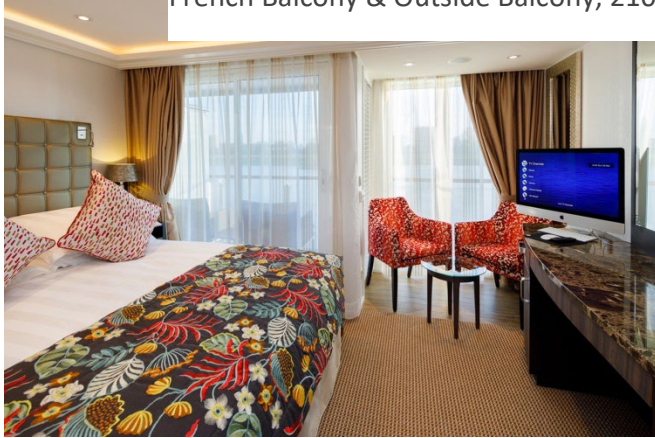

Brochure Rate = ~~\$7,347 pp~~
Wine Cruise Rate \$6,947 pp

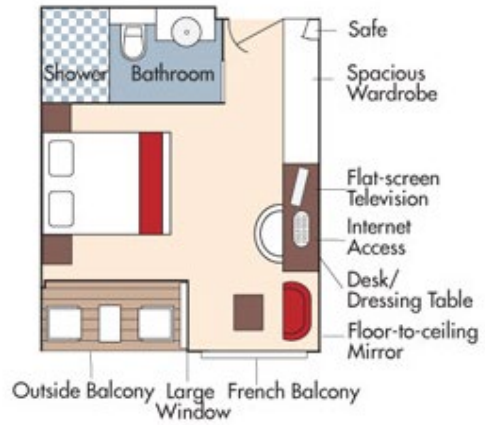

Category CA *Violin & Cello Deck*

French Balcony, 170 sq. ft.



Brochure Rate = ~~\$6,747 pp~~
Wine Cruise Rate = \$6,447 pp

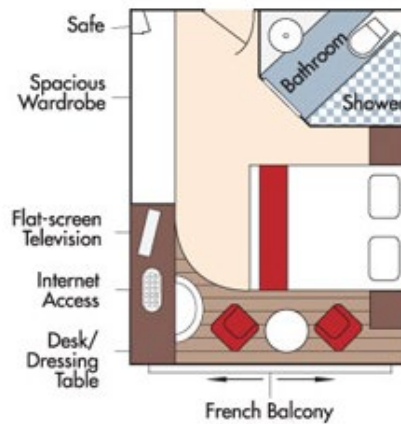

Category CB *Violin Deck*

French Balcony, 155 sq. ft.



Brochure Rate = ~~\$6,347 pp~~
Wine Cruise Rate = \$6,047 pp

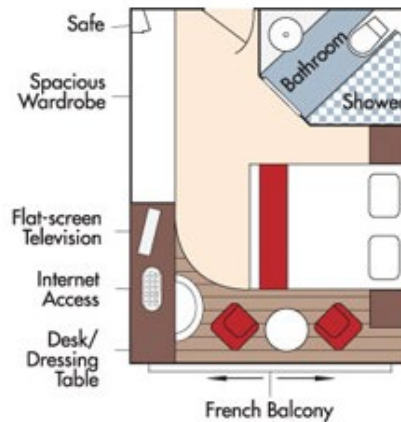

Category D *Piano Deck*
Fixed Windows, 160 sq. ft.



Brochure Rate = \$5,547 pp
Wine Cruise Rate = \$5,297 pp

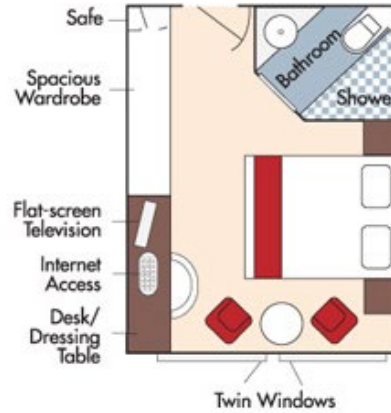

Category E *Piano Deck*
Fixed Windows, 160 sq. ft.

Brochure Rate = \$5,248 pp
Wine Cruise Rate = \$4,998 pp

AmaKristina DECK PLAN

| | |
|----|-----------------------------|
| 1 | Lower Sun Deck |
| 2 | Navigation Bridge |
| 3 | Bicycles |
| 4 | Heated Pool |
| 5 | Sun Deck |
| 6 | Walking Track |
| 7 | Al Fresco Terrace |
| 8 | Observation Lounge |
| 9 | Main Lounge & Bar |
| 10 | Gift Shop |
| 11 | Reception |
| 12 | The Chef's Table Restaurant |
| 13 | Main Restaurant |
| 14 | Elevator |
| 15 | Massage & Hair Salon |
| 16 | Fitness Room |
| 17 | Crew Cabins |

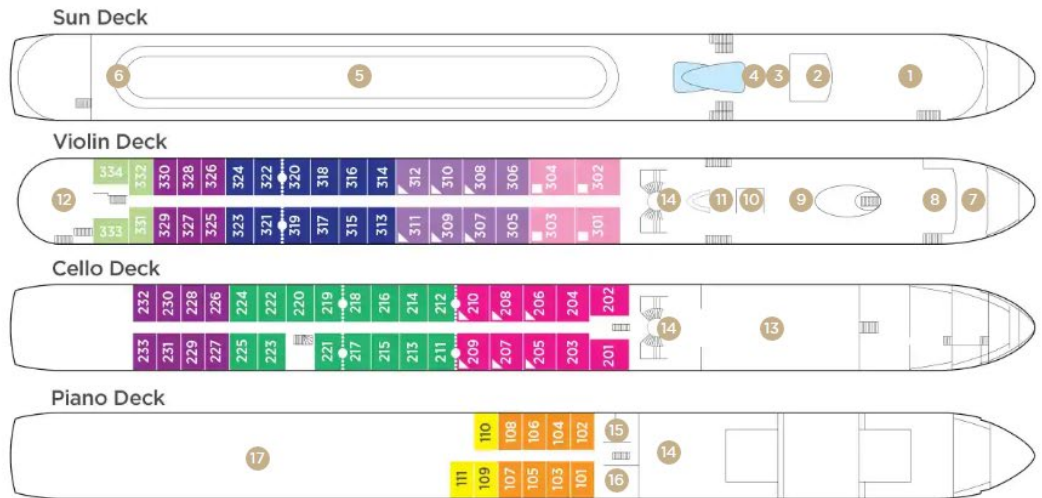

Note: Elevator reaches the Violin, Cello and Piano Deck (does not reach the Sun Deck).

Staterooms can become adjoining by request.

Up to triple occupancy

Stateroom Categories



Fares listed are cruise-only, per person based on double occupancy and INCLUDE port charges of \$250 per person and include the exclusive wine package.