

EXPLORE THE ENTICING DOURO WITH TORR NA LOCHS VINEYARD & WINERY

Aboard AmaSintra • 7 Nights • November 6 to 13, 2026

Special Rates when you book by
September 30, 2024

Note: Stateroom layouts shown below are not to scale.

Suite *Porto Deck* Balcony, 323 sq. ft.

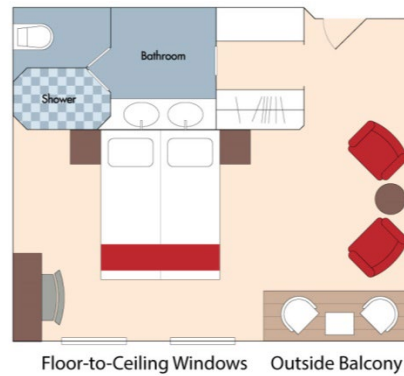

Brochure Fare: ~~\$8,847~~ pp
Your Rate: \$7,327 pp

Category A *Porto Deck* Balcony, 215 sq. ft.

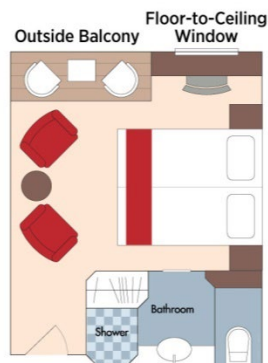

Brochure Fare: ~~\$7,347~~ pp
Your Rate: \$6,127 pp

Category B *Lisbon Deck* Balcony, 215 sq. ft.

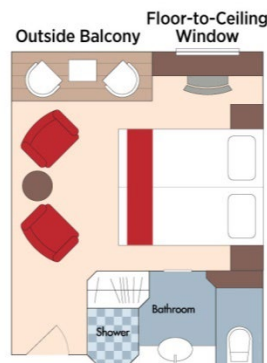

Brochure Fare: ~~\$7,047~~ pp
Your Rate: \$5,887 pp

Category C *Porto Deck* French Balcony, 161 sq. ft.

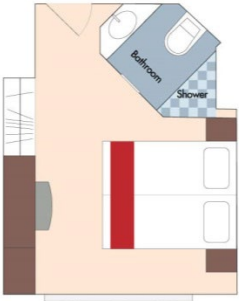

French Balcony

Brochure Fare: \$6,347 pp
Your Rate: \$5,327 pp

Category D *Douro Deck* Panoramic Window, 161 sq. ft.

Category E *Douro Deck* Panoramic Window, 161 sq. ft.



Category D
Brochure Fare: \$5,197 pp
Your Rate: \$4,407 pp

Category E
Brochure Fare: \$4,848 pp
Your Rate: \$4,128 pp

DECK PLAN

1	Main Lounge
2	Reception
3	Elevator
4	Main Restaurant
5	Fitness Room
6	Spa

Sun Deck



Porto Deck

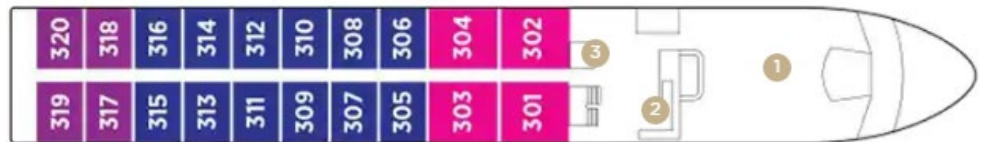

Lisbon Deck



Douro Deck



Stateroom Categories



Fares listed are cruise-only, per person based on double occupancy inclusive of port charges of \$250 per person.