

WINE CRUISE ON FRANCE'S SEINE RIVER

WITH THE AMERICAN WINE SOCIETY AND PAUL WAGNER

Aboard AmaLyra • 7 Nights • May 8 to 15, 2025

Paris • Les Andelys • Le Havre • Caudebec-en-Caux • Rouen • Vernon • Paris

**SAVE 5% OFF BALCONY
STATEROOMS WHEN BOOKED BY
SEPTEMBER 30, 2024!**

Note: Stateroom layouts shown below are not to scale.

Suite, Violin Deck
French Balcony, 255 sq. ft.



Brochure Rate: ~~\$8,314 pp~~

Wine Cruise Rate: \$7,929 pp

CAT. A+, Violin Deck
French Balcony, 225 sq. ft.

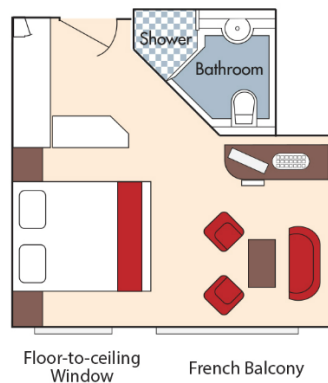

Brochure Rate: ~~\$7,999 pp~~

Wine Cruise Rate: \$7,629 pp

Fares listed are cruise-only, per person based on double occupancy inclusive of port charges of \$231 per person.

CAT. A, Violin Deck
French Balcony, 170 sq. ft.

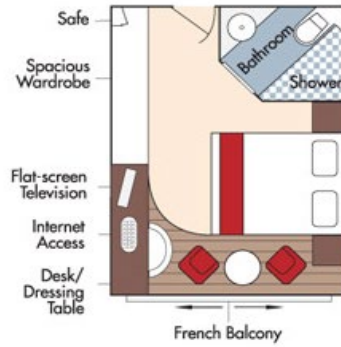

Brochure Rate: ~~\$6,949 pp~~

Wine Cruise Rate: \$6,629 pp

\$6,629 includes cruise rate of \$6,398 plus tax of \$231

CAT. B, Violin & Cello Deck
French Balcony, 170 sq. ft.

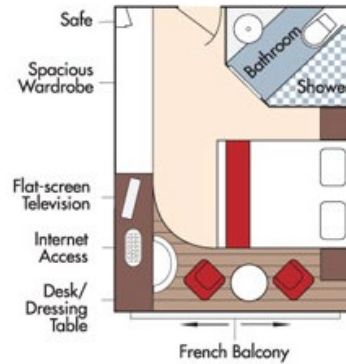

Brochure Rate: ~~\$6,844 pp~~

Wine Cruise Rate: \$6,529 pp

CAT. C, Violin & Cello Deck
French Balcony, 170 sq. ft.

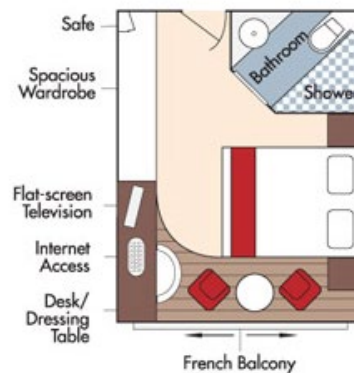

Brochure Rate: ~~\$6,529 pp~~

Wine Cruise Rate: \$6,229 pp

CAT. E, Piano Deck
Fixed Windows, 170 sq. ft.

CAT. D, Piano Deck
Fixed Windows, 170 sq. ft.

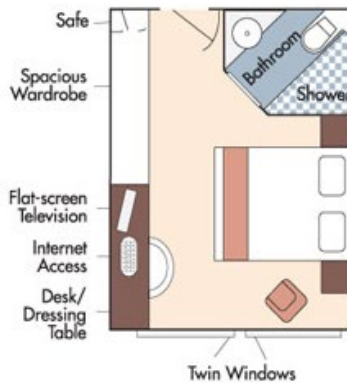

Category D
Wine Cruise Rate: \$5,129 pp

Category E
Wine Cruise Rate: \$4,830 pp

AmaLyra DECK PLAN

1	Observation Deck
2	Navigation Bridge
3	Bicycles
4	Whirlpool
5	Sun Deck
6	Walking Track
7	Bow Seating Area
8	Main Lounge & Bar
9	Gift Shop
10	Reception
11	Massage & Hair Salon
12	The Chef's Table Restaurant
13	Fitness Room
14	Main Restaurant
15	Elevator
16	Crew Cabins

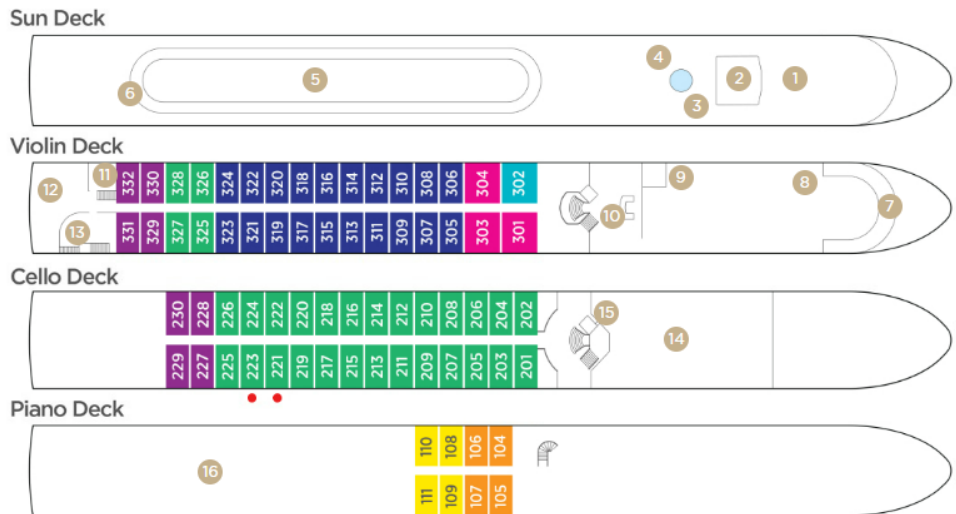

Note: Elevator reaches Main Restaurant, Lobby/Main Lounge and staterooms on Violin and Cello Deck (does not reach Piano Deck or Sun Deck).

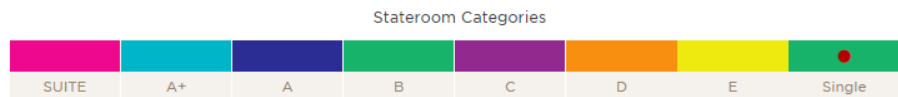

Fares listed are cruise-only, per person based on double occupancy inclusive of port charges of \$231 per person.