

# SAVOR THE FLAVORS OF BURGUNDY WITH THE PETALUMA GAP WINEGROWERS ALLIANCE

Aboard AmaCello • 7 Nights • June 12-19, 2025

Port of Dijon • Seurre • Beaune • Chalon-Sur-Saône • Tournus • Brancion • Mâcon • Lyon

**Book by June 30, 2024  
and SAVE 5%**

*Note: Stateroom layouts shown below are not to scale.*



**Suite, Violin Deck**  
French Balcony, 255 sq. ft.

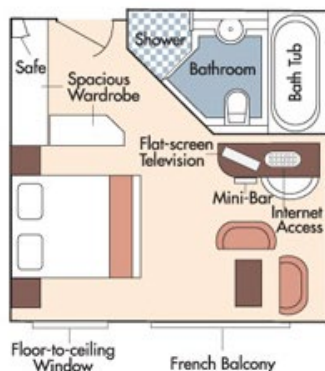

Brochure Fare: ~~\$8,103~~ pp  
Your Rate: **\$7,698 pp**



**CAT. A, Violin Deck**  
French Balcony, 170 sq. ft.

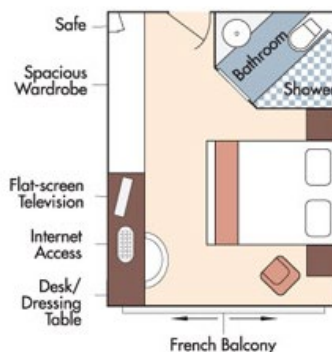

Brochure Fare: ~~\$6,735~~ pp  
Your Rate: **\$6,398 pp**



**CAT. B, Violin & Cello Deck**  
French Balcony, 170 sq. ft.

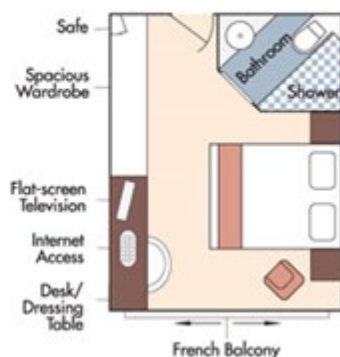

Brochure Fare: ~~\$6,629~~ pp  
Your Rate: **\$6,298 pp**



**CAT. C, Violin & Cello Deck**  
French Balcony, 170 sq. ft.

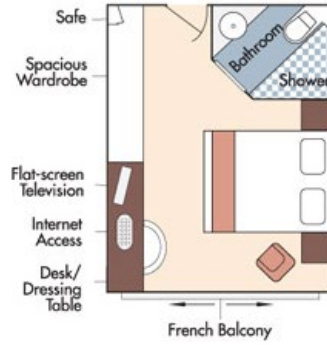

Brochure Fare: ~~\$6,314~~ pp

Your Rate: \$5,998 pp



**CAT. E, Piano Deck**  
Fixed Windows, 170 sq. ft.



**CAT. D, Piano Deck**  
Fixed Windows, 170 sq. ft.

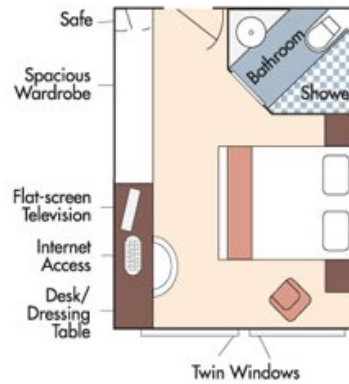

Category D

Brochure Fare: ~~\$5,156~~ pp

Your Rate: \$4,898 pp

Category E

Brochure Fare: ~~\$4,841~~ pp

Your Rate: \$4,599 pp

## AmaCello DECK PLAN

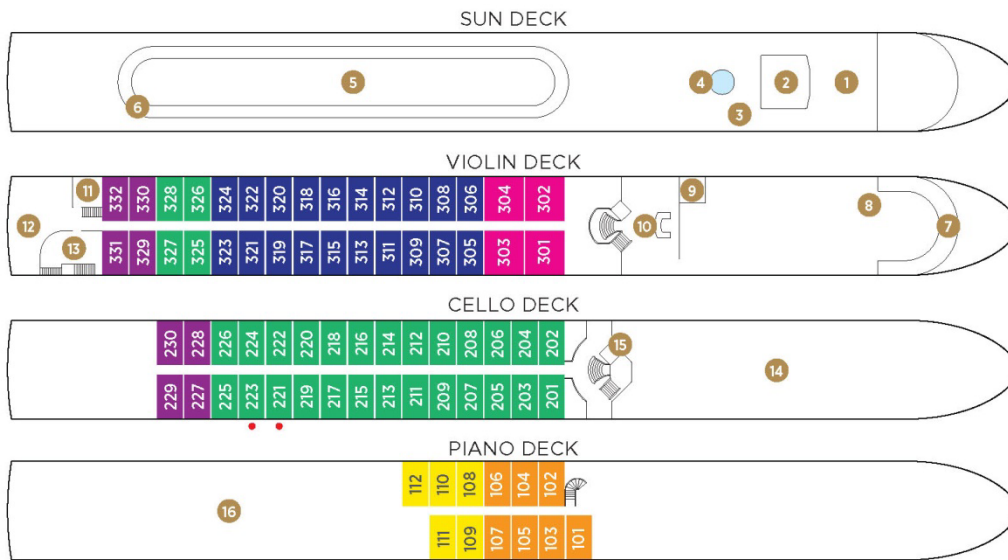

Elevator reaches Main Restaurant, Lobby/Main Lounge and staterooms on Violin and Cello Deck.

- 1 Observation Deck
- 2 Navigation Bridge
- 3 Bicycles
- 4 Whirlpool
- 5 Sun Deck
- 6 Walking Track
- 7 Bow Seating Area
- 8 Main Lounge & Bar
- 9 Gift Shop
- 10 Reception
- 11 Massage & Hair Salon
- 12 The Chef's Table Restaurant
- 13 Fitness Room
- 14 Main Restaurant
- 15 Elevator
- 16 Crew Cabins

<b>Suite</b>	Violin Deck / French Balcony - 255 sq. ft.	<b>Cat. D</b>	Piano Deck / Fixed Windows - 170 sq. ft.
<b>Cat. A</b>	Violin Deck / French Balcony - 170 sq. ft.	<b>Cat. E</b>	Piano Deck / Fixed Windows - 170 sq. ft.
<b>Cat. B</b>	Violin & Cello Deck / French Balcony - 170 sq. ft.	<b>Single</b>	Cello Deck / French Balcony - 140 sq. ft. <i>(Single staterooms only available on AmaCello)</i>
<b>Cat. C</b>	Violin & Cello Deck / French Balcony - 170 sq. ft.		