

SAVOR A WINE CRUISE THROUGH FRANCE

WITH MOLON LAVE, PHILIP CARTER, AND RAPPAHANNOCK CELLARS

Aboard AmaKristina • 7 Nights • June 19 to 26, 2025

Lyon • Vienne • Tournon • Viviers • Avignon • Arles

Note: Stateroom layouts shown below are not to scale.

**Book by June 30, 2024
for this Special Pricing**



Suite *Violin Deck*

French Balcony & Outside Balcony, 350 sq. ft. Wine Cruise rate = \$8,847 pp

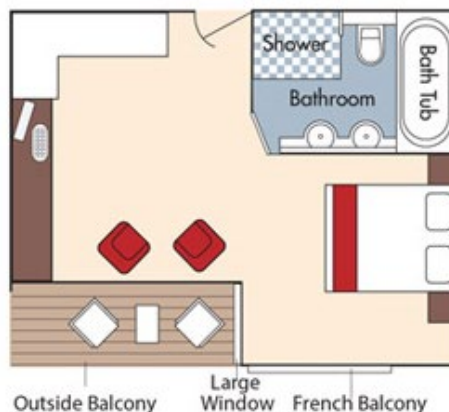

Category AA *Violin Deck*

French Balcony & Outside Balcony, 235 sq. ft. Wine Cruise rate = \$7,547 pp

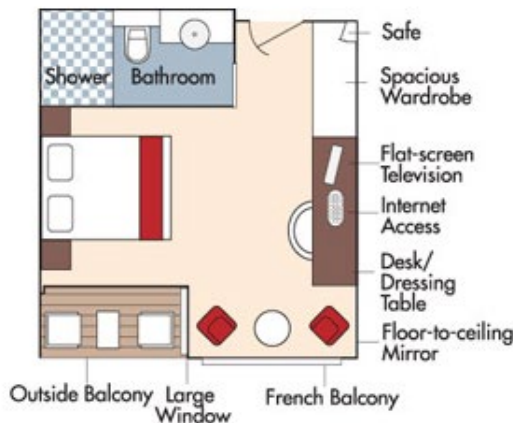

Fares listed are cruise-only, per person based on double occupancy and include the exclusive wine package. Port charges of \$231 per person are additional.



Category AB *Cello Deck*

French Balcony & Outside Balcony, 235 sq. ft. Wine Cruise rate = \$7,347 pp

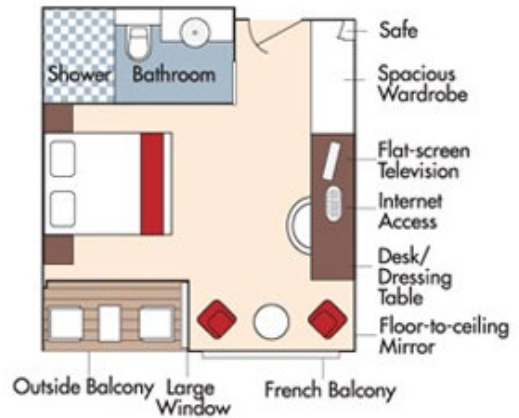

Category BA *Violin Deck*

French Balcony & Outside Balcony, 210 sq. ft. Wine Cruise rate = \$7,147 pp

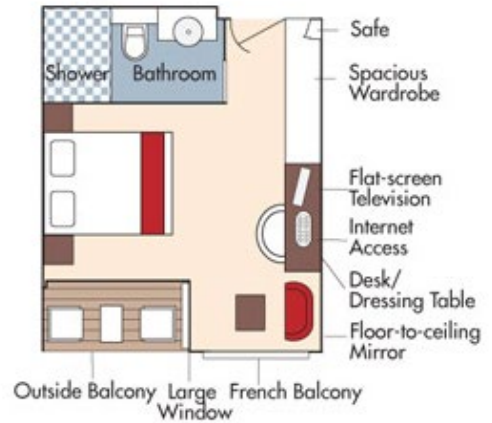

CAT. BB, Cello Deck

Category BB *Cello Deck*

French Balcony & Outside Balcony, 210 sq. ft.

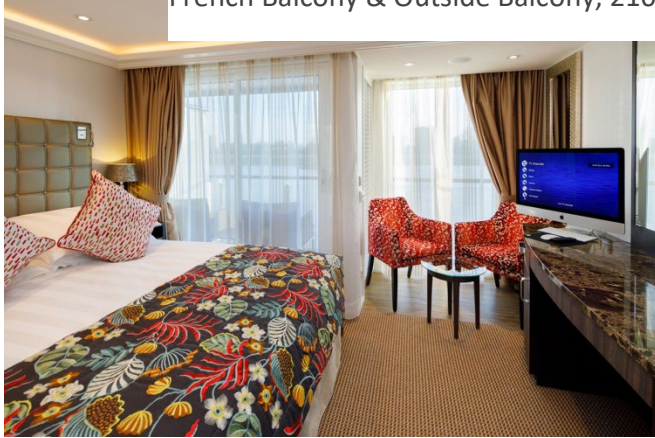

Wine Cruise rate \$6,947 pp

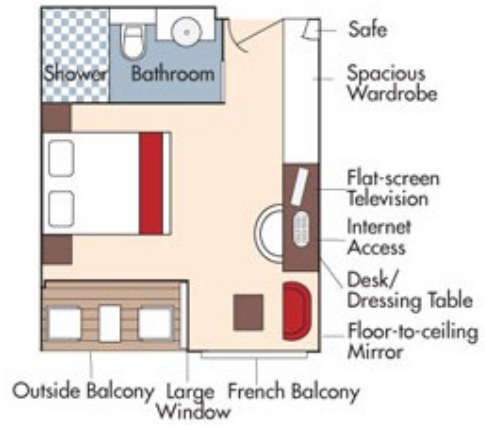

Category CA *Violin & Cello Deck*

French Balcony, 170 sq. ft.



Wine Cruise rate = \$6,347 pp

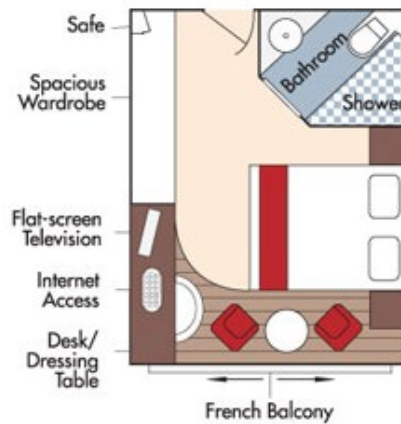

Category CB *Violin Deck*

French Balcony, 155 sq. ft.



Wine Cruise rate = \$5,947 pp

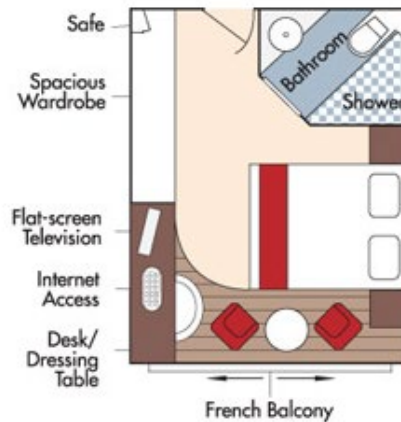

Category D *Piano Deck*
Fixed Windows, 160 sq. ft.

Wine Cruise rate = \$5,247 pp

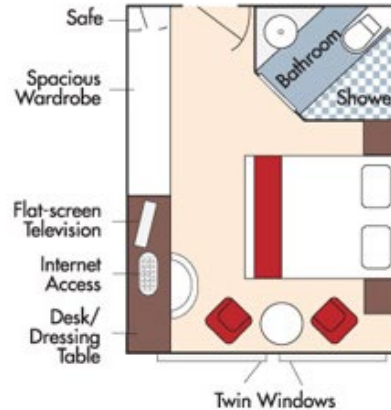

Category E *Piano Deck*
Fixed Windows, 160 sq. ft.

Wine Cruise rate = \$4,948 pp

AmaKristina
DECK PLAN

- 1 Lower Sun Deck
- 2 Navigation Bridge
- 3 Bicycles
- 4 Heated Pool
- 5 Sun Deck
- 6 Walking Track
- 7 Al Fresco Terrace
- 8 Observation Lounge
- 9 Main Lounge & Bar
- 10 Gift Shop
- 11 Reception
- 12 The Chef's Table Restaurant
- 13 Main Restaurant
- 14 Elevator
- 15 Massage & Hair Salon
- 16 Fitness Room
- 17 Crew Cabins

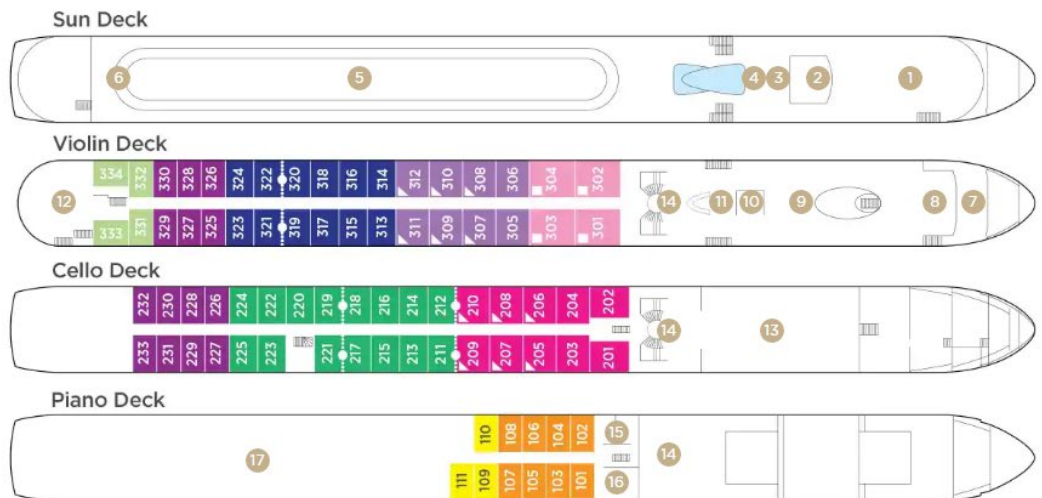

Note: Elevator reaches the Violin, Cello and Piano Deck (does not reach the Sun Deck).

Staterooms can become adjoining by request.

Up to triple occupancy

Stateroom Categories



Fares listed are cruise-only, per person based on double occupancy and include the exclusive wine package. Port charges of \$231 per person are additional.