



**Special Rates when you book
by June 30, 2024!**

RIVER CRUISE FOR WINE LOVERS

Steven Kent Winery & La Rochelle Winery

Aboard AmaCello • 7 Nights • April 17 to 24, 2025

Port of Dijon • Seurre • Beaune • Chalon-Sur-Saône • Brancion • Tournus • Mâcon • Lyon

Note: Stateroom layouts shown below are not to scale.

Suite, Violin Deck
French Balcony, 255 sq. ft.

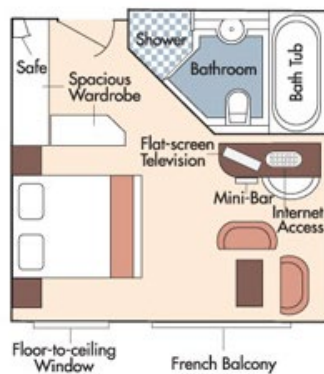

Brochure Fare: ~~\$7,498~~ pp
Your Rate: **\$6,748** pp

CAT. A, Violin Deck
French Balcony, 170 sq. ft.



Brochure Fare: ~~\$6,198~~ pp
Your Rate: **\$5,448** pp

CAT. B, Violin & Cello Deck
French Balcony, 170 sq. ft.

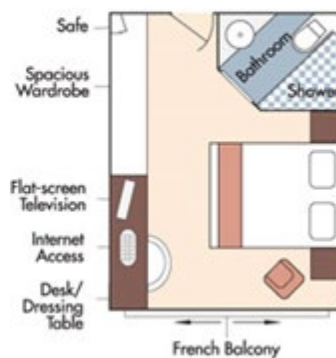

Brochure Fare: ~~\$6,098~~ pp
Your Rate: **\$5,348** pp



CAT. C, Violin & Cello Deck
French Balcony, 170 sq. ft.

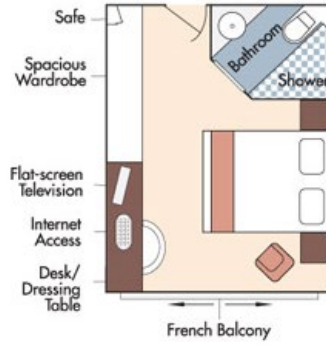

Brochure Fare: ~~\$5,798~~ pp

Your Rate: \$5,048 pp



CAT. E, Piano Deck
Fixed Windows, 170 sq. ft.



CAT. D, Piano Deck
Fixed Windows, 170 sq. ft.

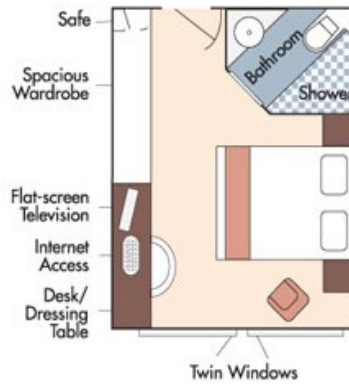

Category D

Brochure Fare: ~~\$4,698~~ pp

Your Rate: \$3,948 pp

Category E

Brochure Fare: ~~\$4,399~~ pp

Your Rate: \$3,649 pp

AmaCello DECK PLAN

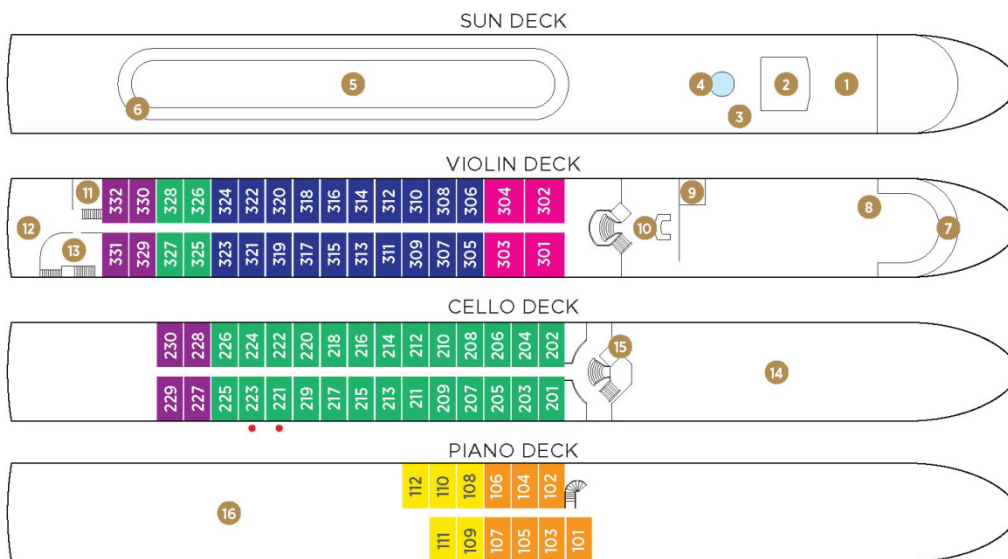

Elevator reaches Main Restaurant, Lobby/Main Lounge and staterooms on Violin and Cello Deck.

- 1 Observation Deck
- 2 Navigation Bridge
- 3 Bicycles
- 4 Whirlpool
- 5 Sun Deck
- 6 Walking Track
- 7 Bow Seating Area
- 8 Main Lounge & Bar
- 9 Gift Shop
- 10 Reception
- 11 Massage & Hair Salon
- 12 The Chef's Table Restaurant
- 13 Fitness Room
- 14 Main Restaurant
- 15 Elevator
- 16 Crew Cabins

Suite	Violin Deck / French Balcony - 255 sq. ft.	Cat. D	Piano Deck / Fixed Windows - 170 sq. ft.
Cat. A	Violin Deck / French Balcony - 170 sq. ft.	Cat. E	Piano Deck / Fixed Windows - 170 sq. ft.
Cat. B	Violin & Cello Deck / French Balcony - 170 sq. ft.	Single	Cello Deck / French Balcony - 140 sq. ft. <i>(Single staterooms only available on AmaCello)</i>
Cat. C	Violin & Cello Deck / French Balcony - 170 sq. ft.		