



**Special Rates when you book
by June 30, 2024!**

RIVER CRUISE FOR WINE LOVERS

Mill Creek Vineyards & Winery

Aboard AmaKristina • 7 Nights • July 31 to August 7, 2025
Lyon to Arles

Note: Stateroom layouts shown below are not to scale.



Suite *Violin Deck*

French Balcony & Outside Balcony, 350 sq. ft.

Brochure Fare \$8,498 pp

Wine cruise rate \$7,748 pp

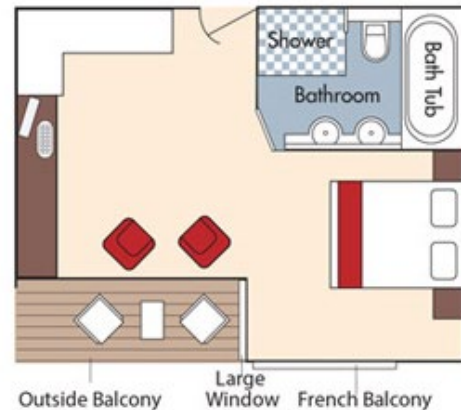

Category AA *Violin Deck*

French Balcony & Outside Balcony, 235 sq. ft.

Brochure Fare \$7,198 pp

Wine cruise rate \$6,448 pp

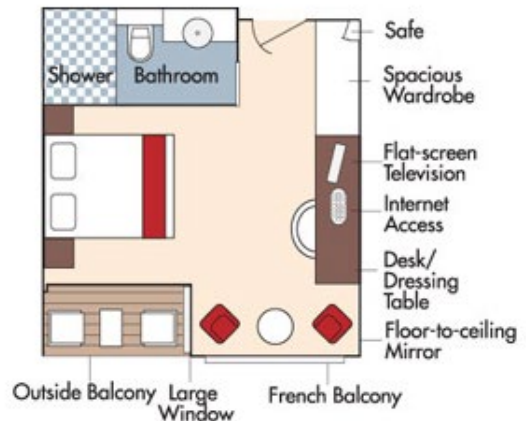

Fares listed are cruise-only, per person based on double occupancy and include the exclusive wine package. Port charges of \$231 per person are additional.

Category AB *Cello Deck*
 French Balcony & Outside Balcony, 235 sq. ft.

Brochure Fare \$6,998 pp
 Wine cruise rate \$6,248 pp

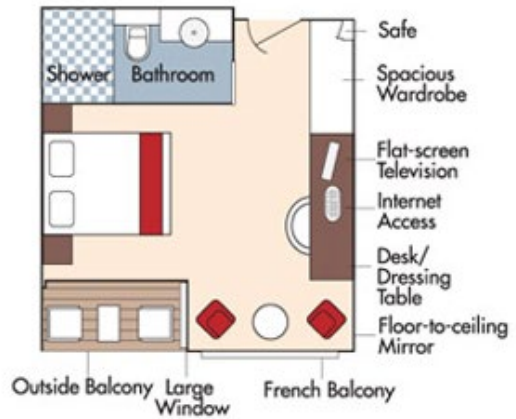

Category BA *Violin Deck*
 French Balcony & Outside Balcony, 210 sq. ft.

Brochure Fare \$6,798 pp
 Wine cruise rate \$6,048 pp

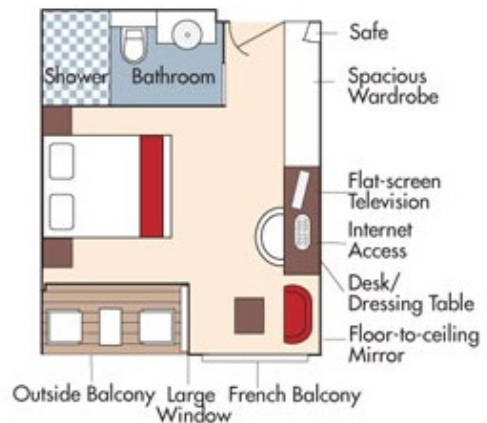



CAT. BB, Cello Deck

Category BB *Cello Deck*

French Balcony & Outside Balcony, 210 sq. ft.

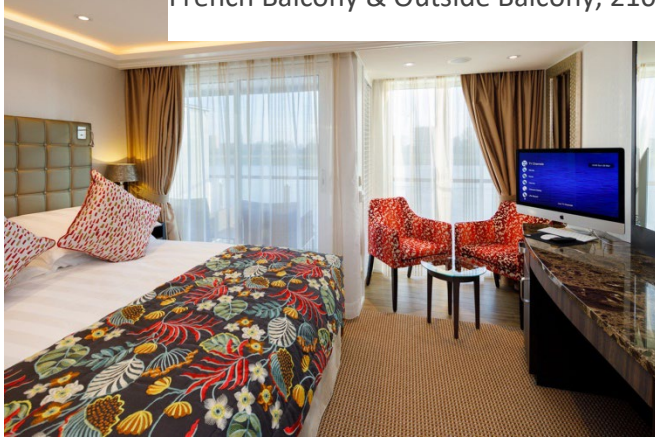

Brochure Fare ~~\$6,598~~ pp
Wine cruise rate \$5,848 pp

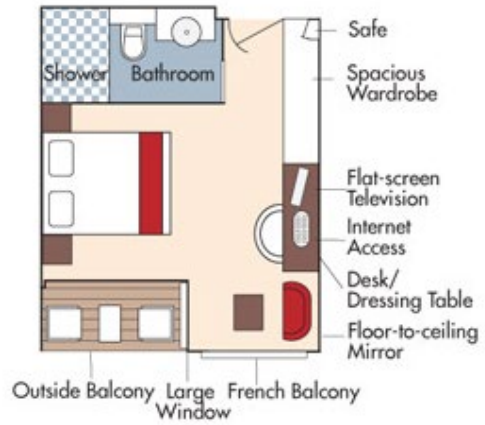

Category CA *Violin & Cello Deck*

French Balcony, 170 sq. ft.



Category CA
Brochure Fare ~~\$5,998~~ pp
Wine cruise rate \$5,248 pp

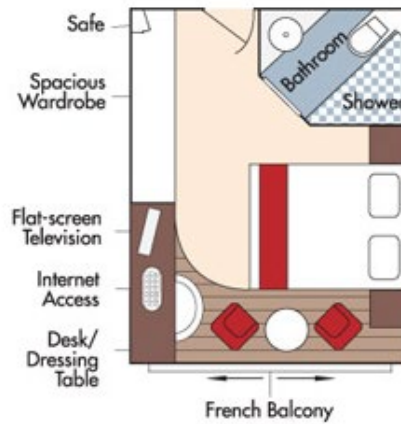

Category CB *Violin Deck*

French Balcony, 155 sq. ft.



Category CB
Brochure Fare ~~\$5,598~~ pp
Wine cruise rate \$4,848 pp

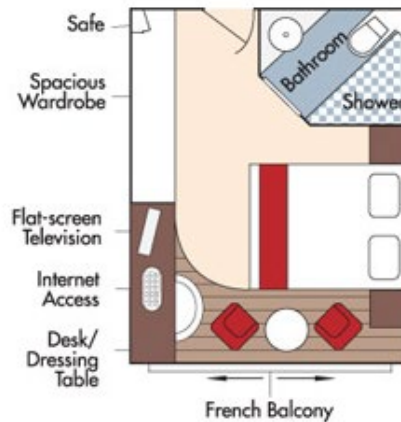

Category D *Piano Deck*
Fixed Windows, 160 sq. ft.



Brochure Fare \$4,898 pp
Wine cruise rate \$4,148 pp

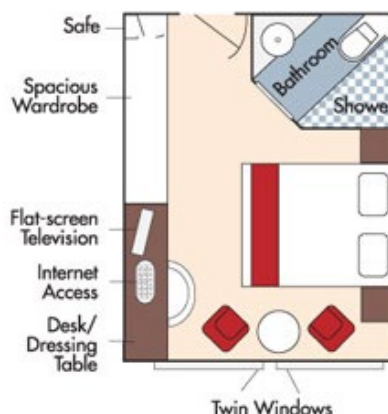

Category E *Piano Deck*
Fixed Windows, 160 sq. ft.

Brochure Fare \$4,599 pp
Wine cruise rate \$3,849 pp

AmaKristina
DECK PLAN

- 1 Lower Sun Deck
- 2 Navigation Bridge
- 3 Bicycles
- 4 Heated Pool
- 5 Sun Deck
- 6 Walking Track
- 7 Al Fresco Terrace
- 8 Observation Lounge
- 9 Main Lounge & Bar
- 10 Gift Shop
- 11 Reception
- 12 The Chef's Table Restaurant
- 13 Main Restaurant
- 14 Elevator
- 15 Massage & Hair Salon
- 16 Fitness Room
- 17 Crew Cabins

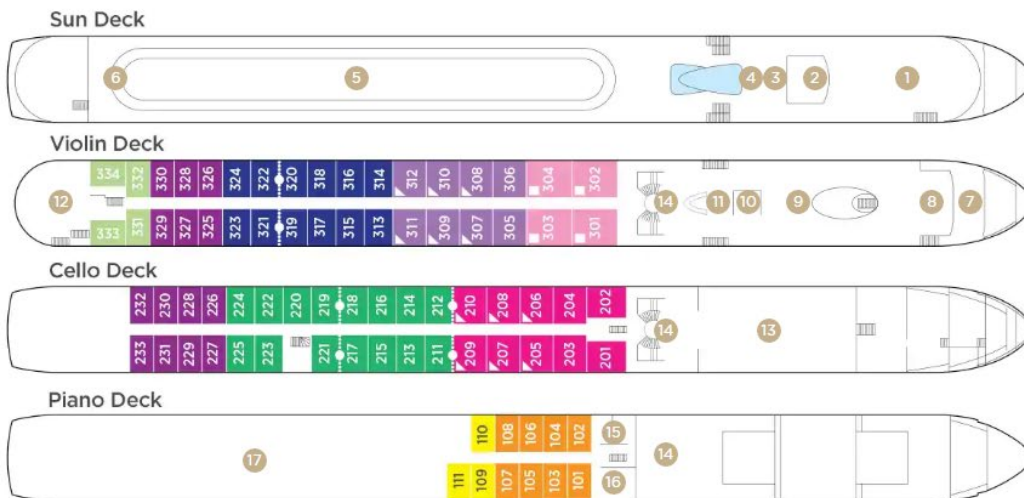

Note: Elevator reaches the Violin, Cello and Piano Deck (does not reach the Sun Deck).

Staterooms can become adjoining by request.

Up to triple occupancy

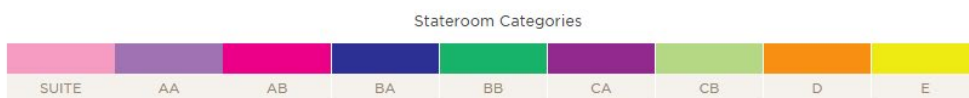

Fares listed are cruise-only, per person based on double occupancy and include the exclusive wine package. Port charges of \$231 per person are additional.