

GRAND EUROPE WINE CRUISE

WITH PAUL WAGNER AND TIM GAISER

Aboard AmaMora • 14 Nights • May 17 – 31, 2025

Amsterdam to Budapest

**SAVE 10% OFF BALCONY
STATEROOMS WHEN BOOKED
BY MAY 15, 2024!**

*Note: Stateroom layouts shown below
are not to scale.*



Suite *Violin Deck*

French Balcony & Outside Balcony, 350 sq. ft.

Brochure Rate: ~~\$15,887 pp~~

Wine Cruise Rate: **\$14,298 pp**

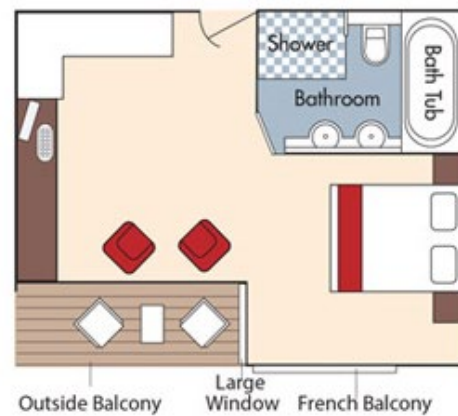
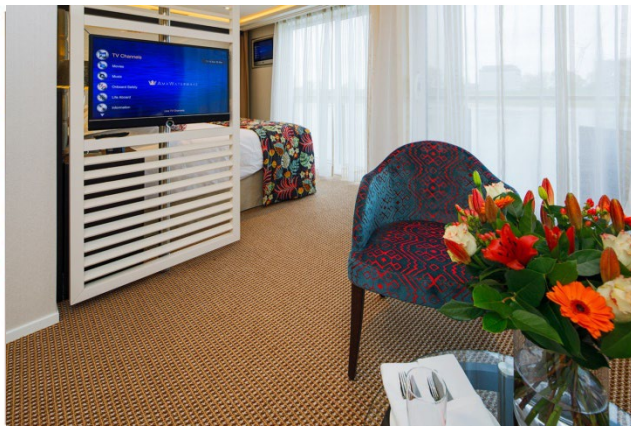

Category AA *Violin Deck*

French Balcony & Outside Balcony, 235 sq. ft.

Brochure Rate: ~~\$13,220 pp~~

Wine Cruise Rate: **\$11,898 pp**

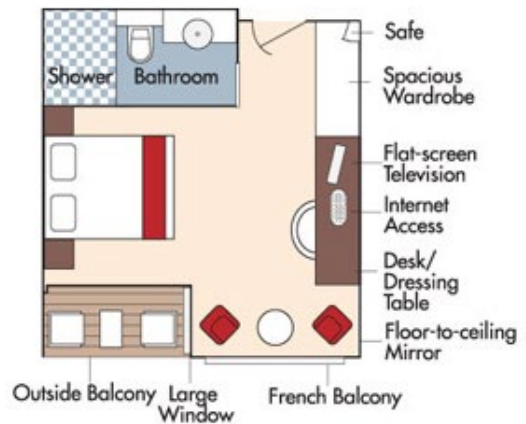

Fares listed are cruise-only, per person based on double occupancy and include the exclusive wine package. Port charges of \$462 per person are additional.



Category AB *Cello Deck*

French Balcony & Outside Balcony, 235 sq. ft.

Brochure Rate: ~~\$12,887 pp~~

Wine Cruise Rate: \$11,598 pp

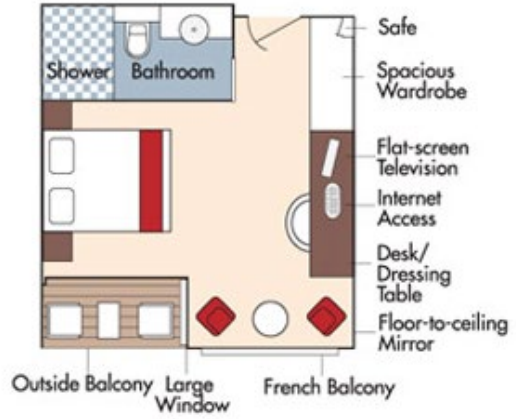

Category BA *Violin Deck*

French Balcony & Outside Balcony, 210 sq. ft.

Brochure Rate: ~~\$12,553 pp~~

Wine Cruise Rate: \$11,298 pp

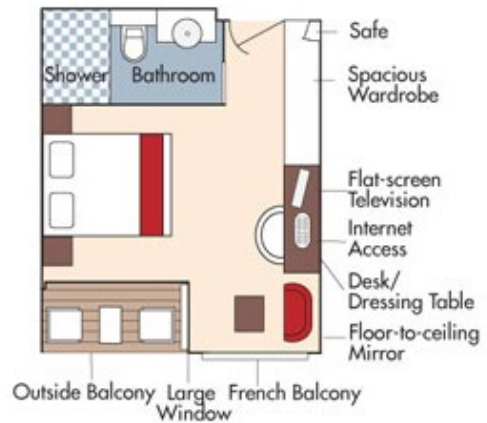

Category BB *Cello Deck*

French Balcony & Outside Balcony, 210 sq. ft.



Brochure Rate: ~~\$12,109~~ pp

Wine Cruise Rate: \$10,898 pp

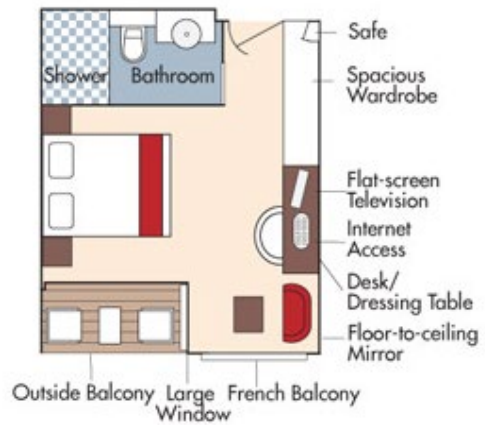

Category CA *Violin & Cello Deck*

French Balcony, 170 sq. ft.



Category CA

Brochure Rate: ~~\$10,887~~ pp

Wine Cruise Rate: \$9,798 pp

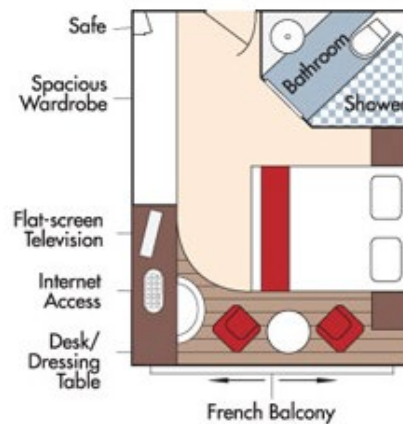

Category CB *Violin Deck*

French Balcony, 155 sq. ft.



Category CB

Brochure Rate: ~~\$10,109~~ pp

Wine Cruise Rate: \$9,098 pp

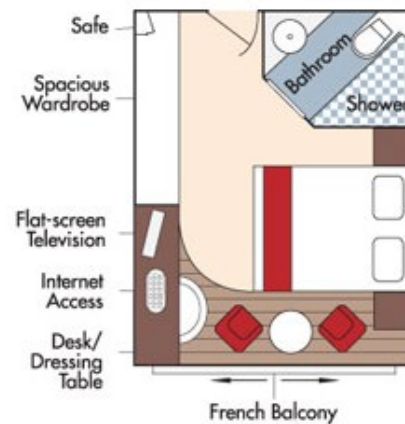

Category D *Piano Deck*
Fixed Windows, 160 sq. ft.

Wine Cruise Rate: \$7,798 pp

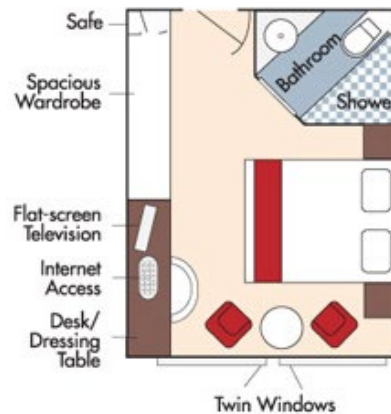

Category E *Piano Deck*
Fixed Windows, 160 sq. ft.

Wine Cruise Rate: \$7,299 pp

AmaMora
DECK PLAN

- 1 Lower Sun Deck
- 2 Navigation Bridge
- 3 Bicycles
- 4 Heated Pool
- 5 Sun Deck
- 6 Walking Track
- 7 Al Fresco Terrace
- 8 Observation Lounge
- 9 Main Lounge & Bar
- 10 Gift Shop
- 11 Reception
- 12 The Chef's Table Restaurant
- 13 Main Restaurant
- 14 Elevator
- 15 Massage & Hair Salon
- 16 Fitness Room
- 17 Crew Cabins

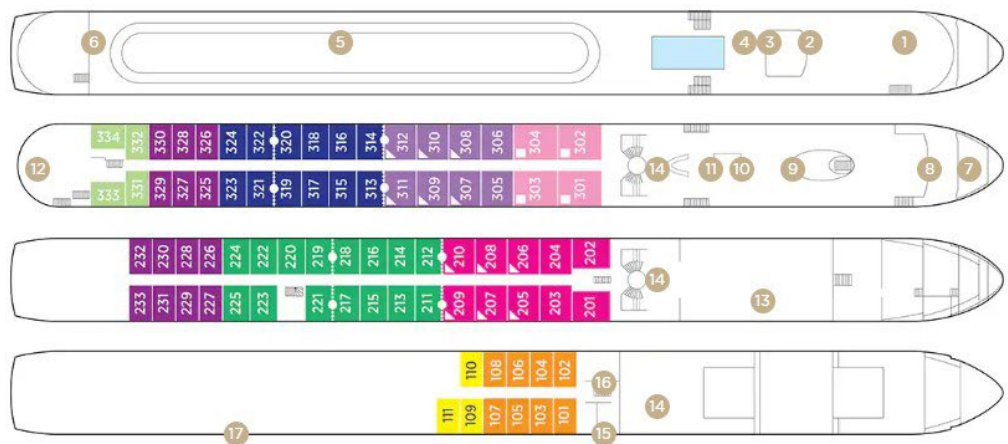

Note: Elevator reaches the Violin, Cello and Piano Deck (does not reach the Sun Deck).

Staterooms can become adjoining by request.

Up to triple occupancy

Stateroom Categories

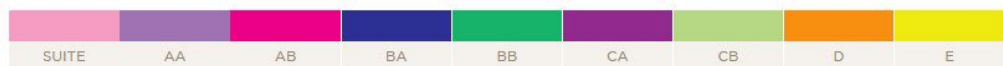

Fares listed are cruise-only, per person based on double occupancy and include the exclusive wine package. Port charges of \$462 per person are additional.