

# BOURBON & WINE CRUISE THROUGH BORDEAUX WITH SCOTT HARPER, MS

## AmaDolce • October 2 – 9, 2025

Bordeaux • Libourne • Blaye • Bourg • Cussac-Fort-Medoc • Cadillac • Bordeaux

**Special Rates when you book  
by June 30, 2024**

**Suite, Violin Deck**  
French Balcony, 255 sq. ft.

*Note: Stateroom layouts shown below are not to scale.*



**Wine Cruise Rate: \$8,197 pp**

**CAT. A+, Violin Deck**  
French Balcony, 225 sq. ft.

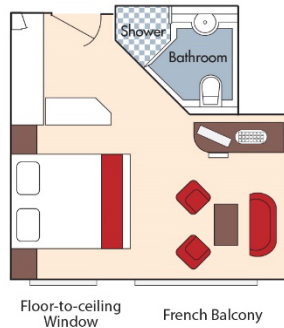

**Wine Cruise Rate: \$7,897 pp**

**CAT. A, Violin Deck**  
French Balcony, 170 sq. ft.

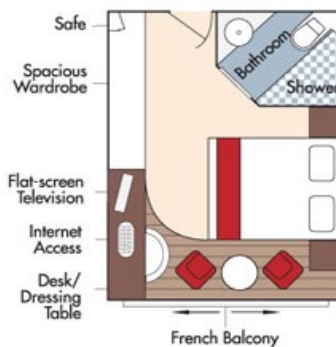

**Wine Cruise Rate: \$6,897 pp**

**CAT. B, Violin & Cello Deck**  
French Balcony, 170 sq. ft.

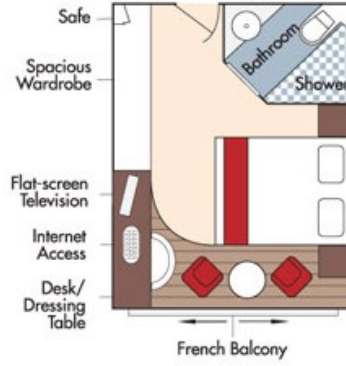

**Wine Cruise Rate: \$6,797 pp**

**CAT. C, Violin & Cello Deck**  
French Balcony, 170 sq. ft.

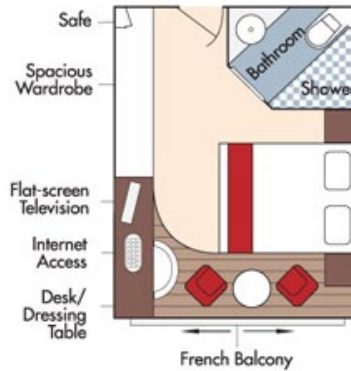

**Wine Cruise Rate: \$6,497 pp**

**CAT. E, Piano Deck**  
Fixed Windows, 170 sq. ft.

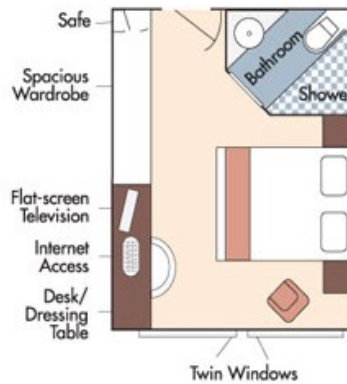

**Category D**  
**Wine Cruise Rate: \$5,397 pp**

**Category E**  
**Wine Cruise Rate: \$5,098 pp**

## AmaDolce Deck Plan

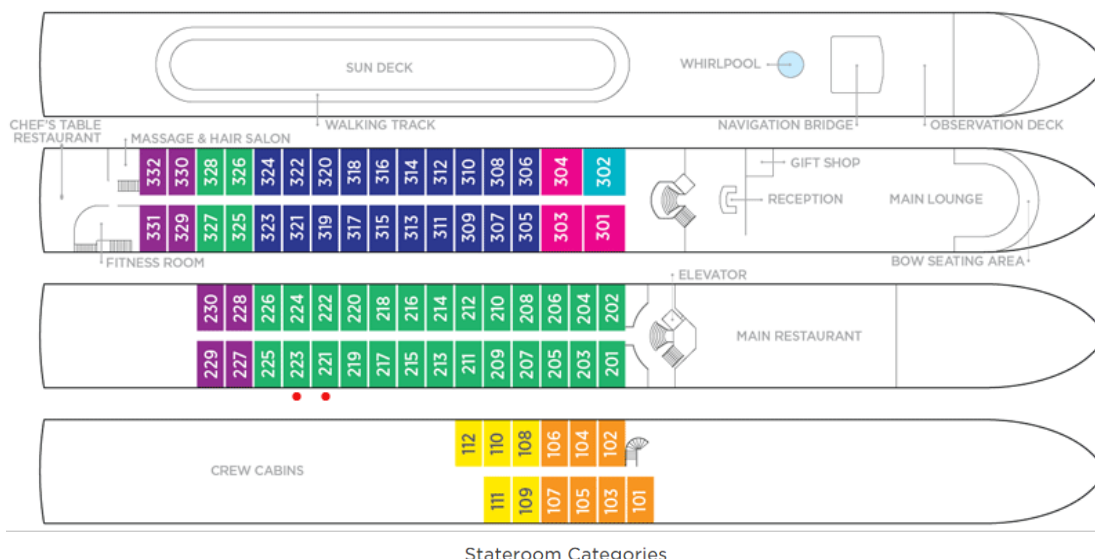

Fares listed are cruise-only, per person based on double occupancy and do not include port charges of \$231 per person.