

# CRUISE THE VINEYARDS OF SOUTHERN FRANCE WITH ALPHA OMEGA WINERY

**Book by June 30, 2024  
and SAVE  
\$250 per person!**

**7 Nights • May 15 to 22, 2025  
Arles to Lyon – Aboard AmaKristina**

*Note: Stateroom layouts shown below are not to scale.*



## Suite *Violin Deck*

French Balcony & Outside Balcony, 350 sq. ft.

Brochure Rate ~~\$9,147~~ pp

Wine cruise rate **\$8,897** pp

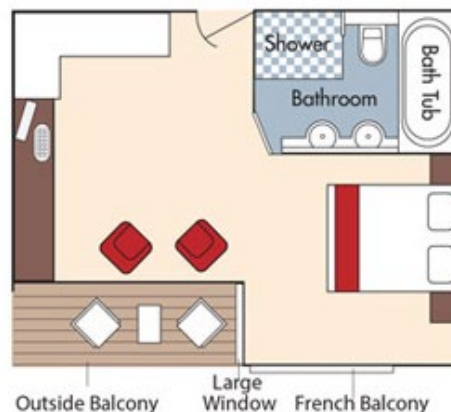

## Category AA *Violin Deck*

French Balcony & Outside Balcony, 235 sq. ft.

Brochure Rate ~~\$7,847~~ pp

Wine cruise rate **\$7,597** pp

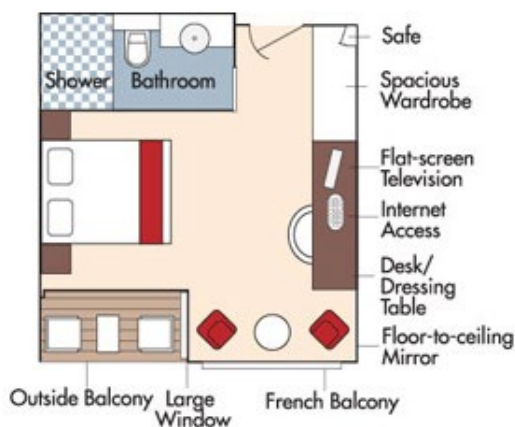

*Fares listed are cruise-only, per person based on double occupancy and include the exclusive wine package. Port charges of \$231 per person are additional.*



### Category AB *Cello Deck*

French Balcony & Outside Balcony, 235 sq. ft.

Brochure Rate ~~\$7,647~~ pp

Wine cruise rate \$7,397 pp

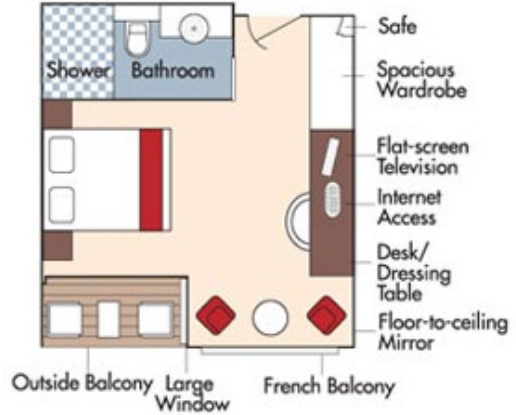

### Category BA *Violin Deck*

French Balcony & Outside Balcony, 210 sq. ft.

Brochure Rate ~~\$7,447~~ pp

Wine cruise rate \$7,197 pp

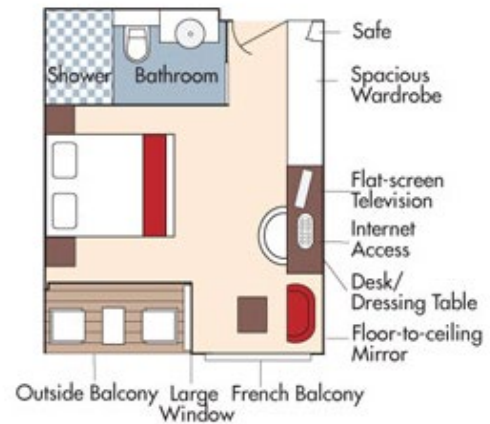

CAT. BB, Cello Deck

### Category BB *Cello Deck*

French Balcony & Outside Balcony, 210 sq. ft.

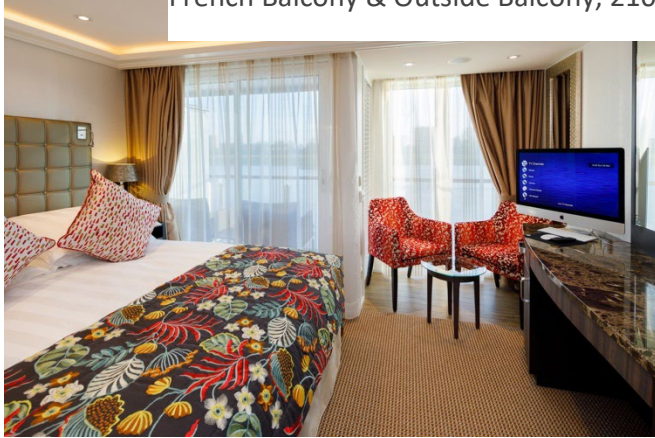

Brochure Rate ~~\$7,247~~ pp  
Wine cruise rate \$6,997 pp

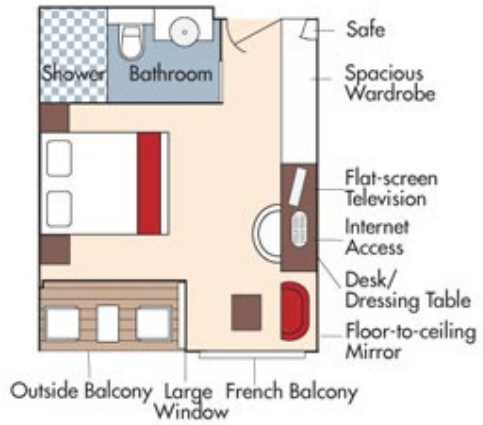

### Category CA *Violin & Cello Deck*

French Balcony, 170 sq. ft.



Category CA  
Brochure Rate ~~\$6,647~~ pp  
Wine cruise rate \$6,397 pp

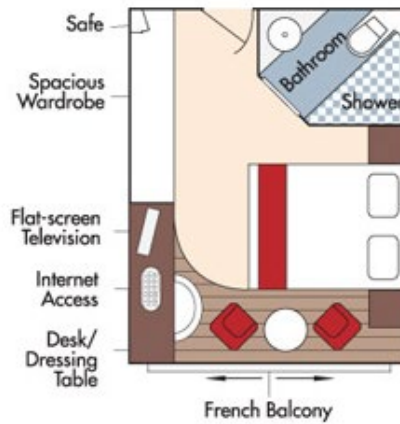

### Category CB *Violin Deck*

French Balcony, 155 sq. ft.



Category CB  
Brochure Rate ~~\$6,247~~ pp  
Wine cruise rate \$5,997 pp

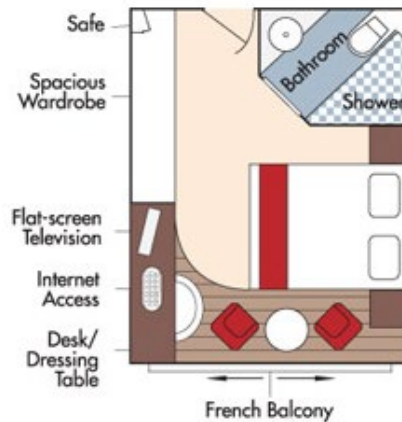

Fares listed are cruise-only, per person based on double occupancy and include the exclusive wine package. Port charges of \$231 per person are additional.

**Category D** *Piano Deck*  
Fixed Windows, 160 sq. ft.



Brochure Rate ~~\$5,547~~ pp  
Wine cruise rate \$5,297 pp

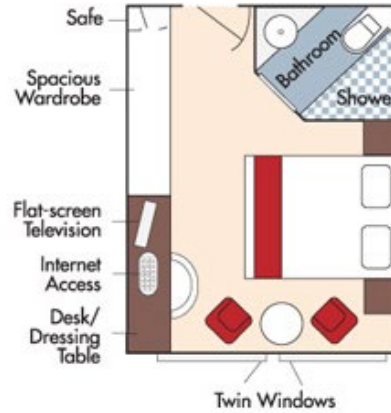

**Category E** *Piano Deck*  
Fixed Windows, 160 sq. ft.

Brochure Rate ~~\$5,248~~ pp  
Wine cruise rate \$4,998 pp

## AmaKristina DECK PLAN

1	Lower Sun Deck
2	Navigation Bridge
3	Bicycles
4	Heated Pool
5	Sun Deck
6	Walking Track
7	Al Fresco Terrace
8	Observation Lounge
9	Main Lounge & Bar
10	Gift Shop
11	Reception
12	The Chef's Table Restaurant
13	Main Restaurant
14	Elevator
15	Massage & Hair Salon
16	Fitness Room
17	Crew Cabins

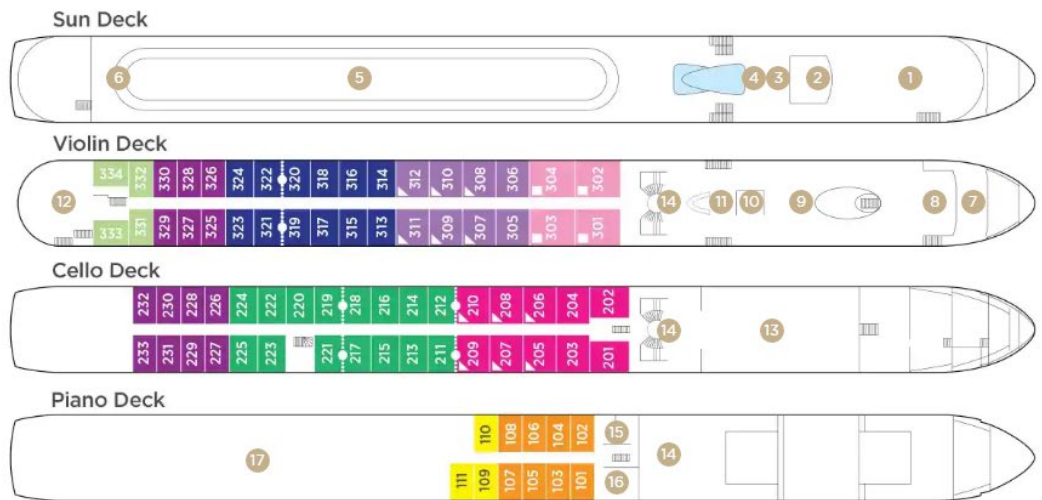

Note: Elevator reaches the Violin, Cello and Piano Deck (does not reach the Sun Deck).

Staterooms can become adjoining by request.

Up to triple occupancy

Stateroom Categories



Fares listed are cruise-only, per person based on double occupancy and include the exclusive wine package. Port charges of \$231 per person are additional.