

WINE CRUISE ON FRANCE'S SEINE RIVER

WITH THE AMERICAN WINE SOCIETY AND PAUL WAGNER

Aboard AmaLyra • 7 Nights • May 8 to 15, 2025

Paris • Les Andelys • Le Havre • Caudebec-en-Caux • Rouen • Vernon • Paris

**SAVE 5% OFF BALCONY
STATEROOMS WHEN BOOKED BY
JUNE 30, 2024!**

Note: Stateroom layouts shown below are not to scale.

Suite, Violin Deck
French Balcony, 255 sq. ft.



Brochure Rate: ~~\$8,083~~ pp

Wine Cruise Rate: \$7,698 pp

CAT. A+, Violin Deck
French Balcony, 225 sq. ft.

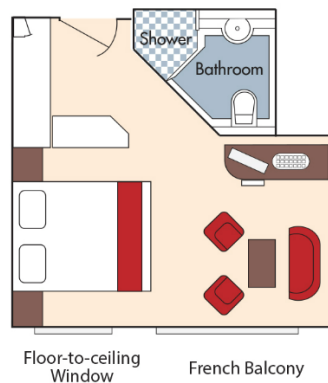

Brochure Rate: ~~\$7,768~~ pp

Wine Cruise Rate: \$7,398 pp

Fares listed are cruise-only, per person based on double occupancy and do not include port charges of \$231 per person.

CAT. A, Violin Deck
French Balcony, 170 sq. ft.

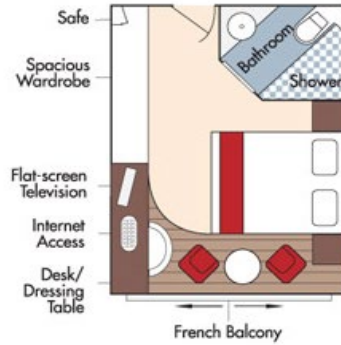

Brochure Rate: ~~\$6,718 pp~~
Wine Cruise Rate: \$6,398 pp

CAT. B, Violin & Cello Deck
French Balcony, 170 sq. ft.

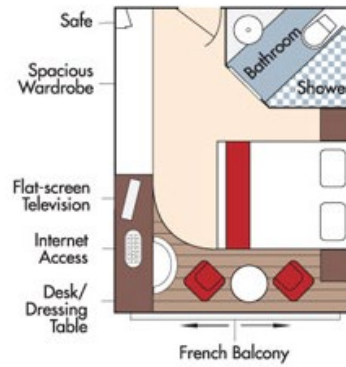

Brochure Rate: ~~\$6,613 pp~~
Wine Cruise Rate: \$6,298 pp

CAT. C, Violin & Cello Deck
French Balcony, 170 sq. ft.

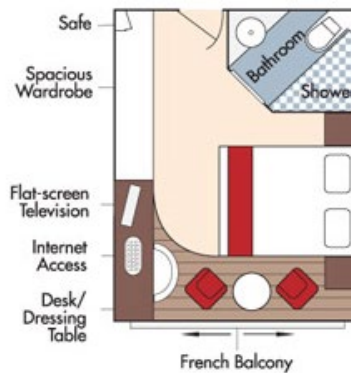

Brochure Rate: ~~\$6,298 pp~~
Wine Cruise Rate: \$5,998 pp



CAT. E, Piano Deck
Fixed Windows, 170 sq. ft.



CAT. D, Piano Deck
Fixed Windows, 170 sq. ft.

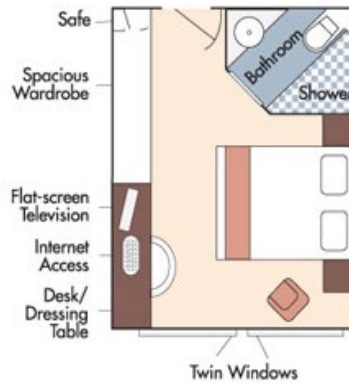

Category D
Wine Cruise Rate: \$4,898 pp

Category E
Wine Cruise Rate: \$4,599 pp

AmaLyra DECK PLAN

| | |
|----|-----------------------------|
| 1 | Observation Deck |
| 2 | Navigation Bridge |
| 3 | Bicycles |
| 4 | Whirlpool |
| 5 | Sun Deck |
| 6 | Walking Track |
| 7 | Bow Seating Area |
| 8 | Main Lounge & Bar |
| 9 | Gift Shop |
| 10 | Reception |
| 11 | Massage & Hair Salon |
| 12 | The Chef's Table Restaurant |
| 13 | Fitness Room |
| 14 | Main Restaurant |
| 15 | Elevator |
| 16 | Crew Cabins |

Sun Deck



Violin Deck



Cello Deck



Piano Deck



Note: Elevator reaches Main Restaurant, Lobby/Main Lounge and staterooms on Violin and Cello Deck (does not reach Piano Deck or Sun Deck).

Stateroom Categories



Fares listed are cruise-only, per person based on double occupancy and do not include port charges of \$231 per person.